

Project Title : OWNER DILIP KUMAR AGRAWAL ARPANA KUMARI AGRAWAL

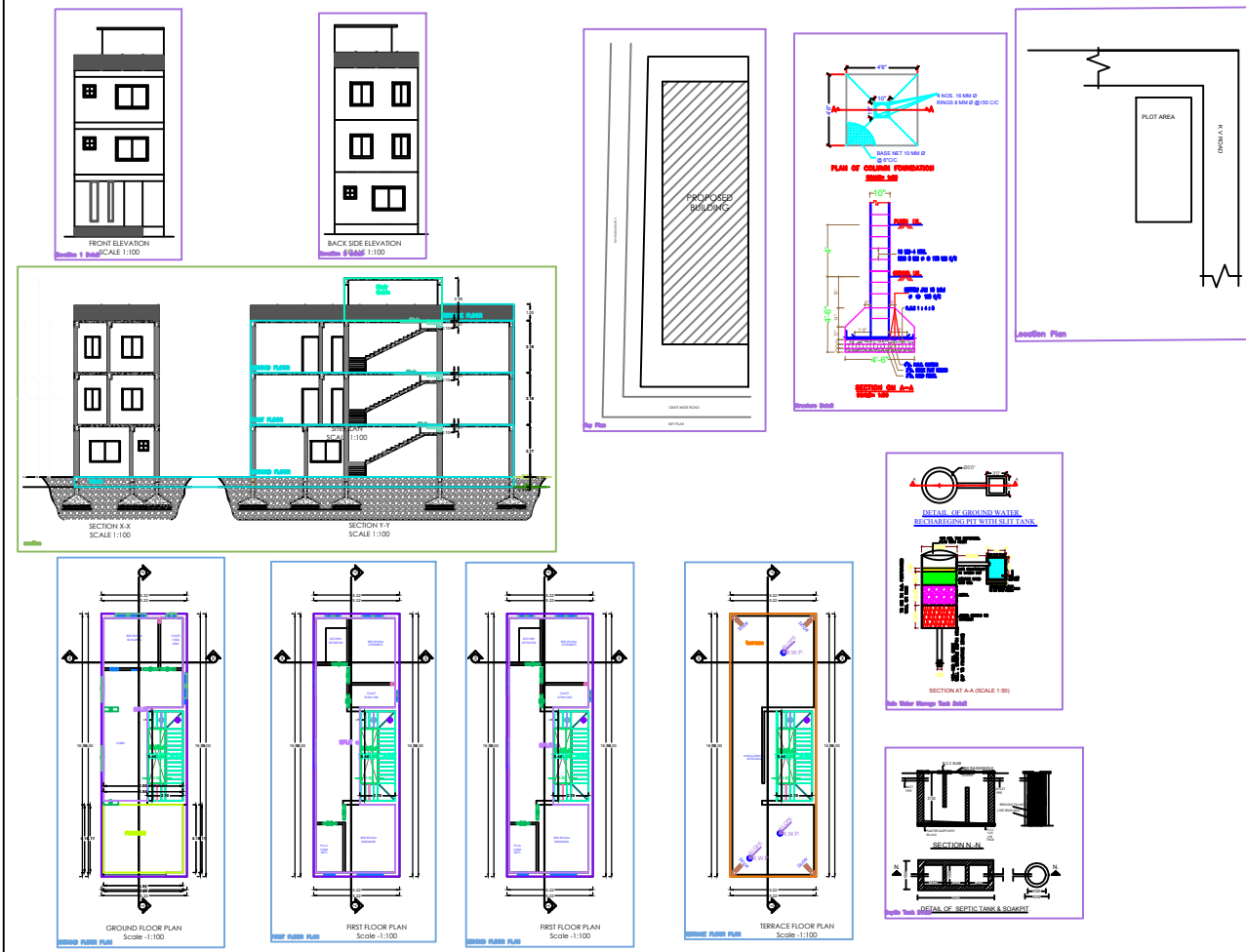

General Notes

- ALL DIMENSION ARE IN MILLIMETERS UNLESS OTHERWISE STATED.
- NO DIMENSION IS TO BE SCALED OFF THE DRAWING.
- DRAWINGS TO BE READ IN CONJUNCTION WITH ALL RELEVANT DRAWINGS & SPECIFICATIONS.
- REFER WRITTEN DIMENSIONS ONLY.
- DOORS AND WINDOW FRAME NOT TO BE FIXED ALONG WITH BRICK WORK.
- INTERNAL PLASTER SHOULD BE 12MM THICK AND EXTERNAL PLASTER 8-20MM THICK.
- FOUNDATION DEPTH UP TO 600mm.
- CEMENT MORTAR OF MIX (1:4) FOR EXTERIOR STRUCTURE AND PLASTER WORK.
- WATER TANK WILL BE ELEVATED SYSTEM.
- ALL REINFORCEMENT SHALL BE OF TOP STEEL OF GRADE T74-13.
- GRADE OF CONCRETE SHALL BE M20.

TYPE	WIDTH	HEIGHT	SILL LVL	DESCRIPTION
D1	1000	2100	NILL	SHIELD SHEETER FLOOR DOOR
D2	900	2100	NILL	**
D3	700	2100	NILL	**
CG	1500	2100	NILL	STEEL CHANNEL GATE
V1	1500	1200	900	4 LEAF GLAZED WIND
V2	1200	1200	900	**
V3	900	1200	900	**
V	600	300	2400	VENTILATOR

GENERAL DATA	DESCRIPTION
PLOT AREA AS PER DEED	- 127.23 SQMT
AREA OF GROUND FLOOR	- 83.46 SQMT
AREA OF FIRST FLOOR	- 83.46 SQMT
AREA OF SECOND FLOOR	- 83.46 SQMT
TOTAL BUILT UP AREA	- 250.38 SQMT
% of AREA COVERED	- 65.59 %
TOTAL F.A.R. ACHIEVED	- 1.96

PROPOSED RESIDENTIAL BUILDING PLAN OF DILIP KR AGRAWAL ARPANA KUMARI AGRAWAL, S/O. DILIP KUMAR AGRAWAL, PLOT NO. - 29, KHATA NO.-12, THANA NO.-194, WARD NO. - 9, VILLAGE - DIPUWA GARHWA, DIST. - GARHWA, THANA - GARHWA, STATE - JHARKHAND

SCALE: 1:100
DATE: 01 OF 01
SHEET NO. 01 OF 01

CLIENT	ENGINEER / ARCHITECT