

Project Title: SRI ANAND PRAKASH KERETTA

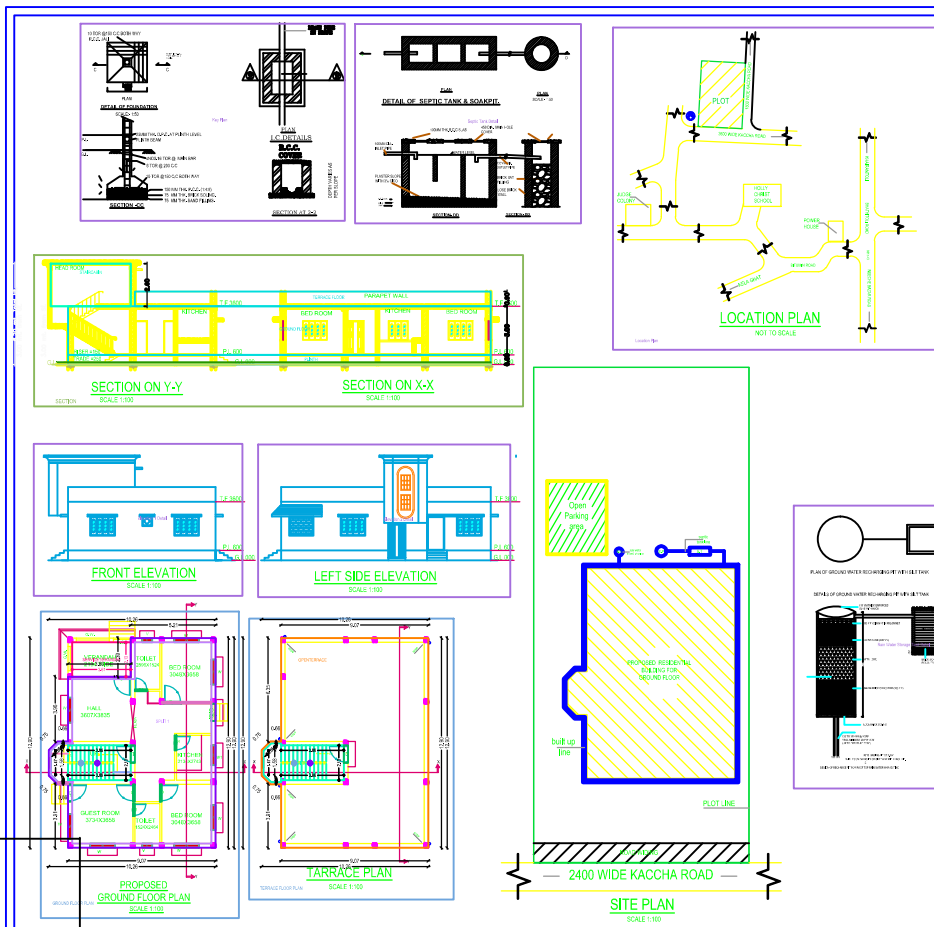

SPECIFICATIONS

- WORK IN FOUNDATION & PLINTH SHALL BE OF FIRST CLASS BRICK.
- CEMENT MORTAR 1:6 AND 1:4 SHALL BE USED FOR FACEMENT MORTAR.
- MASONRY FOUNDATION AS REQUIRED RCC COLUMN SHALL BE PROVIDED.
- LOUVRING GLAZING STRUCTURAL GLAZING OF GOOD QUALITY AND MARK VENTILATOR SYSTEM SHALL BE USED.
- ROLL UP SHUTTER SHALL BE USED FOR DOORS OPENINGS.
- ALL GLAZED/WOODEN ALUMINIUM BEECOLOR WINDOW AND R.C.C WITH CEMENT MORTAR 1:4.
- ALL R.C.C WORKS SHALL BE DONE IN 1:2:4 MIX CONCRETE.
- DATA 7M STEEL BARS SHALL BE USED IN R.C.C STRUCTURES.
- ALL MASONRY SURFACE SHALL BE PLASTERED WITH CEMENT MORTAR 1:6 OVER R.C.C SLAB/R.C.C.
- ALL ELECTRICAL WORK SHALL BE FINISHED WITH INTERNAL PLINTH.
- ALL SANITARY AND ELECTRICAL FITTINGS SHALL BE OF STANDARD BRAND WORKMANSHIP.
- UPON THE FINISH FLOOR INCLUDING STAIRCASE SHALL BE USED.

SL.NO.	SCHEDULE OF OPENINGS	DESCRIPTION
1.	D	1050x1200 Sal wood chashahat & Garthar wood shutter
2.	D1	800x1100 Sal wood chashahat & Garthar wood shutter
3.	D2	750x1100 Sal wood chashahat & Garthar wood shutter
4.	W	1500x1100 Fully glazed window
5.	W1	1000x1100 Fully glazed window
6.	W2	800x1100 Fully glazed window
7.	V	600x800 CELLING VENTILATOR
8.	C.G	2300x1200

SCHEDULE OF AREA

1. AREA OF THE PLOT AS PER DEED.	: 404.83 Sq.M : 4356.00 SQ.
2. TOTAL PLOT AREA AS PER SITE.	: 404.12 Sq.M : 4348.33 SQ.
3. OPEN PARKING AREA.	: 16.54 Sq.M : 177.97 SQ.
4. PROPOSED AREA AT GROUND FLOOR.	: 119.87 Sq.M : 1289.80 SQ.
5. TOTAL BUILD UP AREA.	: 119.87 Sq.M : 1289.80 SQ.
6. COVERED AREA.	: 119.87 X 1.09 = 29.66 % 404.12

PROPOSED RESIDENTIAL BUILDING FOR SRI ANAND PRAKASH KERETTA S/O - LATE SIMON KERETTA KHATA NO - 01, PLOT NO - 2856, RAHWAL, 1010 DECIMAL, TIRAH NO - 116, MOHALLA - KHARWATOLI MAUZA - SIMDEGA GARHWATOLI WARD NO - 04, DISTT - SIMDEGA (BARDOLMOI).

RAJ ARCHITECT CONSULTANCY
CLUB COMPLEX, JEANDRI MAIDAN
MAIN ROAD, SIMDEGA, BARBARA ROAD
MIRJOLA - 08451161475, 08956213783

SCALE - 1:100 SH NO. 11
AS MENTIONED

SPACE FOR NAGAR PANCHAYAT SEAL SIMDEGA

JUNIOR ENGINEER
NAGAR PANCHAYAT SIMDEGA
18811, SIMDEGA

EXECUTIVE OFFICER
NAGAR PANCHAYAT SIMDEGA
DISTT. SIMDEGA

ITEM NO.	DESCRIPTION	UNIT	QUANTITY	REMARKS
1.	CEMENT	TON	1000	
2.	BRICK	NO.	100000	
3.	ROOFING SHEET	SQ.M	1000	
4.	GLASS	SQ.M	1000	
5.	STEEL BARS	TON	1000	
6.	CONCRETE	CUM	1000	
7.	PLASTER	SQ.M	1000	
8.	PAINT	LITRE	1000	
9.	WATER	CUM	1000	
10.	ELECTRICAL	NO.	1000	
11.	SAFETY	NO.	1000	
12.	TOOL	NO.	1000	
13.	LABOR	NO.	1000	
14.	TRANSPORT	NO.	1000	
15.	WATER	CUM	1000	
16.	ELECTRICAL	NO.	1000	
17.	SAFETY	NO.	1000	
18.	TOOL	NO.	1000	
19.	LABOR	NO.	1000	
20.	TRANSPORT	NO.	1000	

ITEM NO.	DESCRIPTION	UNIT	QUANTITY	REMARKS
1.	CEMENT	TON	1000	
2.	BRICK	NO.	100000	
3.	ROOFING SHEET	SQ.M	1000	
4.	GLASS	SQ.M	1000	
5.	STEEL BARS	TON	1000	
6.	CONCRETE	CUM	1000	
7.	PLASTER	SQ.M	1000	
8.	PAINT	LITRE	1000	
9.	WATER	CUM	1000	
10.	ELECTRICAL	NO.	1000	
11.	SAFETY	NO.	1000	
12.	TOOL	NO.	1000	
13.	LABOR	NO.	1000	
14.	TRANSPORT	NO.	1000	
15.	WATER	CUM	1000	
16.	ELECTRICAL	NO.	1000	
17.	SAFETY	NO.	1000	
18.	TOOL	NO.	1000	
19.	LABOR	NO.	1000	
20.	TRANSPORT	NO.	1000	

ITEM NO.	DESCRIPTION	UNIT	QUANTITY	REMARKS
1.	CEMENT	TON	1000	
2.	BRICK	NO.	100000	
3.	ROOFING SHEET	SQ.M	1000	
4.	GLASS	SQ.M	1000	
5.	STEEL BARS	TON	1000	
6.	CONCRETE	CUM	1000	
7.	PLASTER	SQ.M	1000	
8.	PAINT	LITRE	1000	
9.	WATER	CUM	1000	
10.	ELECTRICAL	NO.	1000	
11.	SAFETY	NO.	1000	
12.	TOOL	NO.	1000	
13.	LABOR	NO.	1000	
14.	TRANSPORT	NO.	1000	
15.	WATER	CUM	1000	
16.	ELECTRICAL	NO.	1000	
17.	SAFETY	NO.	1000	
18.	TOOL	NO.	1000	
19.	LABOR	NO.	1000	
20.	TRANSPORT	NO.	1000	

ITEM NO.	DESCRIPTION	UNIT	QUANTITY	REMARKS
1.	CEMENT	TON	1000	
2.	BRICK	NO.	100000	
3.	ROOFING SHEET	SQ.M	1000	
4.	GLASS	SQ.M	1000	
5.	STEEL BARS	TON	1000	
6.	CONCRETE	CUM	1000	
7.	PLASTER	SQ.M	1000	
8.	PAINT	LITRE	1000	
9.	WATER	CUM	1000	
10.	ELECTRICAL	NO.	1000	
11.	SAFETY	NO.	1000	
12.	TOOL	NO.	1000	
13.	LABOR	NO.	1000	
14.	TRANSPORT	NO.	1000	
15.	WATER	CUM	1000	
16.	ELECTRICAL	NO.	1000	
17.	SAFETY	NO.	1000	
18.	TOOL	NO.	1000	
19.	LABOR	NO.	1000	
20.	TRANSPORT	NO.	1000	