

PRODUCED BY AN AUTODESK EDUCATIONAL PRODUCT

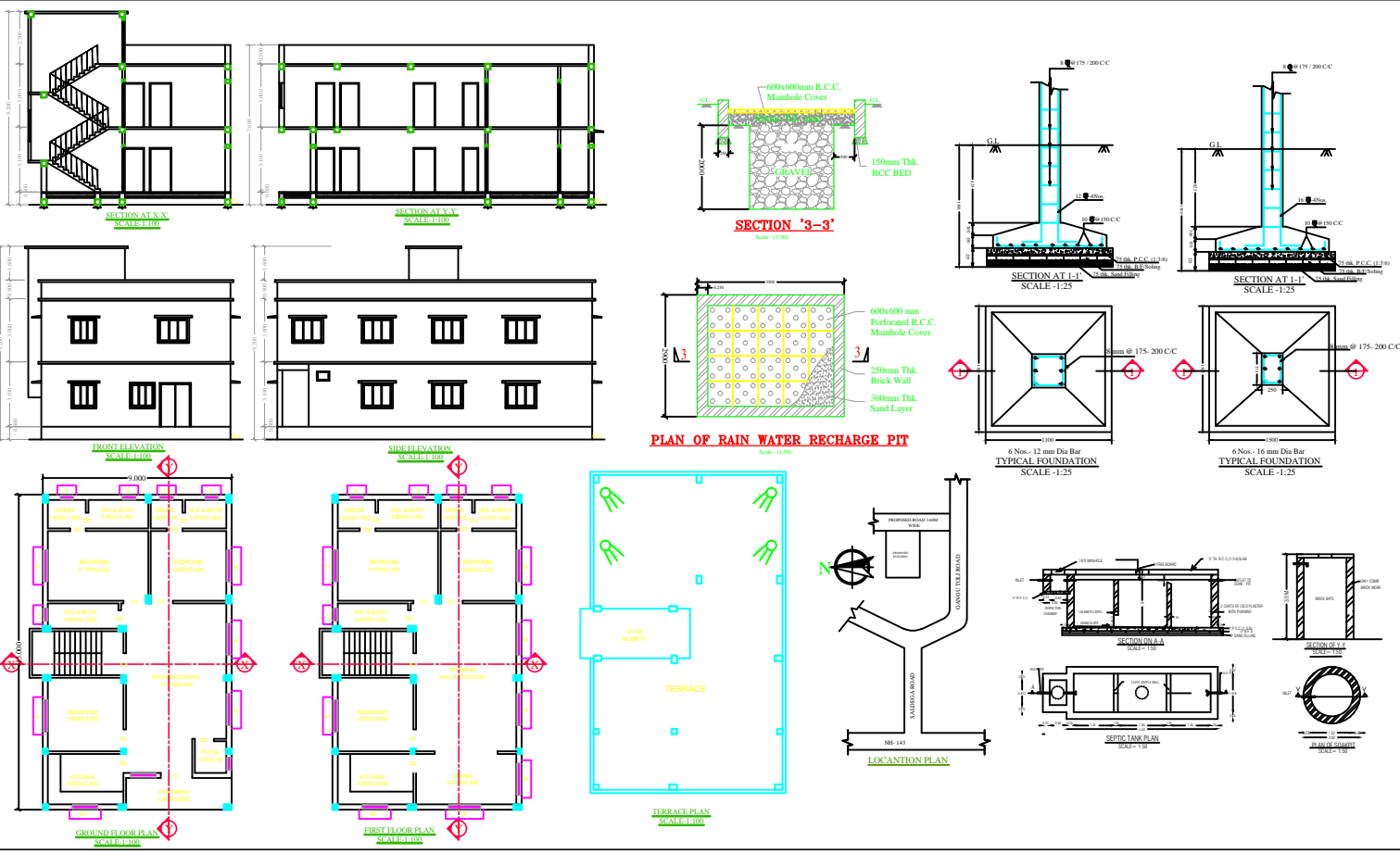

SPECIFICATION	
1. FOUNDATION	: FOUNDATION SHOWN IN AS PER DETAIL
2. FLOOR	: CERAMIC TILES
3. D.P.C.	: 40 THK. DAMP PROOF COURSE AT PLINTH LEVEL.
4. LINTEL	: 100 THK R.C.C. LINTEL IN C.C. (1:24)
5. ROOF	: 100 THK R.C.C. ROOF SLAB IN C.C. (1:12.4)
6. SUPERSTRUCTURE	: 125 THK. OR 250 THK. 1ST CLASS B/W IN (1:8)
7. PLASTER	: 12 THK. CEMENT PLASTER IN CM(1:6) OVER INTERNAL & EXTERNAL SURFACES OF WALL & 10 THK. CEMENT PLASTER
8. DOOR	: COMMERCIAL FLUSH DOORS WITH SALWOOD FRAME.
9. WINDOWS & VENT.	: FULLY GLAZED/ALUMINIUM THROUGH SEPTIC TANK.
10. SEWERAGE	: CONCEALED WIRING WITH COPPER CONDUCTOR.
11. ELECTRICAL	: THROUGH BORE WELL & O.H. WATER TANK.
12. WATER SUPPLY	: THROUGH BORE WELL & O.H. WATER TANK.
13. EXTERNAL FINISHING	: SNOUCEM.
14. INTERNAL FINISHING	: PRIMER OVER P.O.P/CEMENT PUTTY.

PROPOSED RESIDENTIAL BUILDING PLAN OF
 SRI JITENDRA PRASAD GUPTA
 S/O RAJENDRA PRASAD GUPTA
 PLOT NO. - 1665,
 MAULJA - SALDEGA,
 KHATA NO.-81, VILLAGE-SALDEGA,
 P.S. - SIMDEGA,
 THANA NO. - 81, DIST. - SIMDEGA.

LICENSED ENGINEER SIGN.	OWNER SIGN.
 THE CREATION ARCHITECT & ENGINEERS MAIN ROAD SIMDEGA-835223	
JUNIOR ENGINEER NAGAR PARISHAD, SIMDEGA.	EXECUTIVE OFFICER NAGAR PARISHAD, SIMDEGA.

PRODUCED BY AN AUTODESK EDUCATIONAL PRODUCT