

Project Title: Smt. Jyoti Soreng

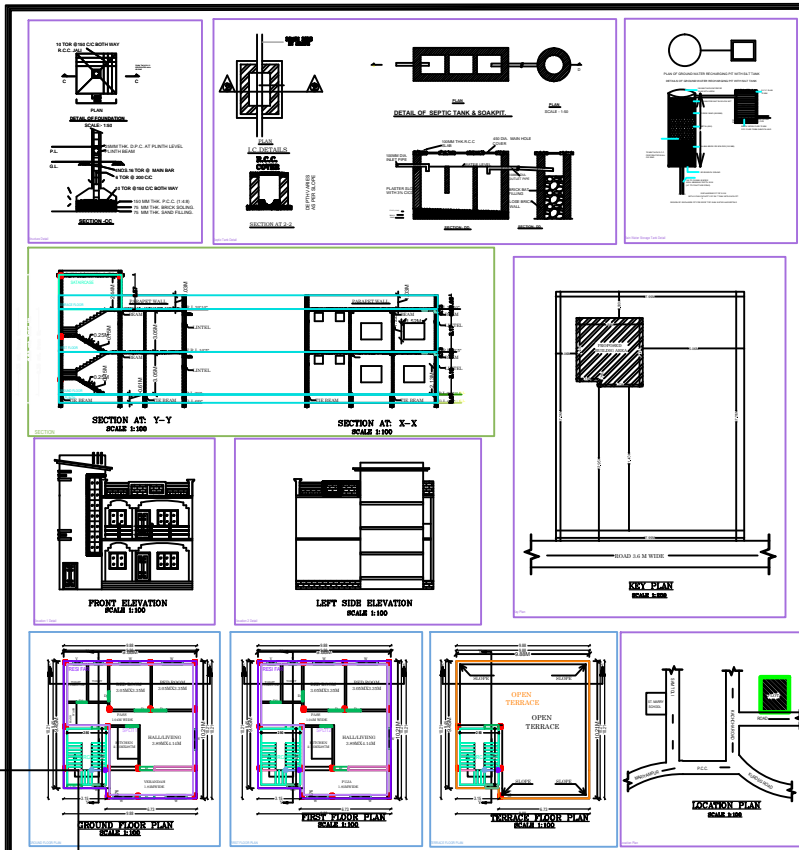
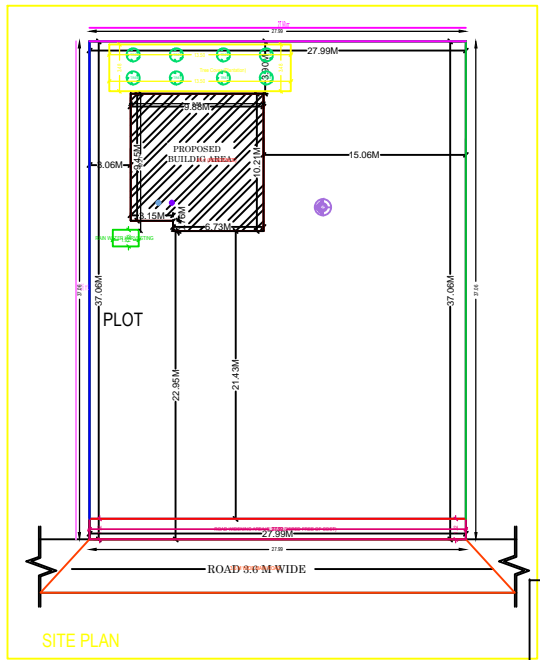

SPECIFICATIONS

- BRECKWORK IN FOUNDATION & PLINTH SHALL BE OF BEST CLASS BRICK IN CEMENT MORTAR 1:6 AND HALF BRICK WALL BE 1:CEMENT MORTAR
- MASONRY FOUNDATION WITH ISOLATED R.C.C COLUMN SHALL BE PROVIDED
- CURTAIN GLAZING STRUCTURAL GLAZING OF GOOD QUALITY AND MARK VENTILATOR SYSTEM SHALL BE USED
- ROLLING SHUTTER SHALL BE USED FOR SHOPS OPENINGS
- M.S GLAZED AND COATED ALUMINIUM PANEL, SECCOLOR WINDOW AND R.C.C WITH CEMENT MORTAR 1:4
- ALL R.C.C WORKS SHALL BE DONE IN 1:2:4 MIX CONCRETE
- REINFORCING STEEL BARS SHALL BE USED IN R.C.C STRUCTURES COMMERCIAL QUALITY
- ALL MASONRY SURFACE SHALL BE PLASTERED WITH CEMENT MORTAR 1:6 OVER R.C.C SLAB / P.C.C
- ALL SHAPERS AND ELECTRICAL FITTINGS SHALL BE OF STANDARD MARKING WORKMANSHIP
- ROOFING: STONE / MOSAIC FLOORING INCLUDING STAIRCASE SHALL BE USED

SCHEDULE OF OPENINGS		
S.NO.	SIZE	DESCRIPTION
1.	D	1.05X2.10 Gal wood chashua & Quarter wood shutter
2.	D1	3.0X2.10 Gal wood chashua & Quarter wood shutter
3.	D2	7.5X2.10 Gal wood chashua & Quarter wood shutter
4.	W	1.20X1.20 Fully glazed window
5.	W1	0.90X1.20 Fully glazed window
6.	W2	Fully glazed window
7.	V	.60X.60 CELLING VENTILATOR
8.	C.G.	1.05X2.10

SCHEDULE OF AREA

1. TOTAL PLOT AREA AS PER SITE	: 1037.42 Sq. M.
2. PROPOSED AREA AT GROUND FLOOR	: 98.49 Sq. M.
3. PROPOSED AREA AT FIRST FLOOR	: 98.49 Sq. M.
4. TOTAL BUILD UP AREA	: 196.98 Sq. M.
5. COVERED AREA	: 98.49x100 = 09.49% 1037.42

PROPOSED RESIDENTIAL BUILDING FOR
Smt. Jyoti Soreng
W/O - ZERALD SORENG
KMATI NO - 86, PLOT NO - 2224.2225
RANVA - 12414-COCCESMIL,
THANA NO - 105,
MOHALLA - KHURJI
MALZA - KHURJI
DISTT - SIMDEGA (HARSHANDI)

RAJ ARCHITECT CONSULTANCY
1/18 COMPLEX, GANERH MARDAN
MAIN ROAD SIMDEGA, HARSHAND
MOBILE: 9831134233, 9831134233
SCALE - 1:100

AS MENTIONED L1

APPROVED BY: _____
DATE: _____

NO.	DESCRIPTION	UNIT	QTY	UNIT PRICE	TOTAL
1
2
3
4
5
6
7
8
9
10
11
12
13
14
15
16
17
18
19
20
21
22
23
24
25
26
27
28
29
30
31
32
33
34
35
36
37
38
39
40
41
42
43
44
45
46
47
48
49
50

COLOR KEY

GREEN	...
RED	...
BLUE	...
YELLOW	...
BLACK	...

Building AT (RESIDENCE)

NO.	DESCRIPTION	UNIT	QTY	UNIT PRICE	TOTAL
1
2
3
4
5
6
7
8
9
10
11
12
13
14
15
16
17
18
19
20
21
22
23
24
25
26
27
28
29
30
31
32
33
34
35
36
37
38
39
40
41
42
43
44
45
46
47
48
49
50

UNIT PRICE TO BUILDING AT (RESIDENCE)

NO.	DESCRIPTION	UNIT	QTY	UNIT PRICE	TOTAL
1
2
3
4
5
6
7
8
9
10
11
12
13
14
15
16
17
18
19
20
21
22
23
24
25
26
27
28
29
30
31
32
33
34
35
36
37
38
39
40
41
42
43
44
45
46
47
48
49
50