

Project Title - JULIANA TIGGA

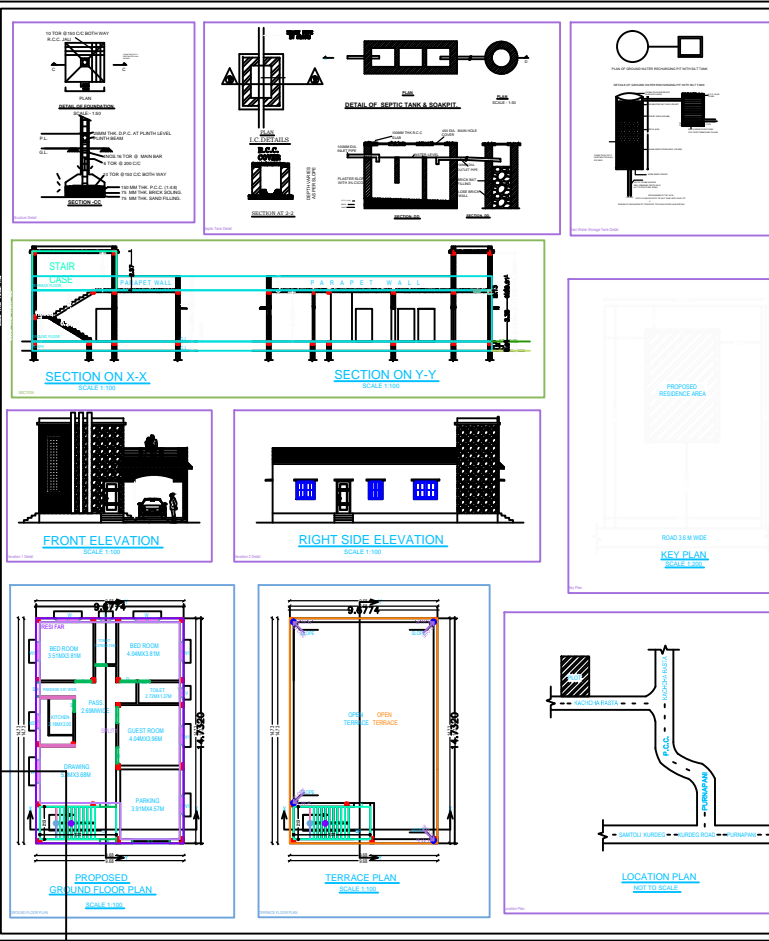

SPECIFICATIONS

- BRICKWORK IN FOUNDATION & PLINTH SHALL BE OF FIRST CLASS BRICK IN CEMENT MORTAR 1:6 AND HALF BRICK WALL BE 1:4 CEMENT MORTAR.
- ABOVE GROUND FOUNDATION WITH ISOLATED R.C.C. COLUMN SHALL BE PROVIDED.
- CURTAIN GLAZING STRUCTURAL GLAZING OF GOOD QUALITY AND MARK VENTILATION SYSTEM SHALL BE USED.
- ROLLING SHUTTER SHALL BE USED FOR SHOPS OPENINGS.
- M.S GLAZED/ANODIZED ALUMINUM PANEL, BE COLOR WINDOW AND R.C.C WITH CEMENT MORTAR 1:4.
- ALL R.C.C WORKS SHALL BE DONE IN 1:2:4 MIX CONCRETE.
- DATA TMT STEEL BARS SHALL BE USED IN R.C.C STRUCTURES COMMON QUALITY.
- ALL WINDOW SURFACE SHALL BE PLASTERED WITH CEMENT MORTAR 1:6 OVER R.C.C SLAB / P.C.C.
- ALL LITERS AND WOOD WORK SHALL BE PAINTED WITH SYNTHETICAL PAINT.
- ALL SHOWER AND ELECTRICAL FITTING SHALL BE OF CHROME PLATING WORKMANSHIP.
- ROOFING: ZONE MASONIC CEILING INCLUDING STAIRCASE SHALL BE USED.

S.NO.	SCHEDULE OF OPENINGS
1.	D 1.05X2.10 Slab window & General wood shutter
2.	D1 1.05X2.10 Slab window & General wood shutter
3.	D2 1.05X2.10 Slab window & General wood shutter
4.	W1 1.50X1.20 Fully glazed window
5.	W2 1.50X1.20 Fully glazed window
6.	W3 1.50X1.20 Fully glazed window
7.	V 1.05X0.60 CEILING VANTLOTER
8.	

SCHEDULE OF AREA

1. TOTAL PLOT AREA AS PER SITE	599.93 Sq.M
2. PROPOSED AREA AT GROUND FLOOR	142.57 Sq.M
3. TOTAL BUILT UP AREA	142.57 Sq.M
4. COVERED AREA	142.57 Sq.M = 31.67 %
	599.93

PROPOSED RESIDENTIAL BUILDING FOR SHIP - JULIANA TIGGA
 D/O - EMANUEL TIGGA
 KHATA NO - 119, PLOT NO - 587
 RAKWAL - 15.00 DECIMAL,
 TRANA NO - 105,
 MOWALLA - KHURJI PURNAPANI
 MALUZA - KHURJI
 SOCIETY - SINGHIA (SARJANWADI)
RAJ ARCHITECT CONSULTANCY
 TELLER COMPLEX, JAGDEH MANSAN
 MAIN ROAD, SHREEKOT, BHAKHARWADI
 MUMBAI - 400119 (91) 9820000000-2001

SCALE - 1:100 1:100

AS MENTIONED 1:1

SPACE FOR NAGAR PARISHAD SEAL SINDEGA

NO.	DESCRIPTION	UNIT	QUANTITY	REMARKS
1	CEMENT	MT	1000	
2	BRICK	NO	10000	
3	ROOFING	SQ.M	100	
4	PAINT	LITRE	1000	
5	GLASS	SQ.M	100	
6	STEEL	MT	100	
7	CONCRETE	CUM	100	
8	WATER	LITRE	10000	
9	ELECTRICITY	UNIT	100	
10	PLASTER	SQ.M	100	
11	ROOFING	SQ.M	100	
12	PAINT	LITRE	1000	
13	GLASS	SQ.M	100	
14	STEEL	MT	100	
15	CONCRETE	CUM	100	
16	WATER	LITRE	10000	
17	ELECTRICITY	UNIT	100	
18	PLASTER	SQ.M	100	
19	ROOFING	SQ.M	100	
20	PAINT	LITRE	1000	
21	GLASS	SQ.M	100	
22	STEEL	MT	100	
23	CONCRETE	CUM	100	
24	WATER	LITRE	10000	
25	ELECTRICITY	UNIT	100	
26	PLASTER	SQ.M	100	
27	ROOFING	SQ.M	100	
28	PAINT	LITRE	1000	
29	GLASS	SQ.M	100	
30	STEEL	MT	100	
31	CONCRETE	CUM	100	
32	WATER	LITRE	10000	
33	ELECTRICITY	UNIT	100	
34	PLASTER	SQ.M	100	
35	ROOFING	SQ.M	100	
36	PAINT	LITRE	1000	
37	GLASS	SQ.M	100	
38	STEEL	MT	100	
39	CONCRETE	CUM	100	
40	WATER	LITRE	10000	
41	ELECTRICITY	UNIT	100	
42	PLASTER	SQ.M	100	
43	ROOFING	SQ.M	100	
44	PAINT	LITRE	1000	
45	GLASS	SQ.M	100	
46	STEEL	MT	100	
47	CONCRETE	CUM	100	
48	WATER	LITRE	10000	
49	ELECTRICITY	UNIT	100	
50	PLASTER	SQ.M	100	
51	ROOFING	SQ.M	100	
52	PAINT	LITRE	1000	
53	GLASS	SQ.M	100	
54	STEEL	MT	100	
55	CONCRETE	CUM	100	
56	WATER	LITRE	10000	
57	ELECTRICITY	UNIT	100	
58	PLASTER	SQ.M	100	
59	ROOFING	SQ.M	100	
60	PAINT	LITRE	1000	
61	GLASS	SQ.M	100	
62	STEEL	MT	100	
63	CONCRETE	CUM	100	
64	WATER	LITRE	10000	
65	ELECTRICITY	UNIT	100	
66	PLASTER	SQ.M	100	
67	ROOFING	SQ.M	100	
68	PAINT	LITRE	1000	
69	GLASS	SQ.M	100	
70	STEEL	MT	100	
71	CONCRETE	CUM	100	
72	WATER	LITRE	10000	
73	ELECTRICITY	UNIT	100	
74	PLASTER	SQ.M	100	
75	ROOFING	SQ.M	100	
76	PAINT	LITRE	1000	
77	GLASS	SQ.M	100	
78	STEEL	MT	100	
79	CONCRETE	CUM	100	
80	WATER	LITRE	10000	
81	ELECTRICITY	UNIT	100	
82	PLASTER	SQ.M	100	
83	ROOFING	SQ.M	100	
84	PAINT	LITRE	1000	
85	GLASS	SQ.M	100	
86	STEEL	MT	100	
87	CONCRETE	CUM	100	
88	WATER	LITRE	10000	
89	ELECTRICITY	UNIT	100	
90	PLASTER	SQ.M	100	
91	ROOFING	SQ.M	100	
92	PAINT	LITRE	1000	
93	GLASS	SQ.M	100	
94	STEEL	MT	100	
95	CONCRETE	CUM	100	
96	WATER	LITRE	10000	
97	ELECTRICITY	UNIT	100	
98	PLASTER	SQ.M	100	
99	ROOFING	SQ.M	100	
100	PAINT	LITRE	1000	

Building A1 (RESIDENCE)

NO.	DESCRIPTION	UNIT	QUANTITY	REMARKS
1	CEMENT	MT	1000	
2	BRICK	NO	10000	
3	ROOFING	SQ.M	100	
4	PAINT	LITRE	1000	
5	GLASS	SQ.M	100	
6	STEEL	MT	100	
7	CONCRETE	CUM	100	
8	WATER	LITRE	10000	
9	ELECTRICITY	UNIT	100	
10	PLASTER	SQ.M	100	
11	ROOFING	SQ.M	100	
12	PAINT	LITRE	1000	
13	GLASS	SQ.M	100	
14	STEEL	MT	100	
15	CONCRETE	CUM	100	
16	WATER	LITRE	10000	
17	ELECTRICITY	UNIT	100	
18	PLASTER	SQ.M	100	
19	ROOFING	SQ.M	100	
20	PAINT	LITRE	1000	
21	GLASS	SQ.M	100	
22	STEEL	MT	100	
23	CONCRETE	CUM	100	
24	WATER	LITRE	10000	
25	ELECTRICITY	UNIT	100	
26	PLASTER	SQ.M	100	
27	ROOFING	SQ.M	100	
28	PAINT	LITRE	1000	
29	GLASS	SQ.M	100	
30	STEEL	MT	100	
31	CONCRETE	CUM	100	
32	WATER	LITRE	10000	
33	ELECTRICITY	UNIT	100	
34	PLASTER	SQ.M	100	
35	ROOFING	SQ.M	100	
36	PAINT	LITRE	1000	
37	GLASS	SQ.M	100	
38	STEEL	MT	100	
39	CONCRETE	CUM	100	
40	WATER	LITRE	10000	
41	ELECTRICITY	UNIT	100	
42	PLASTER	SQ.M	100	
43	ROOFING	SQ.M	100	
44	PAINT	LITRE	1000	
45	GLASS	SQ.M	100	
46	STEEL	MT	100	
47	CONCRETE	CUM	100	
48	WATER	LITRE	10000	
49	ELECTRICITY	UNIT	100	
50	PLASTER	SQ.M	100	
51	ROOFING	SQ.M	100	
52	PAINT	LITRE	1000	
53	GLASS	SQ.M	100	
54	STEEL	MT	100	
55	CONCRETE	CUM	100	
56	WATER	LITRE	10000	
57	ELECTRICITY	UNIT	100	
58	PLASTER	SQ.M	100	
59	ROOFING	SQ.M	100	
60	PAINT	LITRE	1000	
61	GLASS	SQ.M	100	
62	STEEL	MT	100	
63	CONCRETE	CUM	100	
64	WATER	LITRE	10000	
65	ELECTRICITY	UNIT	100	
66	PLASTER	SQ.M	100	
67	ROOFING	SQ.M	100	
68	PAINT	LITRE	1000	
69	GLASS	SQ.M	100	
70	STEEL	MT	100	
71	CONCRETE	CUM	100	
72	WATER	LITRE	10000	
73	ELECTRICITY	UNIT	100	
74	PLASTER	SQ.M	100	
75	ROOFING	SQ.M	100	
76	PAINT	LITRE	1000	
77	GLASS	SQ.M	100	
78	STEEL	MT	100	
79	CONCRETE	CUM	100	
80	WATER	LITRE	10000	
81	ELECTRICITY	UNIT	100	
82	PLASTER	SQ.M	100	
83	ROOFING	SQ.M	100	
84	PAINT	LITRE	1000	
85	GLASS	SQ.M	100	
86	STEEL	MT	100	
87	CONCRETE	CUM	100	
88	WATER	LITRE	10000	
89	ELECTRICITY	UNIT	100	
90	PLASTER	SQ.M	100	
91	ROOFING	SQ.M	100	
92	PAINT	LITRE	1000	
93	GLASS	SQ.M	100	
94	STEEL	MT	100	
95	CONCRETE	CUM	100	
96	WATER	LITRE	10000	
97	ELECTRICITY	UNIT	100	
98	PLASTER	SQ.M	100	
99	ROOFING	SQ.M	100	
100	PAINT	LITRE	1000	