

Project Title - SHARMANEM ENLUQUIN

**DETAIL OF FOUNDATION**

**DETAIL OF SEPTIC TANK & SOAKPIT**

**Water Storage Tank Detail**

**SECTION ON X-X**

**SECTION ON Y-Y**

**KEY PLAN**

**FRONT ELEVATION**

**LEFT SIDE ELEVATION**

**LOCATION PLAN**

**PROPOSED GROUND FLOOR PLAN**

**PROPOSED FIRST FLOOR PLAN**

**TERRACE FLOOR PLAN**

**SPECIFICATIONS**

- BRICKWORK IN FOUNDATION & PLINTH SHALL BE OF FIRST CLASS BRICK IN CEMENT MORTAR 1:6 AND HALF BRICK WALL BE 1:4 CEMENT MORTAR
- MASONRY FOUNDATION WITH SOLID R.C.C. COLUMN SHALL BE PROVIDED
- CURTAIN GLAZING STRUCTURAL GLAZING OF GOOD QUALITY AND MAIN VENTILATOR SYSTEM SHALL BE USED
- HOLLOW SHUTTER SHALL BE USED FOR SHOPS OPENINGS
- MS GLAZED ALUMINIUM WINDOW SECTION OR WINDOW AND R.C.C WITH CEMENT MORTAR 1:4
- ALL R.C.C WORK SHALL BE DONE IN 1:2 MIX CONCRETE
- TATA MS STEEL BARS SHALL BE USED IN R.C.C STRUCTURES COMMERCIAL QUALITY
- ALL MASONRY SURFACE SHALL BE PLASTERED WITH CEMENT MORTAR 1:6 OVER R.C.C SLAB / P.C.C
- PLASTER AND WOOD WORK SHALL BE PAINTED WITH SYNTHETIC PAINT
- ALL SANITARY AND ELECTRICAL FITTINGS SHALL BE OF STANDARD MARKED BRAND/TYPE
- KOFTA STONE / MOSAIC FLOORING INCLUDING STAIRCASE SHALL BE USED

SL.NO.	SCHEDULE OF OPENINGS	SIZE	DESCRIPTION
1.	D	1.05X2.10	Sil wood chauthai & Garhar wood shutter
2.	D1	3.0X2.10	Sil wood chauthai & Garhar wood shutter
3.	D2	7.9X2.10	Sil wood chauthai & Garhar wood shutter
4.	D3	1.01X2.10	Sil wood chauthai & Garhar wood shutter
5.	D4	8.8X2.10	Sil wood chauthai & Garhar wood shutter
6.	W	1.50X1.20	Fully glazed window
7.	W1	1.20X1.20	Fully glazed window
8.	W2	3.0X1.20	Fully glazed window
9.	V	80X80	CEILING VENTILATOR

**SCHEDULE OF AREA**

1.	TOTAL PLOT AREA AS PER SITE	298.72 Sq.M
2.	PROPOSED AREA AT GROUND FLOOR	127.44 Sq.M
3.	PROPOSED AREA AT FIRST FLOOR	127.44 Sq.M
4.	TOTAL BUILD UP AREA	254.88 Sq.M
5.	COVERED AREA	177.44/100 = 42.66% 254.88/2

PROPOSED RESIDENTIAL BUILDING FOR SHARMANEM ENLUQUIN D/O - LATE AUGUSTIN MUNDA KHATA NO - 236 PLOT NO - 3515 RAJAWA - 07.5 DECIMAL, THANA NO - 80, MOHALLA - DIPTY TOLI MALWA - GOTRA, DIPTY TOLI (DISTT - SIMDEGA, JHARKHAND)

RAJ CONSULTANCY CLU COLONY GANSHI MANDAN MAIN ROAD SIMDEGA, JHARKHAND MOBILE - 98311 94393 (INDIA)

SCALE - 1:100

AS MENTIONED

SPACE FOR NAGAR PASHAD SEAL SIMDEGA

MONITOR OF DAY ENGINEER TO NAGAR PASHAD OFFICE

SCALE NO. OF COPY

MONITOR OF DAY ENGINEER TO NAGAR PASHAD OFFICE

SCALE NO. OF COPY

MONITOR OF DAY ENGINEER TO NAGAR PASHAD OFFICE

SCALE NO. OF COPY

MONITOR OF DAY ENGINEER TO NAGAR PASHAD OFFICE

SCALE NO. OF COPY

MONITOR OF DAY ENGINEER TO NAGAR PASHAD OFFICE

SCALE NO. OF COPY

MONITOR OF DAY ENGINEER TO NAGAR PASHAD OFFICE

SCALE NO. OF COPY

MONITOR OF DAY ENGINEER TO NAGAR PASHAD OFFICE

SCALE NO. OF COPY

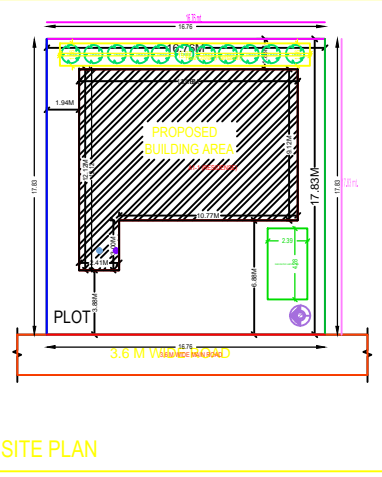

(RESERVE)

Building A1 (RESERVE)