

Project Title :NAZYA NAZ BANO

NO.	DESCRIPTION	UNIT	QUANTITY	REMARKS
1	FOUNDATION	M ³	100.00	
2	CEMENT MORTAR	M ²	100.00	
3	REINFORCEMENT	KG	100.00	
4	CONCRETE	M ³	100.00	
5	BRICKWORK	M ³	100.00	
6	PLASTER	M ²	100.00	
7	PAINT	LITRE	100.00	
8	ROOFING	M ²	100.00	
9	GLAZING	M ²	100.00	
10	MECHANICAL	M ²	100.00	
11	ELECTRICAL	M ²	100.00	
12	LANDSCAPE	M ²	100.00	
13	WATER SUPPLY	M ²	100.00	
14	SEWERAGE	M ²	100.00	
15	ROADWORK	M ²	100.00	
16	UTILITIES	M ²	100.00	
17	FINISHES	M ²	100.00	
18	MECHANICAL	M ²	100.00	
19	ELECTRICAL	M ²	100.00	
20	LANDSCAPE	M ²	100.00	
21	WATER SUPPLY	M ²	100.00	
22	SEWERAGE	M ²	100.00	
23	ROADWORK	M ²	100.00	
24	UTILITIES	M ²	100.00	
25	FINISHES	M ²	100.00	

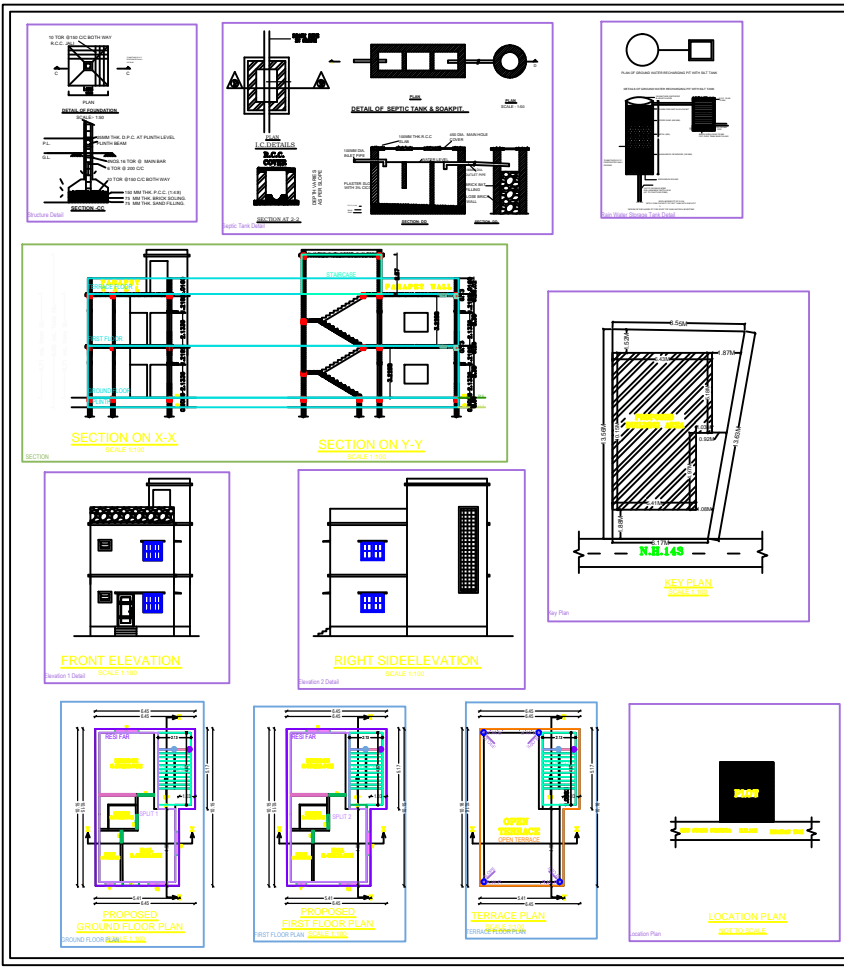

SPECIFICATIONS		
1.	BRICKWORK IN FOUNDATION & R.C.C. SHALL BE OF FIRST CLASS BRICK	
2.	CEMENT MORTAR 1:5 AND HALF BRICK SHALL BE 1:CEMENT MORTAR	
3.	MASONRY FOUNDATION WITH ISOLATED R.C.C. COLUMN SHALL BE PROVIDED	
4.	CURTAIN GLAZING STRUCTURAL GLAZING OF GOOD QUALITY AND MARK VENTILATION SYSTEM SHALL BE USED	
5.	HOLLING SHUTTER SHALL BE USED FOR SHOPS OPENINGS	
6.	AS GLAZING UNFINISHED ALUMINIUM WINDOW, SECTION WINDOW AND R.C.C. WITH CEMENT MORTAR 1:4	
7.	ALL R.C.C. WORK SHALL BE DONE IN 1:2:4 MIX CONCRETE	
8.	ALL MASONRY SURFACE SHALL BE PLASTERED WITH CEMENT MORTAR 1:6 OVER R.C.C. SLAB / P.C.C.	
9.	ALL LANTERNS AND ELECTRICAL FITTINGS SHALL BE OF STANDARD MARK AND WORKMANSHIP	
10.	ALL LANTERNS AND ELECTRICAL FITTINGS SHALL BE OF STANDARD MARK AND WORKMANSHIP	
11.	STONE / MOSAIC FLOORING INCLUDING STAIRCASE SHALL BE USED	

SI. NO.	SIZE	DESCRIPTION
1.	D	1.00X2.10
2.	S1	50X2.10
3.	D2	75X2.10
4.	W	1.50X1.20
5.	W1	1.20X1.20
6.	W2	90X1.20
7.	V	60X60

SCHEDULE OF AREA	
1.	TOTAL PLOT AREA AS PER SITE
2.	PROPOSED AREA AT GROUND FLOOR
3.	PROPOSED AREA AT FIRST FLOOR
4.	TOTAL BUILT UP AREA
5.	COVERED AREA

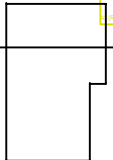
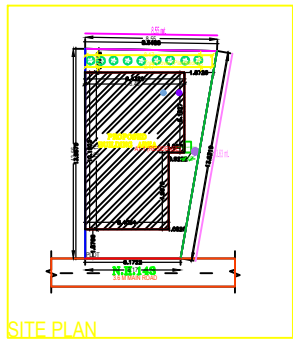

Building A1 (RESIDENCE)					
NO.	DESCRIPTION	UNIT	QUANTITY	REMARKS	NO.
1	FOUNDATION	M ³	100.00		1
2	CEMENT MORTAR	M ²	100.00		2
3	REINFORCEMENT	KG	100.00		3
4	CONCRETE	M ³	100.00		4
5	BRICKWORK	M ³	100.00		5
6	PLASTER	M ²	100.00		6
7	PAINT	LITRE	100.00		7
8	ROOFING	M ²	100.00		8
9	GLAZING	M ²	100.00		9
10	MECHANICAL	M ²	100.00		10
11	ELECTRICAL	M ²	100.00		11
12	LANDSCAPE	M ²	100.00		12
13	WATER SUPPLY	M ²	100.00		13
14	SEWERAGE	M ²	100.00		14
15	ROADWORK	M ²	100.00		15
16	UTILITIES	M ²	100.00		16
17	FINISHES	M ²	100.00		17
18	MECHANICAL	M ²	100.00		18
19	ELECTRICAL	M ²	100.00		19
20	LANDSCAPE	M ²	100.00		20
21	WATER SUPPLY	M ²	100.00		21
22	SEWERAGE	M ²	100.00		22
23	ROADWORK	M ²	100.00		23
24	UTILITIES	M ²	100.00		24
25	FINISHES	M ²	100.00		25