

PRODUCED BY AN AUTODESK EDUCATIONAL PRODUCT

Project Title: RAJESH KUMAR AGRAWAL

PRODUCED BY AN AUTODESK EDUCATIONAL PRODUCT

DETAIL OF FOUNDATION
SCALE: 1:50
1. BEAM THK. D.P.C. AT PLINTH LEVEL
2. PLINTH BEAM
3. R.O.S 18 TOR @ MAIN BAR
4. TOR @ 200 C/C
5. TOR @ 150 C/C BOTH WAY
6. 150 MM THK. R.C.C. 1:4:8
7. 75 MM THK. BRICK SOLING
8. 75 MM THK. SAND FILLING
9. 10 TOR @ 150 C/C BOTH WAY
10. R.C.C. WALL

DETAIL OF SEPTIC TANK & SOAKPIT
SCALE: 1:10
1. 1000x1000x1500
2. 1000x1000x1500
3. 1000x1000x1500
4. 1000x1000x1500
5. 1000x1000x1500
6. 1000x1000x1500
7. 1000x1000x1500
8. 1000x1000x1500
9. 1000x1000x1500
10. 1000x1000x1500

SECTION CC
SCALE: 1:10
1. 10 TOR @ 150 C/C BOTH WAY
2. R.C.C. WALL
3. 10 TOR @ 150 C/C BOTH WAY
4. R.C.C. WALL

SCHEDULE OF OPENINGS

SL.NO.	SIZE	DESCRIPTION
1.	D	160x210 Set wood chakran & Gerni's wood shutter
2.	D1	50x210 Set wood chakran & Gerni's wood shutter
3.	D2	75x210 Set wood chakran & Gerni's wood shutter
4.	W	1.80x1.20 Fully glazed window
5.	W1	1.20x1.20 Fully glazed window
6.	W2	90x1.20 Fully glazed window
7.	V	60x60 CELLING VANTLOTER

SCHEDULE OF AREA

- TOTAL PLOT AREA AS PER SITE: 219.92 Sq.M
- PROPOSED AREA AT GROUND FLOOR: 89.08 Sq.M
- PROPOSED AREA AT FIRST FLOOR: 120.02 Sq.M
- PROPOSED AREA AT SECOND FLOOR: 120.02 Sq.M
- PROPOSED AREA AT THIRD FLOOR: 120.02 Sq.M
- TOTAL BUILD UP AREA: 475.29
- COVERED AREA: 89.08/100 = 2.13% = 40.50%

PROPOSED RESIDENTIAL BUILDING FOR SRI - RAJESH KUMAR AGRAWAL
S/O - LATE JAGDISH AGRAWAL
KHATA NO - 26, PLOT NO -607,609
RAKWA, -19 DECIMAL
THANA NO -117
MOHALLA - KUNJ NAGAR, SIMDEGA
MAUZA - SALDEGA
DISTT. - SIMDEGA (JHARKHAND)

SCALE - 1:100
AS MENTIONED

DATE: 01/11/2023

SIGNATURE OF I.C. ENGINEER: [Signature]
SIGNATURE OF OWNER: [Signature]

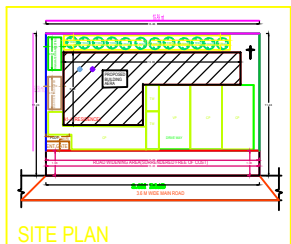

GENERAL INFORMATION			
Sl. No.	Particulars	Unit	Quantity
1.	Plot Area	Sq. M	219.92
2.	Proposed Area at Ground Floor	Sq. M	89.08
3.	Proposed Area at First Floor	Sq. M	120.02
4.	Proposed Area at Second Floor	Sq. M	120.02
5.	Proposed Area at Third Floor	Sq. M	120.02
6.	Total Build Up Area	Sq. M	475.29
7.	Covered Area	%	40.50

MATERIALS			
Sl. No.	Particulars	Unit	Quantity
1.	1st Class Brick	Sq. M	1.50
2.	1st Class Brick	Sq. M	1.50
3.	1st Class Brick	Sq. M	1.50

PRODUCED BY AN AUTODESK EDUCATIONAL PRODUCT

PRODUCED BY AN AUTODESK EDUCATIONAL PRODUCT

Building at Residence:

Sl. No.	Particulars	Unit	Quantity
1.	Plot Area	Sq. M	219.92
2.	Proposed Area at Ground Floor	Sq. M	89.08
3.	Proposed Area at First Floor	Sq. M	120.02
4.	Proposed Area at Second Floor	Sq. M	120.02
5.	Proposed Area at Third Floor	Sq. M	120.02
6.	Total Build Up Area	Sq. M	475.29
7.	Covered Area	%	40.50

Schedule of Quantity:

Sl. No.	Particulars	Unit	Quantity
1.	1st Class Brick	Sq. M	1.50
2.	1st Class Brick	Sq. M	1.50
3.	1st Class Brick	Sq. M	1.50

Area Year to Building at Residence:

Sl. No.	Particulars	Unit	Quantity
1.	Plot Area	Sq. M	219.92
2.	Proposed Area at Ground Floor	Sq. M	89.08
3.	Proposed Area at First Floor	Sq. M	120.02
4.	Proposed Area at Second Floor	Sq. M	120.02
5.	Proposed Area at Third Floor	Sq. M	120.02
6.	Total Build Up Area	Sq. M	475.29
7.	Covered Area	%	40.50