

Project Title : SMT NIRMALA KULLU

PRODUCED BY AN AUTODESK EDUCATIONAL PRODUCT

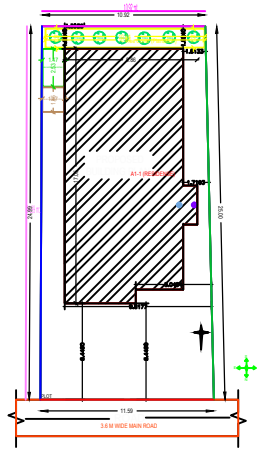

SITE PLAN

SPECIFICATIONS

- BRICKWORK IN FOUNDATION & PLINTH SHALL BE OF FIRST CLASS BRICK IN CEMENT MORTAR 1:6 AND HALF BRICK WILL BE 1:4 CEMENT MORTAR
- MAZDANARY FOUNDATION WITH ISOLATED R.C.C COLUMN SHALL BE PROVIDED
- CONCRETE SHALL BE OF GOOD QUALITY AND MAJOR VENTILATOR SYSTEM SHALL BE USED
- ROLLING SHUTTER SHALL BE USED FOR SHOP'S OPENINGS
- 1/2" SLATED WOODEN ALUMINUMS BECCOLOR WINDOW AND R.C.C WITH CEMENT MORTAR 1:4
- ALL R.C.C WORKS SHALL BE DONE IN 1:2:4 MIX CONCRETE
- TATA 700 STEEL WARE SHALL BE USED IN R.C.C STRUCTURES COMMERCIAL QUALITY
- ALL MAZDANARY SURFACE SHALL BE PLASTERED WITH CEMENT MORTAR 1:4 OVER R.C.C SLAB / R.C.C
- ALL STEEL AND ELECTRICAL FITTINGS SHALL BE OF SYNTHETIC PAINT TO ALL SANITARY AND ELECTRICAL FITTINGS SHALL BE OF STANDARD MARKED WORKMANSHIP
- KOTTA STONE / MOSAIC FLOORING INCLUDING STAIRCASE SHALL BE USED

SL.NO.	SIZE	DESCRIPTION
1.	D	1.07X2.13 Sal wood chauthai & Gambhar wood shutter
2.	D1	0.97X2.13 Sal wood chauthai & Gambhar wood shutter
3.	D2	0.76X2.13 Sal wood chauthai & Gambhar wood shutter
4.	W	1.52X1.52 Fully glazed window
5.	W1	1.22X1.22 Fully glazed window
7.	W2	0.90X1.22 Fully glazed window
8.	V	0.61X0.61 CELLING VANTILETOR

SCHEDULE OF AREA

- TOTAL PLOT AREA AS PER SITE : 281.35 SQM
- PROPOSED AREA AT GROUND FLOOR : 134.40 SQM
- PROPOSED AREA AT FIRST FLOOR : 134.40 SQM
- TOTAL BUILD UP AREA : 268.80 SQM
- COVERED AREA : $\frac{134.40 \times 100}{281.35} = 47.77\%$

PROPOSED RESIDENTIAL BUILDING FOR
SMT - NIRMALA KULLU
W/O - LATE LINUS KULLU
KHATA NO - 236, PLOT NO - 3612,
RAKAWA - 7:00, DISMIL,
THANA NO - 80,
MOHALLA - DIFTY TOLI
MALUA - GOTRA
DISTT - SIMDEGA (JHARKHAND)
RAJ CONSULTANCY
CLUB COMPLEX, DANBAR MARIAN
MAIN ROAD SIMDEGA, JHARKHAND
MOBILE - 9811124125, 9938623233

SCALE - 1:100	SL.NO.	
AS MENTIONED	1/1	N

SIGNATURE OF I/C ENGINEER
SANGAM PANDHARIBORDE

DATE: _____

FRONT ELEVATION
SCALE 1:100

RIGHT SIDE ELEVATION
SCALE 1:100

LOCATION PLAN
NOT TO SCALE

GROUND FLOOR PLAN
SCALE 1:100

FIRST FLOOR PLAN
SCALE 1:100

TERRACE FLOOR PLAN
SCALE 1:100

PRODUCED BY AN AUTODESK EDUCATIONAL PRODUCT

Sl. No.	Particulars	Quantity	Unit	Rate	Amount
1.
2.
3.
4.
5.
6.
7.
8.
9.
10.
11.
12.
13.
14.
15.
16.
17.
18.
19.
20.
21.
22.
23.
24.
25.
26.
27.
28.
29.
30.
31.
32.
33.
34.
35.
36.
37.
38.
39.
40.
41.
42.
43.
44.
45.
46.
47.
48.
49.
50.
51.
52.
53.
54.
55.
56.
57.
58.
59.
60.
61.
62.
63.
64.
65.
66.
67.
68.
69.
70.
71.
72.
73.
74.
75.
76.
77.
78.
79.
80.
81.
82.
83.
84.
85.
86.
87.
88.
89.
90.
91.
92.
93.
94.
95.
96.
97.
98.
99.
100.

COLOR INDEX

Sl. No.	Color Name	Color Code
1.	White	W
2.	Red	R
3.	Blue	B
4.	Green	G
5.	Yellow	Y
6.	Pink	P
7.	Black	Blk
8.	Grey	Gr
9.	Brown	Brn
10.	Orange	O
11.	Purple	Pur
12.	Cyan	C
13.	Magenta	M
14.	Dark Blue	DB
15.	Dark Green	DG
16.	Dark Red	DR
17.	Dark Yellow	DY
18.	Dark Purple	DP
19.	Dark Cyan	DC
20.	Dark Magenta	DM
21.	Dark Grey	DGR
22.	Dark Brown	DBR
23.	Dark Orange	DO
24.	Dark Purple	DP
25.	Dark Cyan	DC
26.	Dark Magenta	DM
27.	Dark Grey	DGR
28.	Dark Brown	DBR
29.	Dark Orange	DO
30.	Dark Purple	DP
31.	Dark Cyan	DC
32.	Dark Magenta	DM
33.	Dark Grey	DGR
34.	Dark Brown	DBR
35.	Dark Orange	DO
36.	Dark Purple	DP
37.	Dark Cyan	DC
38.	Dark Magenta	DM
39.	Dark Grey	DGR
40.	Dark Brown	DBR
41.	Dark Orange	DO
42.	Dark Purple	DP
43.	Dark Cyan	DC
44.	Dark Magenta	DM
45.	Dark Grey	DGR
46.	Dark Brown	DBR
47.	Dark Orange	DO
48.	Dark Purple	DP
49.	Dark Cyan	DC
50.	Dark Magenta	DM
51.	Dark Grey	DGR
52.	Dark Brown	DBR
53.	Dark Orange	DO
54.	Dark Purple	DP
55.	Dark Cyan	DC
56.	Dark Magenta	DM
57.	Dark Grey	DGR
58.	Dark Brown	DBR
59.	Dark Orange	DO
60.	Dark Purple	DP
61.	Dark Cyan	DC
62.	Dark Magenta	DM
63.	Dark Grey	DGR
64.	Dark Brown	DBR
65.	Dark Orange	DO
66.	Dark Purple	DP
67.	Dark Cyan	DC
68.	Dark Magenta	DM
69.	Dark Grey	DGR
70.	Dark Brown	DBR
71.	Dark Orange	DO
72.	Dark Purple	DP
73.	Dark Cyan	DC
74.	Dark Magenta	DM
75.	Dark Grey	DGR
76.	Dark Brown	DBR
77.	Dark Orange	DO
78.	Dark Purple	DP
79.	Dark Cyan	DC
80.	Dark Magenta	DM
81.	Dark Grey	DGR
82.	Dark Brown	DBR
83.	Dark Orange	DO
84.	Dark Purple	DP
85.	Dark Cyan	DC
86.	Dark Magenta	DM
87.	Dark Grey	DGR
88.	Dark Brown	DBR
89.	Dark Orange	DO
90.	Dark Purple	DP
91.	Dark Cyan	DC
92.	Dark Magenta	DM
93.	Dark Grey	DGR
94.	Dark Brown	DBR
95.	Dark Orange	DO
96.	Dark Purple	DP
97.	Dark Cyan	DC
98.	Dark Magenta	DM
99.	Dark Grey	DGR
100.	Dark Brown	DBR

SCHEDULE OF OPENINGS

SL.NO.	SIZE	DESCRIPTION
1.	D	1.07X2.13 Sal wood chauthai & Gambhar wood shutter
2.	D1	0.97X2.13 Sal wood chauthai & Gambhar wood shutter
3.	D2	0.76X2.13 Sal wood chauthai & Gambhar wood shutter
4.	W	1.52X1.52 Fully glazed window
5.	W1	1.22X1.22 Fully glazed window
7.	W2	0.90X1.22 Fully glazed window
8.	V	0.61X0.61 CELLING VANTILETOR

SCHEDULE OF AREA

- TOTAL PLOT AREA AS PER SITE : 281.35 SQM
- PROPOSED AREA AT GROUND FLOOR : 134.40 SQM
- PROPOSED AREA AT FIRST FLOOR : 134.40 SQM
- TOTAL BUILD UP AREA : 268.80 SQM
- COVERED AREA : $\frac{134.40 \times 100}{281.35} = 47.77\%$

PROPOSED RESIDENTIAL BUILDING FOR
SMT - NIRMALA KULLU
W/O - LATE LINUS KULLU
KHATA NO - 236, PLOT NO - 3612,
RAKAWA - 7:00, DISMIL,
THANA NO - 80,
MOHALLA - DIFTY TOLI
MALUA - GOTRA
DISTT - SIMDEGA (JHARKHAND)
RAJ CONSULTANCY
CLUB COMPLEX, DANBAR MARIAN
MAIN ROAD SIMDEGA, JHARKHAND
MOBILE - 9811124125, 9938623233

SCALE - 1:100	SL.NO.	
AS MENTIONED	1/1	N

SIGNATURE OF I/C ENGINEER
SANGAM PANDHARIBORDE

DATE: _____

Building A1 (RESIDENCE)

Sl. No.	Particulars	Quantity	Unit	Rate	Amount
1.
2.
3.
4.
5.
6.
7.
8.
9.
10.
11.
12.
13.
14.
15.
16.
17.
18.
19.
20.
21.
22.
23.
24.
25.
26.
27.
28.
29.
30.
31.
32.
33.
34.
35.					