

Project Title: ABRAHAM DANG

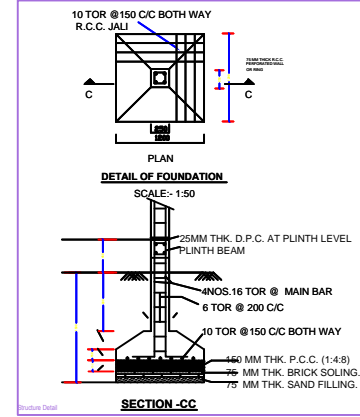
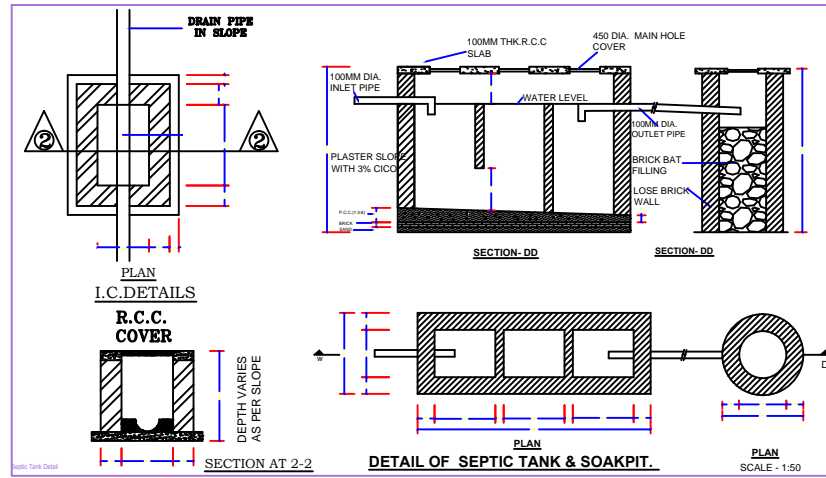

SPECIFICATIONS

- BRICKWORK IN FOUNDATION & PLINTH SHALL BE OF FIRST CLASS BRICK IN CEMENT MORTAR 1:5 AND HALF BRICK WILL BE 1:4 CEMENT MORTAR
- MASONRY FOUNDATION WITH ISOLATED R.C.C. COLUMN SHALL BE PROVIDED
- CURTAIN GLAZING/ STRUCTURAL GLAZING OF GOOD QUALITY AND MARK VENTILATOR SYSTEM SHALL BE USED
- ROLLING SHUTTER SHALL BE USED FOR SHOPS OPENINGS
- M.S. GLAZED/WOODZED ALUMINIUM/NCCL SECCOLOR WINDOW AND R.C.C. WITH CEMENT MORTAR 1:4
- ALL R.C.C. WORKS SHALL BE DONE IN 1:2:4 MIX CONCRETE COMMERCIAL QUALITY
- TATA TMT STEEL BARS SHALL BE USED IN R.C.C. STRUCTURES
- ALL MASONRY SURFACE SHALL BE PLASTERED WITH CEMENT MORTAR 1:5 OVER R.C.C. SLAB/ P.C.C.
- ALL STEEL AND WOOD WORK SHALL BE PAINTED WITH SYNTHETIC PAINT
- ALL SANITARY AND ELECTRICAL FITTINGS SHALL BE OF STANDARD MARK AND WORKMANSHIP
- KOTTA STONE / MOSAIC FLOORING INCLUDING STAIRCASE SHALL BE USED

SI.NO.	SIZE	DESCRIPTION
1.	D	Sal wood chauthat & Gamhar wood shutter
2.	D1	Sal wood chauthat & Gamhar wood shutter
3.	D2	Sal wood chauthat & Gamhar wood shutter
4.	W	Fully glazed window
5.	W1	Fully glazed window
7.	V	CELLING VANTILATOR

SCHEDULE OF AREA

1. TOTAL PLOT AREA AS PER SITE	: 404.67 SQM
2. PROPOSED AREA AT GROUND FLOOR	: 93.65 SQM
3. TOTAL BUILD UP AREA	: 93.65 SQM
4. COVERED AREA	: 93.65X100 = 404.67 = 23.14%

PROPOSED RESIDENTIAL BUILDING FOR
MR. - ABRAHAM DANG
 WO - LATE NATHNIEL DANG
 KHATA NO -107 , PLOT NO -698
 RAKWA - 10 DECIMAL.
 THANA NO - 116
 MOHALLA - GHOCHO TOLI
 MAUZA - SIMDEGA
 DIST. - SIMDEGA (JHARKHAND)

RAJ CONSULTANCY
 CLUB COMPLEX, GANDHI MAIDAN
 MAIN ROAD SIMDEGA, JHARKHAND
 MOBILE : 094311-93125, 093862-23833

SCALE - 1:100	SH.NO.	
AS MENTIONED	1/1	

SIGNATURE OF I.C. ENGINEER _____ SIGNATURE OF OWNER _____

