

REINFORCEMENT DETAILS OF TOP SLAB FOR SEPTIC TANK

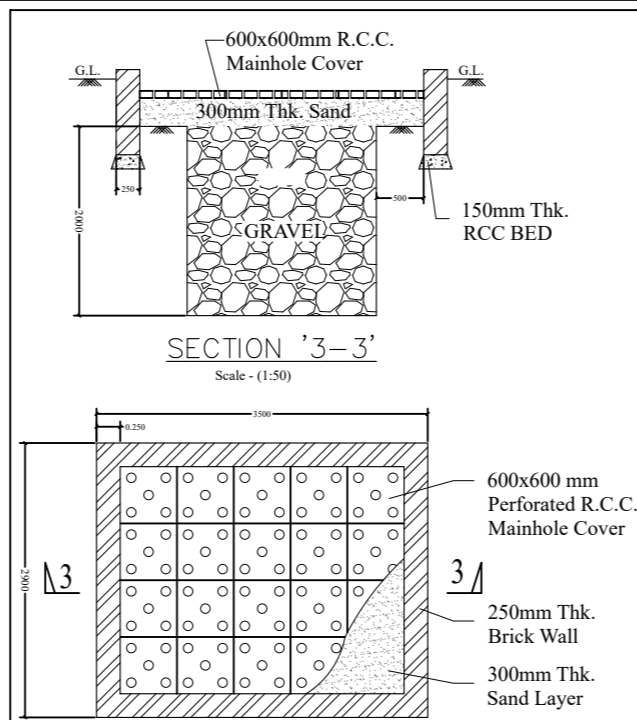

SECTION '3-3'
Scale - (1:50)

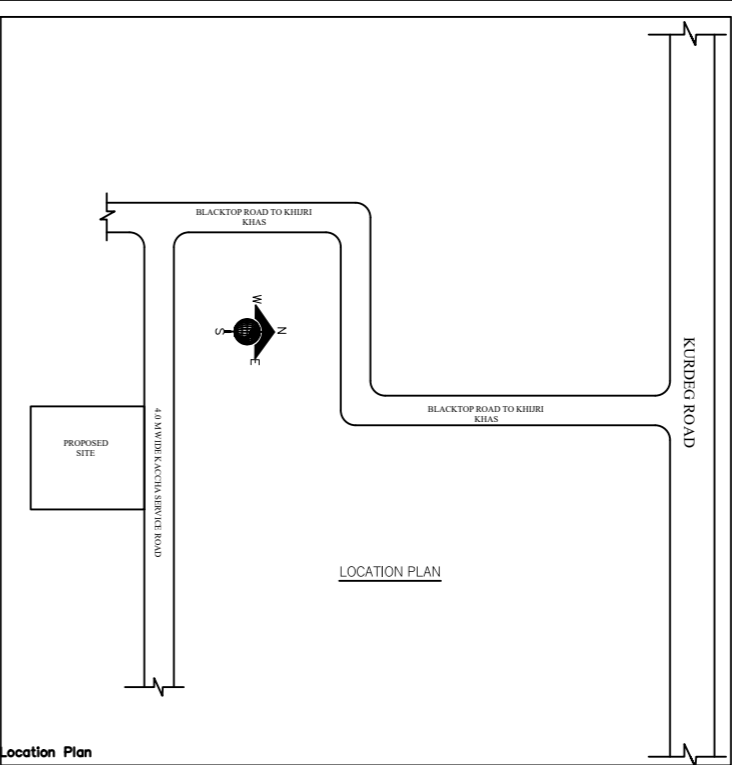

Location Plan

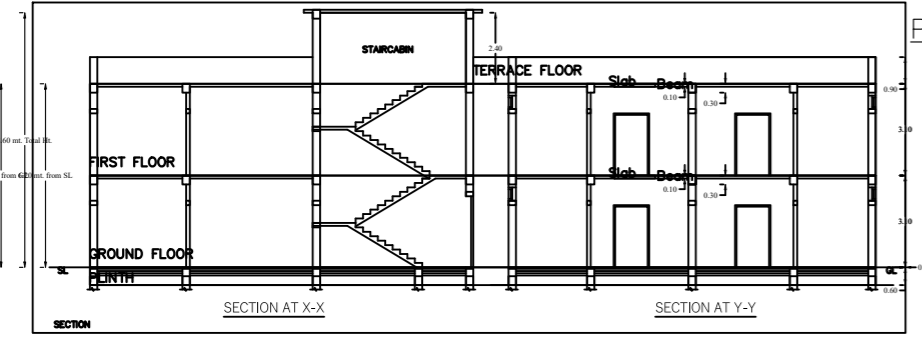

PLAN OF RAIN WATER RECHARGE PIT
Scale - (1:50)

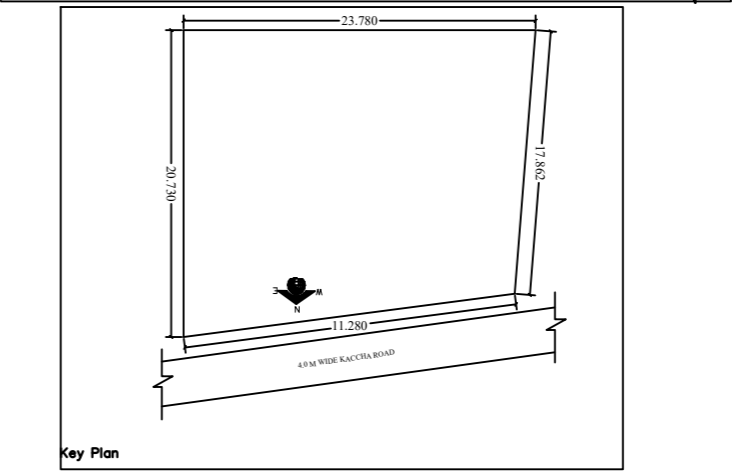

Key Plan

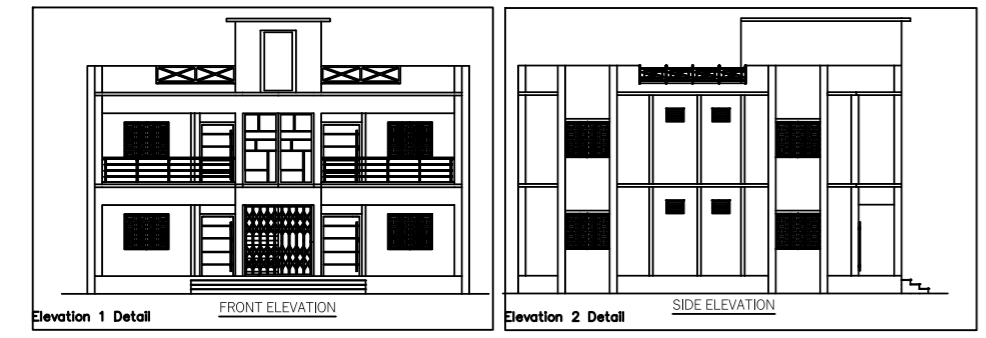

Elevation 1 Detail FRONT ELEVATION
Elevation 2 Detail SIDE ELEVATION

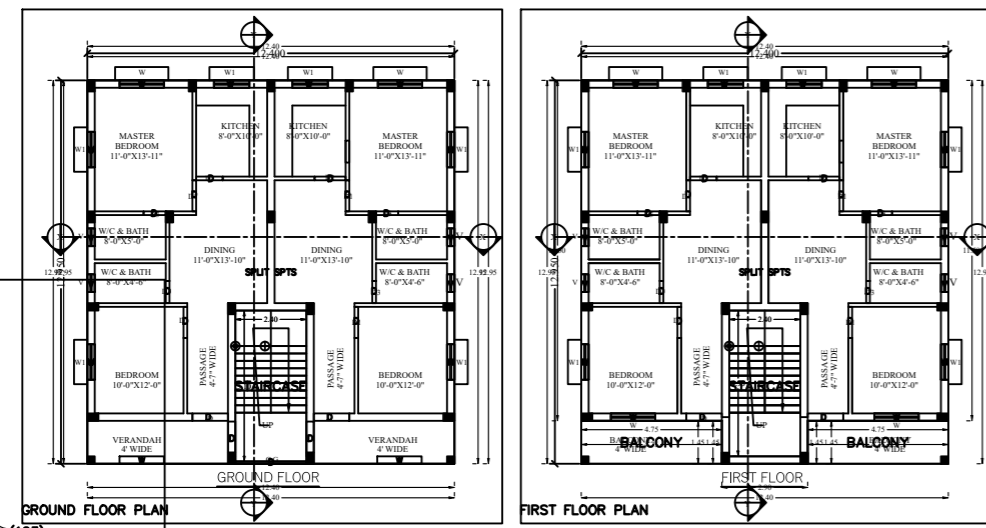

GROUND FLOOR PLAN
FIRST FLOOR PLAN

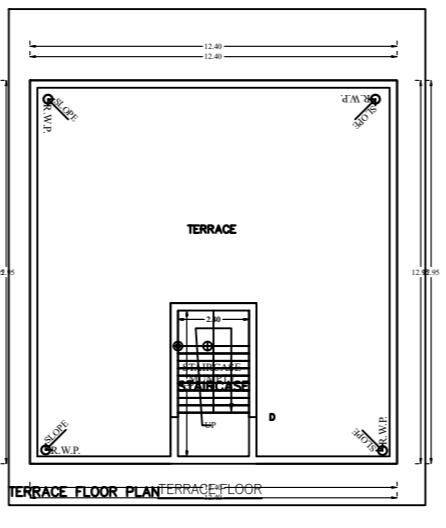

TERRACE FLOOR PLAN

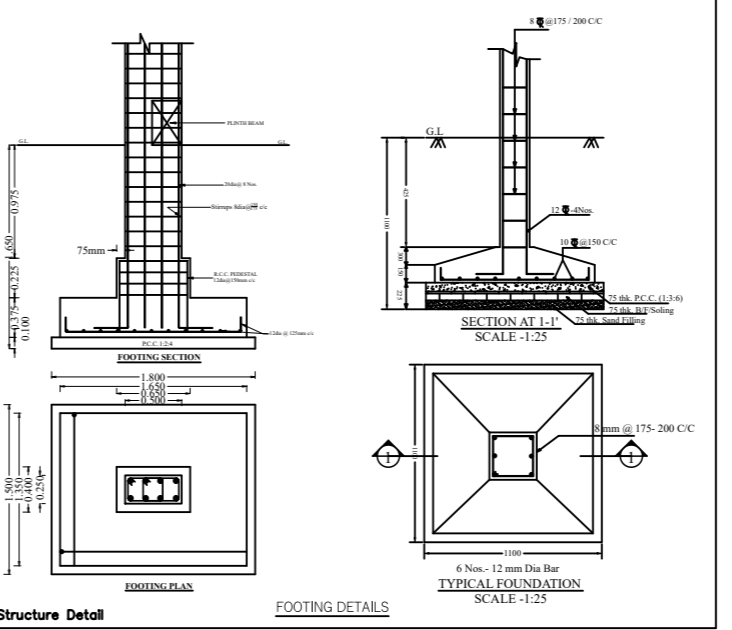

Structure Detail
FOOTING DETAILS

GENERAL NOTES - NOTES & REFERENCES

1. READ THIS DRAWING IN CONJUNCTION WITH RELEVANT ARCHITECTURAL DRAWINGS. ANY DISCREPANCY IF FOUND SHALL BE BROUGHT TO THE NOTICE OF CONSULTANT
2. ALL DIMENSIONS ARE IN MM & LEVELS IN MILLIMETERS.
3. DO NOT SCALE ANY DIMENSION.
4. CONFIRM LOCATION OF WALLS WITH RELEVANT ARCH. DRGS.
5. FOR RCC. WORK USE MIX M25 CONFORMING TO IS 456 : 2000 OR AS SPECIFIED IN RESPECTIVE DWG.
6. THE REINFORCEMENT SHALL BE COLD TWISTED DEFORMED BARS (C.T.D) OR T.M.T. BARS HAVING YIELD. STRENGTH NOT LESS THAN 500 N/mm² AND CONFORMING TO I.S. 1786 - 1979.
7. THE CLEAR COVER TO THE REINFORCEMENT SHALL BE AS FOLLOWS: -
 - (a) FOUNDATION: 60 MM surfaces in contact with earth
 - (b) COLUMNS : 40 MM
 - (c) BEAMS (top & bottom) : 25 mm side cover 25mm
 - (d) SLABS : 20 MM
 - (e) CHAJJAS/CANOPY : 20 MM
 - (f) R.C.C. WALL : 25 MM
8. NOMINAL COVER IS THE DEPTH OF CONCRETE COVER TO ALL STEEL REINFORCEMENT INCLUDING LINKS/ TIES/ STIRRUPS.
8. NOT MORE THAN 50% OF THE BARS SHALL BE LAPPED AT ANY SECTION. LAPS CLOSE TO THE MID SPAN IN BOTTOM BARS & CLOSE TO SUPPORTS IN TOP BARS SHALL BE AVOIDED.
9. - - - - - INDICATES TOP BARS
_ _ _ _ _ INDICATES BOTTOM BARS

DOORS, WINDOWS & VENT. SCHEDULE.

No.	ITEM	L	B	H	SILL
D		1.20		2.10	
D2		1.05		2.10	
D3		0.75		2.10	
W		1.50		1.20	0.90
W1		1.20		1.20	0.90
V		0.60		0.45	

R1	18-03-2023	SUBMISSION DRAWING
R0		FOR APPROVAL

rev.no. date revision

CLIENT-MR. SIKANDER TIRKEY S/O SHRI THEODORE TIRKEY, KHATA NO.-105, PLOT NO.-2063, MAUZA-KHIJRI, THANA NO.-105, ANCHAL-SIMDEGA, BLOCK-SIMDEGA, DIST-SIMDEGA.

PROJECT TITLE
PROPOSED RESIDENTIAL G+1 PROJECT FOR MR. SIKANDER TIRKEY, KHIJRI KHAS, KHIJRI, SIMDEGA.

DRAWING TITLE :	DWG NO.
SUBMISSION DRAWING	SD-45

SCALE	N.T.S
DATE	18-03-2023
DEALT	S.T.A

PROJECT NO.

CONSULTANT-

ARCHITECT ! ENGINEERS ! PROJECT CONSULTANTS
Office : 1st FLOOR, OPP. GULZAR GALLI, MAIN ROAD SIMDEGA, NEAR ANAND BHAVAN-835223.
TELEPHONE : +91-7070131170
E-mail : thecreation@gmail.com . ragbansu@gmail.com.

DRAWING RELEASED FOR:

APPROVAL SUBMISSION
 ADVANCE COPY CONSTRUCTION

ENGINEER'S SIGN OWNER'S SIGN