

Project title :PRAMILA TIRKEY

**SECTION AT 2-2**  
**DETAIL OF SEPTIC TANK & SOUP池**  
**PLAN SECTION CC**  
**KEY PLAN**  
**SCALE 1:100**  
**LOCATION PLAN**  
**SCALE 1:100**

**SPECIFICATIONS**

- 1 BRICKWORK IN FOUNDATION & PLINTH SHALL BE OF FIRST CLASS BRICK IN CEMENTMORTAR 1:8 AND HALF BRICK WILL BE 1:4 CEMENT MORTAR
- 2 MASONRY FOUNDATION WITH ISOLATED R.C.C COLUMN SHALL BE PROVIDED
- 3 CURTAIN WALLS STRUCTURAL GLAZING OF GOOD QUALITY AND MARK VENTILATOR SYSTEM SHALL BE USED
- 4 ROLLING SHUTTER SHALL BE USED FOR SHOP'S OPENINGS
- 5 IN CASE OF WINDOW ALUMINIUM WINDOW, SECTION WINDOW AND R.C.C WITH CEMENT MORTAR 1:4
- 6 ALL R.C.C WORKS SHALL BE DONE IN 1:2.4 MIX CONCRETE
- 7 DATA TMT STEEL BARS SHALL BE USED IN R.C.C STRUCTURES COMMERCIAL QUALITY
- 8 ALL MASONRY SURFACE SHALL BE PLASTERED WITH CEMENT MORTAR 1:4 OVER R.C.C SLAB / F.C.C
- 9 PLASTER AND WOOD WORK SHALL BE FINISHED WITH SYNTHETICAL PAINT
- 10 ALL SANITARY AND ELECTRICAL FITTINGS SHALL BE OF STANDARD MARKING WORKMANSHIP
- 11 FACTORY BUILT STAIRCASE FLOORING INCLUDING STAIRCASE SHALL BE USED

**SCHEDULE OF OPENINGS**

Sl. NO.	SIZE	DESCRIPTION
1.	D	1.00X2.13 Slr wood chakras & Gwalnar wood shutter
2.	D1	0.91X2.13 Slr wood chakras & Gwalnar wood shutter
3.	D2	0.79X2.13 Slr wood chakras & Gwalnar wood shutter
4.	W1	1.52X1.22 Fully glazed window
5.	W2	1.22X1.22 Fully glazed window
7.	V	0.61X0.61 CEILING VANTLOTER
7.	V1	1.22X3.96 Fully glazed ventlioter
8.	C-G	1.22X2.13 CHANNEL GATE

**SCHEDULE OF AREA**

- 1. TOTAL PLOT AREA AS PER SITE : 605.82 SQM
- 2. PROPOSED AREA AT GROUND FLOOR : 107.18 SQM
- 3. PROPOSED AREA AT FIRST FLOOR : 107.18 SQM
- 3. TOTAL BUILD UP AREA : 214.36 SQM
- 4. COVERED AREA : 107.18 SQM
- = 17.69%

**PROPOSED RESIDENTIAL BUILDING FOR**  
**SRI- PARMILA TIRKEY**  
**W/O -VINOD KUMAR TIRKEY**  
**KHATA NO -56, PLOT NO -2544**  
**RAKWA - 15 DECIMAL.**  
**THANNA NO - 80**  
**MOHALLA - THAKUR TOLI**  
**MAUZA - GOTRA**  
**DISTT. - SIMDEGA (JHARKHAND)**

**RAJ CONSULTANCY**  
**CLUB COMPLEX, GANDHI MAIDAN**  
**MAIN ROAD SIMDEGA, JHARKHAND**  
**MOBILE - 9841149570/983632913**  
**SCALE - 1:100** **SILNO.**

AS MENTIONED	1/1	
SIGNATURE OF LIC. ENGINEER		SIGNATURE OF OWNER

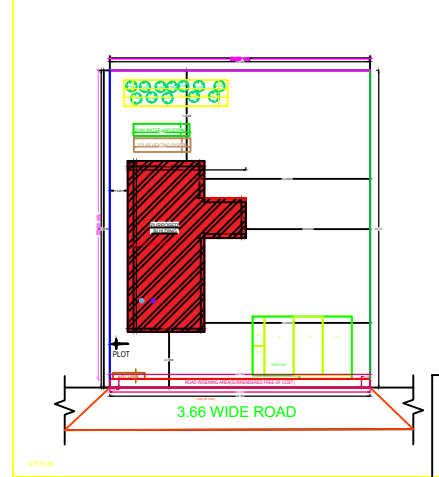

**Building A1 (RESIDENTIAL)**

Sl. No.	Particulars	Area (sqm)	Remarks
1	Ground Floor	107.18	
2	First Floor	107.18	
3	Total Build Up Area	214.36	
4	Covered Area	107.18	
5	Percentage of Covered Area	17.69%	

**COLOR KEY**

As per IS:1161	
As per IS:1161	
As per IS:1161	
As per IS:1161	

**PROVIDED**

Sl. No.	Particulars	Area (sqm)	Remarks
1	Ground Floor	107.18	
2	First Floor	107.18	
3	Total Build Up Area	214.36	
4	Covered Area	107.18	
5	Percentage of Covered Area	17.69%	