

Project Title - SRI PRATAP CHANDRA MISHRA

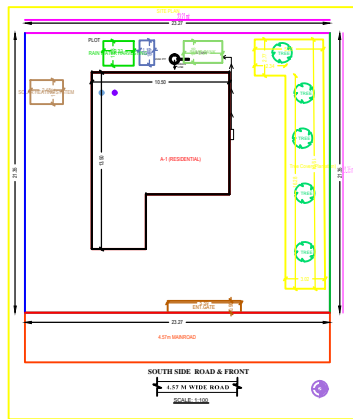

SCHEDULE OF AREA

Plot Area : 280.89 Sqm
 Built up Area of Ext. Ground Floor : 115.15 Sqm
 Built up Area of Proposed First Floor : 115.15 Sqm
 Garage for Parking : 0.00 Sqm

TOTAL BUILT UP AREA : 230.30 Sqm

Covered Area : 115.15 Sqm
 Gross Covered Area : 230.30 Sqm : 22.76%
 F.A.R. Achieved : 0.80

PROPOSED FIRST FLOOR RESIDENTIAL BUILDING FOR

SRI PRATAP CHANDRA MISHRA
 S/O - SANTOSH KUMAR MISHRA,
 AT TOWN - SERAKELLA,
 KHATA NO - 151, PLOT NO - 288,
 RAJWA, 12.5 ENCL. MULLA, WARD NO - 04(OLD 01)
 HOLDING NO. - 04000001000041
 THANA, SERAKELLA, THANA NO - 301
 DISTRICT - SERAKELLA KHARSAWAN,
 PUNJAB

SCALE: 1:100 AS MENTIONED IN DRAWINGS

Sl. No.	Particulars	Area (Sq. M)
1	Plot Area	280.89
2	Built up Area of Ext. Ground Floor	115.15
3	Built up Area of Proposed First Floor	115.15
4	Garage for Parking	0.00
5	Total Built up Area	230.30
6	Covered Area	115.15
7	Gross Covered Area	230.30
8	F.A.R. Achieved	0.80

PROPOSED FIRST FLOOR RESIDENTIAL BUILDING FOR

Sl. No.	Particulars	Area (Sq. M)
1	Plot Area	280.89
2	Built up Area of Ext. Ground Floor	115.15
3	Built up Area of Proposed First Floor	115.15
4	Garage for Parking	0.00
5	Total Built up Area	230.30
6	Covered Area	115.15
7	Gross Covered Area	230.30
8	F.A.R. Achieved	0.80

Schedule of Jobs

Sl. No.	Particulars	Area (Sq. M)
1	Plot Area	280.89
2	Built up Area of Ext. Ground Floor	115.15
3	Built up Area of Proposed First Floor	115.15
4	Garage for Parking	0.00
5	Total Built up Area	230.30
6	Covered Area	115.15
7	Gross Covered Area	230.30
8	F.A.R. Achieved	0.80

Signature and Stamp Section

Signature of Owner	Signature of Registered Consultant NAC Serakella
Signature of Engineer NAC Serakella	Signature of Executive Officer NAC Serakella