

SCHEDULE OF DOORS & WINDOWS :-				
SL. NO.	MKR.	SIZE	DESCRIPTION	
1	D	1.83M X 2.13M	Grill door.	
2	DI	1.07M X 2.13M	Panmelled single shutter door.	
3	DI	0.91M X 2.13M	Panmelled single shutter door.	
4	DI	0.76M X 2.13M	Panmelled single shutter door.	
5	W	1.52M X 1.22M	Glazed steel framed window 3. shut.	
6	W1	1.22M X 1.22M	Glazed steel framed window 3. shut.	
7	V	0.61M X 0.61M	Top hung steel ventilator.	

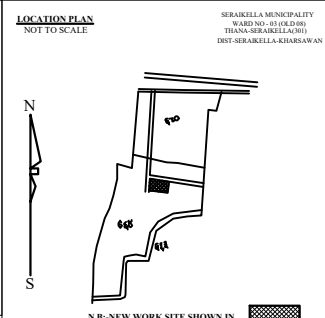
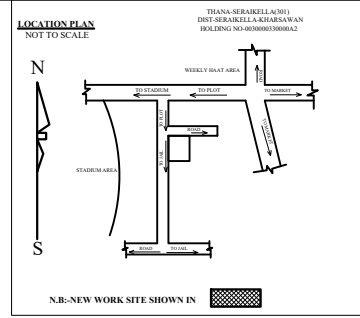

**GENERAL SPECIFICATIONS:**

**FOUNDATION :** R.C.C. work should be as per design. R.C.C. columns footing, columns & the beams as per design work should be as per design.

**SUPERSTRUCTURE :** R.C.C. columns, beams & roof slab as per design should be provided unless stated as per grade of concrete. Lighting & reinforcement should be provided in reinforcement. R.C.C. work of base slabs should be provided in reinforcement. Column marker for columns shall be (1/4) dia for (1/4) dia for 250mm wall. Casting must be done for proper period.

**INTERNAL FINISHING :** Work should be as per design. Plastering in kitchen & living. 1200 dia of base slabs should be provided in reinforcement. R.C.C. work of base slabs should be provided in reinforcement. Column marker for columns shall be (1/4) dia for (1/4) dia for 250mm wall. Casting must be done for proper period.

**DOORS & WINDOWS :** Work should be as per design. R.C.C. work of base slabs should be provided in reinforcement. Column marker for columns shall be (1/4) dia for (1/4) dia for 250mm wall. Casting must be done for proper period.

**ELECTRIFICATION :** Work should be as per design. R.C.C. work of base slabs should be provided in reinforcement. Column marker for columns shall be (1/4) dia for (1/4) dia for 250mm wall. Casting must be done for proper period.

**SCHEDULE OF AREA**

SCALE : 1:100 AS MENTIONED IN DRAWINGS

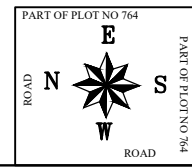
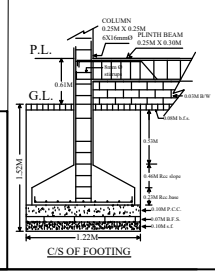
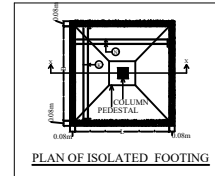

SIGNATURE OF OWNER

SIGNATURE OF REGISTERED CONSULTANT NAC SERAIKELLA

SIGNATURE OF ENGINEER NAC SERAIKELLA

SIGNATURE OF EXECUTIVE OFFICER NAC SERAIKELLA