

1/6 INCH = 1 MILE.

### PROPOSED PLAN FOR LAND SOLD

SOLD AREA SHOWN BY RED COLOUR.

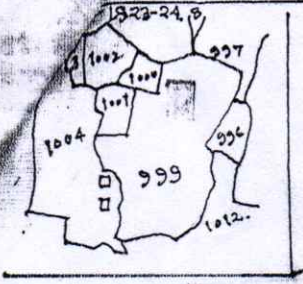

VILLAGE - KODARMA.  
 P.S. - KODARMA. No-333.  
 DIST. - KODARMA.  
 SCALE - 1 INCH = 32 FEET.

KHEWAT NO. - 88.  
 KHATA NO. - 631.  
 PART OF PLOT NO. - 999  
 SOLD AREA - 08.00 DECIM

YENDER: - SUJA UDDIN AHMAD.  
 S/O LATE QUAMARUDDIN.  
 AT- JAL WABAD.  
 KODARMA.

YENDEE: - ZEENAT PARWEEN.  
 W/O MD. REYAZ UDDIN.  
 JAL WA BAD.  
 KODARMA.

PERSENT BOUNDARY:  
 N. - KASHIM MINYA.  
 S. - NIJ-YENDER. P.H.  
 E. - RESTLAND OF P.H.  
 W. - ROAD. 12'-0".

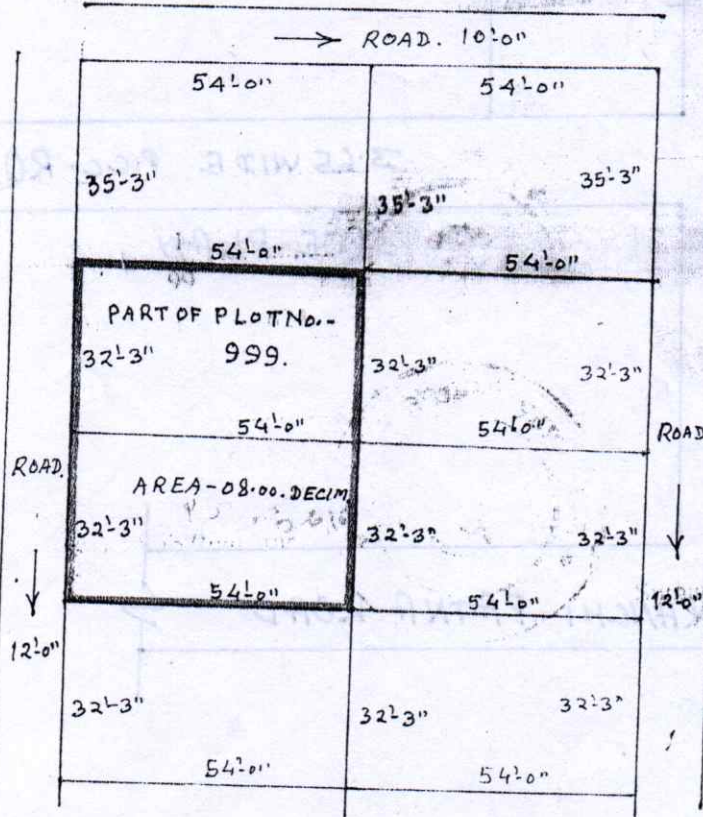

SIGNATURE OF YENDEE

THIS MAP IS EXACT TRUE COPY OF ORIGINAL

زینت پریوین