

Seller :- Sri Birendra Nath Pradhan s/o Sri Kartik Chandra Pradhan of Zonal Training E.C. Railway, Bhuli, P.S. Bhuli Dist. Dhanbad.

Purchaser :- (1) Smt. Reena Chaurasia w/o Sri Dinesh Kumar Chaurasia, (2) Sri Dinesh Kumar Chaurasia s/o Sri Chandrika Prasad Chaurasia, of P.S. Harnaut, Dist. Nalanda (Bihar) At pre- Qtr no. B-52, Jagjivan Nagar, P.S. Saraidhela Dist. Dhanbad.

Schedule :- Mouza, Saraidhela no. 8, P.S. Saraidhela, Khata No. 19, Plot No. 157. (Part) Area.  $2\frac{1}{2}$  Kathas. or 4.12-Decimals of Land in ward no. 22. Shown in colour red.

Boundary :- North :- Part of this plot.  
South :- 10' wide Rasta.  
East :- Damru Mahata.  
West :- Bihari Sinha.

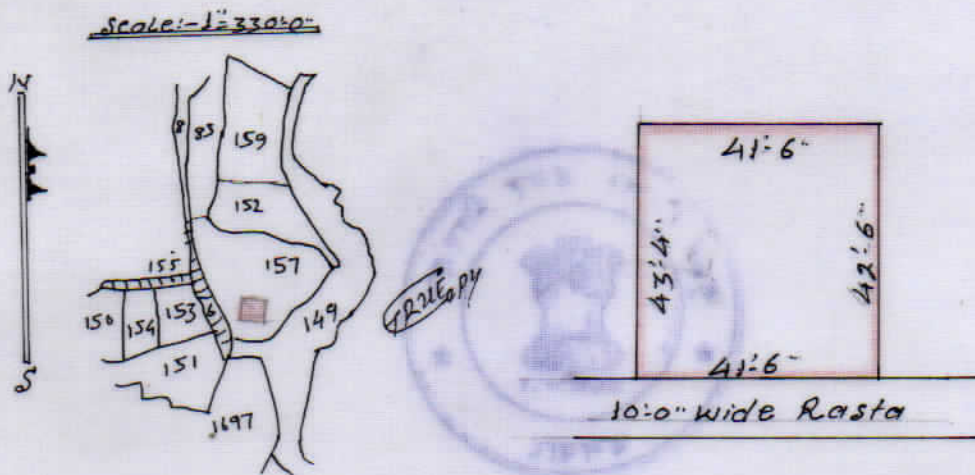

Birendra Nath Pradhan  
19-10-15

manoj

