

**BRIEF SPECIFICATION**

**FOUNDATION** : 6" th. P.C.C. (1:1½:3) foundation bed & first class brick work in cement mortar (1:6) in foundation.

**PLINTH** : 1½" th. D.P.C. (1:1½:3) all round on the plinth level.

**FLOORING** : 1½" th. I.P.S. / Marble flooring over 3" th. P.C.C. (1:3:6).

**SUPERSTRUCTURE** : First class brick work in cement mortar (1:6).

**SLAB, BEAM & LINTEL** : All R.C.C. works (1:1½:3).

**WOOD WORKS** : All doors & windows frames of sal wood.

**PLASTERING** : ½" th. cement plaster (1:6) in both side.

**STAIR CASE** : RISE - 6", TREAD - 10"

**SCHEDULE**

D	-	3'-6" X 7'-0"	W	-	5'-0" X 4'-0"
D1	-	3'-0" X 7'-0"	W1	-	4'-0" X 4'-0"
D2	-	2'-6" X 7'-0"	W2	-	3'-0" X 4'-0"
			V	-	2'-0" X 2'-0"

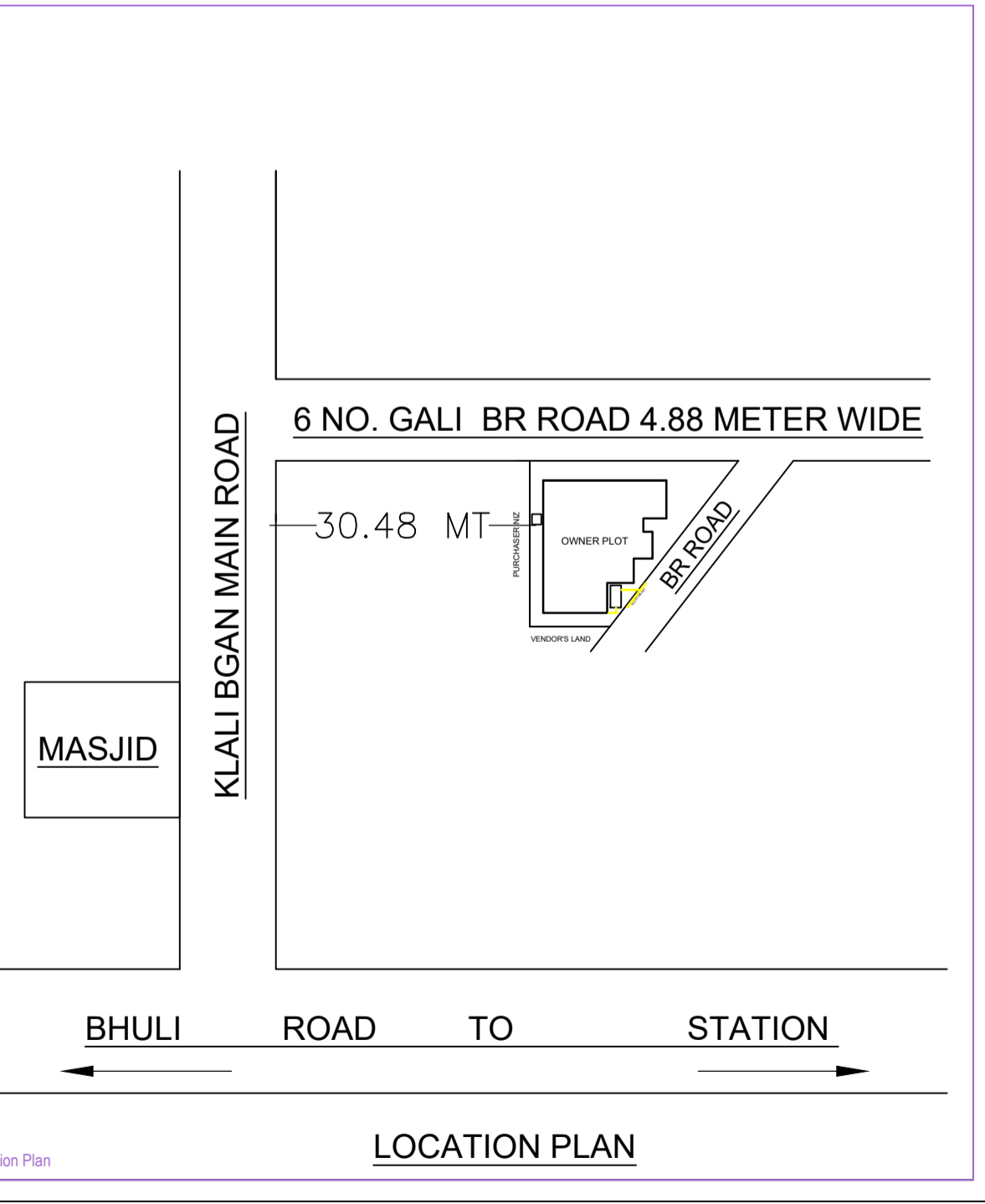
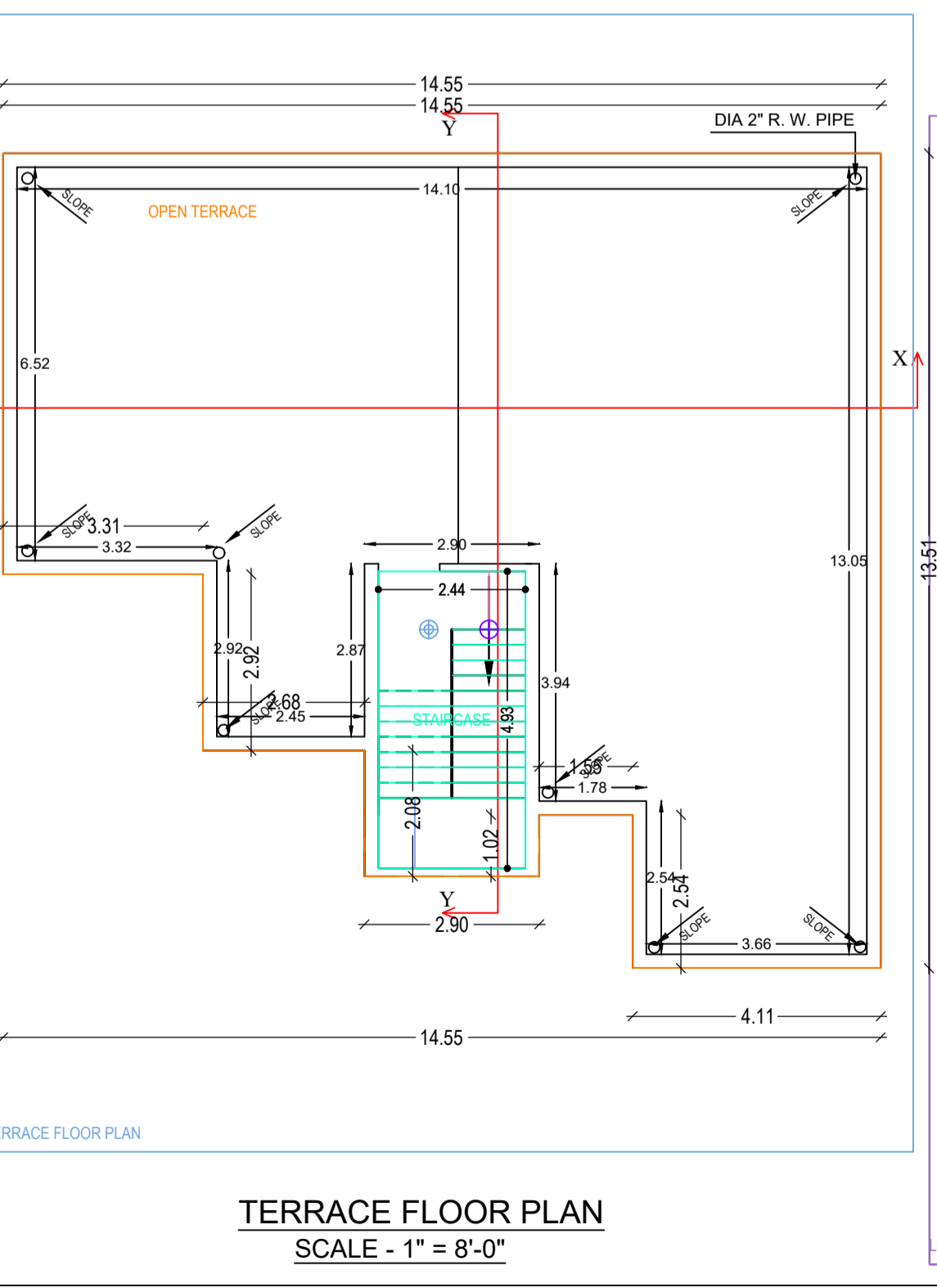
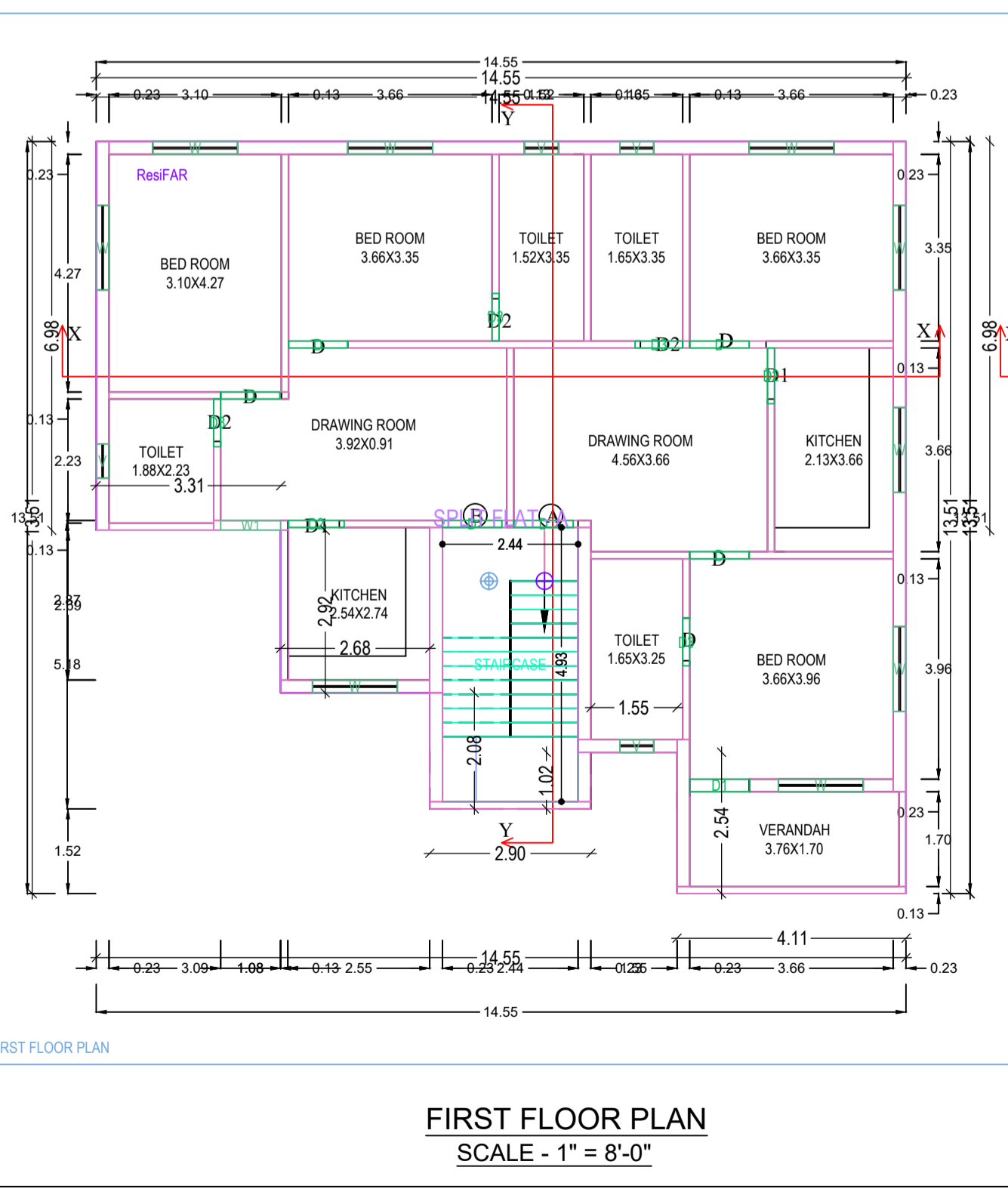
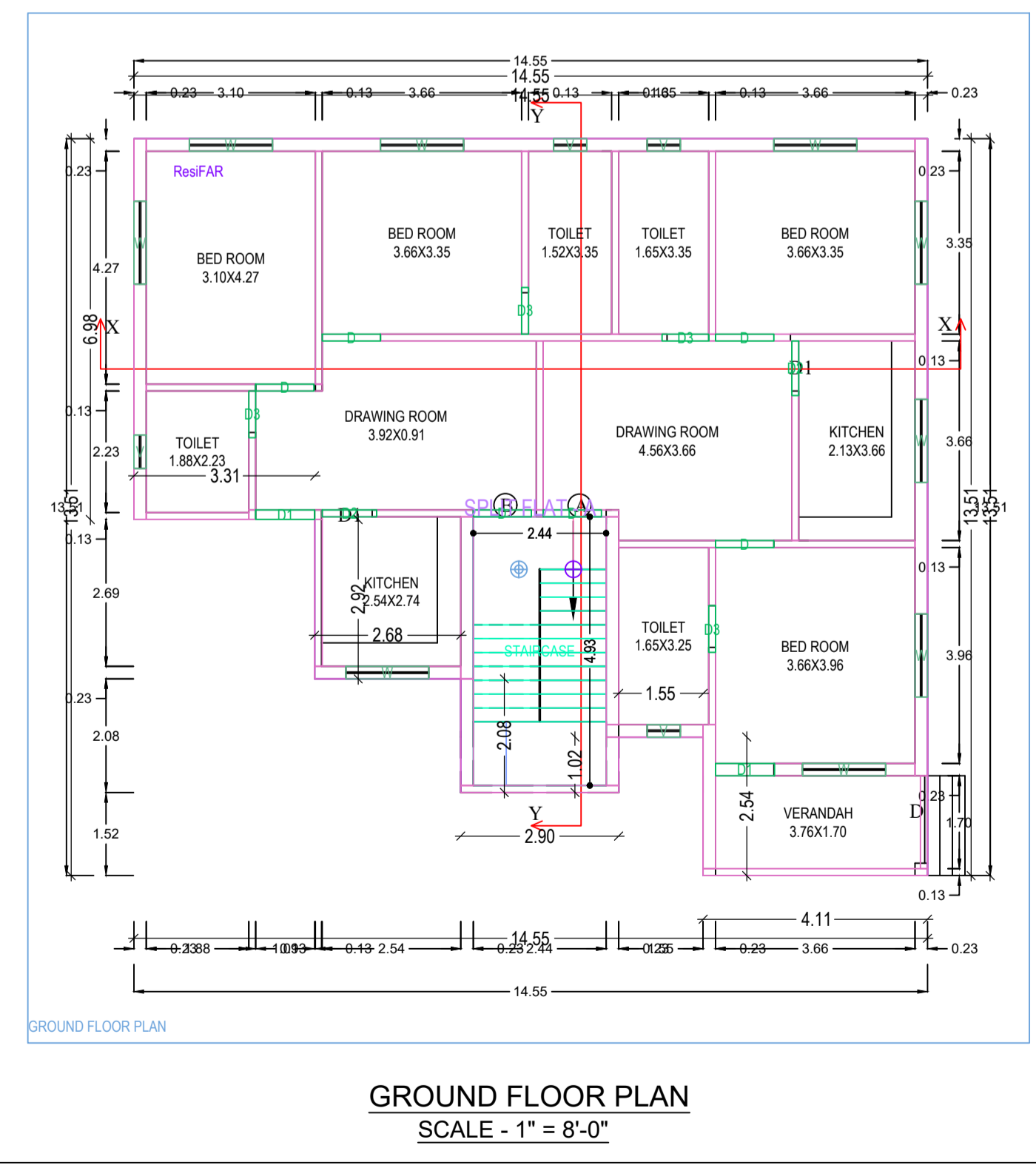

**DETAILS OF AREA**

**LAND AREA** : 307.03 Sq.mtr. (AS PER DEED)  
291.25 Sq.mtr. (AVAILABLE)

**GROUND FLOOR AREA** : 156.94 Sq.mtr.

**FIRST FLOOR AREA** : 156.94 Sq.mtr.

**COVERED AREA** : 313.88 Sq.mtr.

**F.A.R** : 1.08

**% OF PLINTH AREA** : 53.88 %

**TITLE OF DRAWING**

PLAN FOR PROPOSED RESIDENTIAL BUILDING DRAWING OF SHADAN PARVEEN W/O ALAM HUSSAIN OF BHISTI PARA HIRAPUR DHANBAD. UNDER MOUZA - PANDAR PALA, NO. - 4, KHATA NO. 71 PLOT NOS. - 2148 ( P ) .DIST. - DHANBAD. JHARKHAND .

SIG. OF OWNER	SIG. OF ENGINEER
---------------	------------------