

Seller Sri Subra Chatterjee s/o Late Mahadeo Chatterjee of
Or No 1/178/515 Barmasia, Railway Colony Ranchad

Purchaser Tula Devi w/o Sri Anan Kumar Daswan of 42 out House
A officers Colony Ranchad Ranchad

Schedule Madia: Ranchad No. 47 Photo No. 105
Plot No. 108 Area: 2712 sq ft or to say 6.21 Decimals
or to say 3-76 Kathas

Boundary North: Radha Devi
South: Tripti Datta
East: Nali
West: P.C.C. Rasta

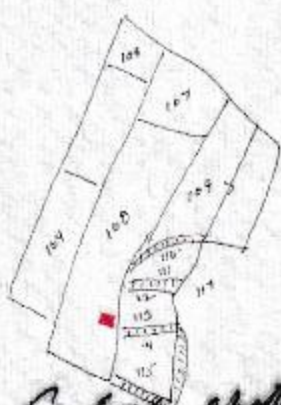

Subra Chatterjee

Sri Tula Devi

22/09/18

Handwritten signature/initials

