

SELLER --SRI VIVEKANAND UPADHYAY, S/O -- LATE PADAM NATH UPADHYAY, RESIDENCE OF C. M. P. F. COLLONEY, P/S -- SARAIDHELA, DIST -- DHANBAD, STATE -- JHARKHAND .

PURCHASER --SMT PUJA KUMARI, W/O -- SRI ARBIND KUMAR THAKUR, RESIDENCE OF JAGLAL KIRANA STORE, NEAR SARKARI KUWA, MANAITAND, P/S -- DHANSAR, DIST -- DHANBAD, STATE -- JHARKHAND .

SCHEDULE -- MOUZA -- KOLAKUSMA, MOUZA NO -- 12, P/S -- SARAIDHELA, DISTRICT -- DHANBAD, STATE -- JHARKHAND, KHATA NO -- 76, (NEW KHATA NO -- 91), PLOT NO -- 56 (PART), (NEW PLOT NO -- 53), AREA -- 1 (ONE) KATHA 8 (EIGHT) CHATAK 36 (THIRTY SIX) SqFeet, OR 1116 SqFeet .

BOUNDARY

NORTH -- SMT RENU KUMARI .

SOUTH --15'0" WIDE PROPOSED ROAD .

EAST --SMT POONAM DEVI .

WEST --SRI DHARMENDRA THAKUR .

KEY PLAN  
SCALE 1" = 330' 0"



Land shown in red colour

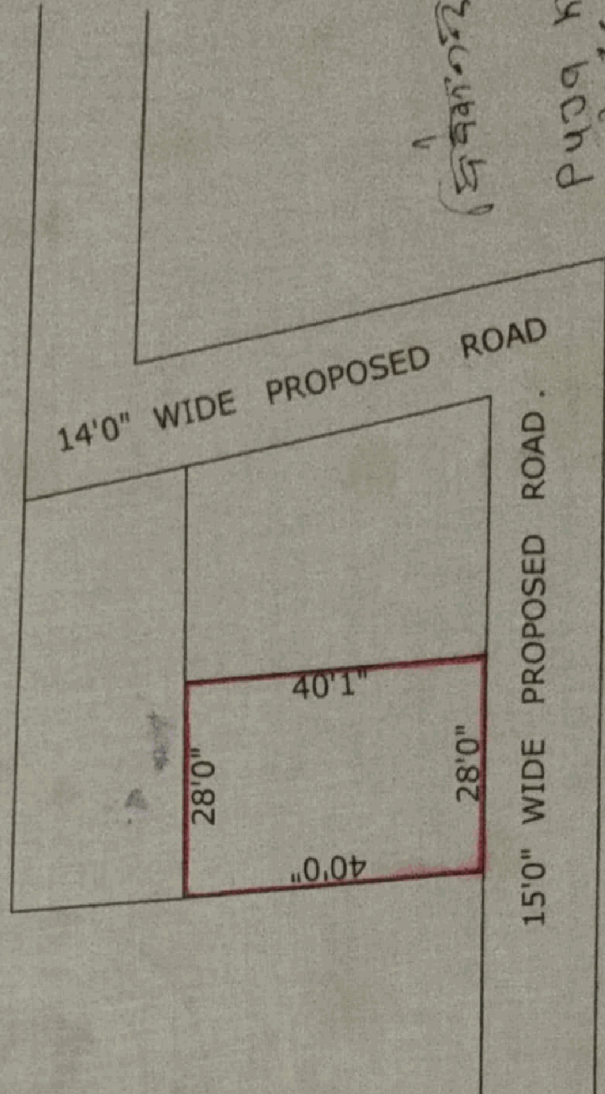

Andeep Mondal (P.N.I.)

NOT IN SCALE