

SELLER -- SRI RAMAN SINGH, S/O -- LATE BAD MATH SINGH, RESIDENCE OF SHIVAM COLONY, POST -- K. G. ASHRAM,
 P/S -- SARAIDHOLA, DIST -- DHANBAD, STATE -- JHARKHAND
 PURCHASER -- SMT KOUSHLIYA DEVI, W/O -- SRI HALDHAR DA, RESIDENCE OF VILL -- TLABANI, POST -- BARDOHI, P/S --
 GOBINDPUR, DIST -- DHANBAD, STATE -- JHARKHAND
 SCHEDULE -- MOUZA -- KOLAKUSMA, MOUZA NO -- 12, P/S -- SARAIDHOLA, DISTRICT -- DHANBAD, STATE -- JHARKHAND,
 NEW KHATA NO -- 552, OLD KHATA NO -- 131, NEW PLOT NO -- 4035/4910, OLD PLOT NO -- 3329 (PART), AREA --
 5 (FIVE) KATHA OR 3600 Sqfeet.

BOUNDARY
 NORTH -- 12'0" WIDE PROPOSED ROAD
 SOUTH -- 10'0" WIDE PROPOSED ROAD
 EAST -- SRI N. K. RAJAK
 WEST -- SRI RAMA SHANKAR SINGH

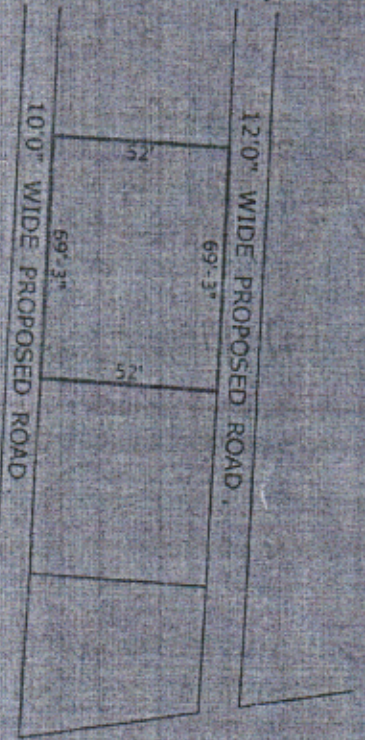
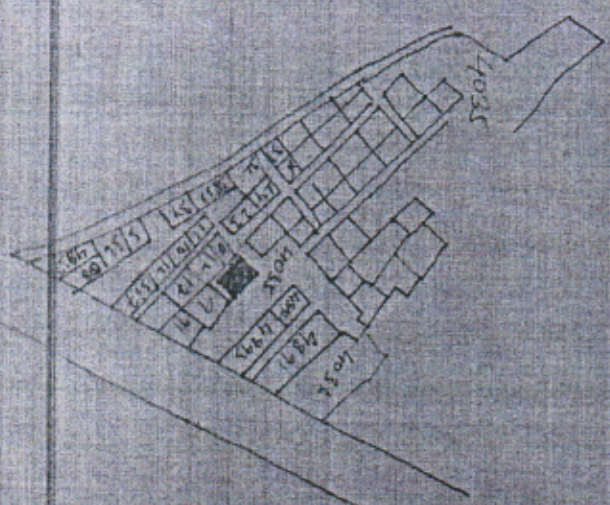

Raman Singh
 19/05/19

MAP IN SCALE