

Project Title :kuldeep singh

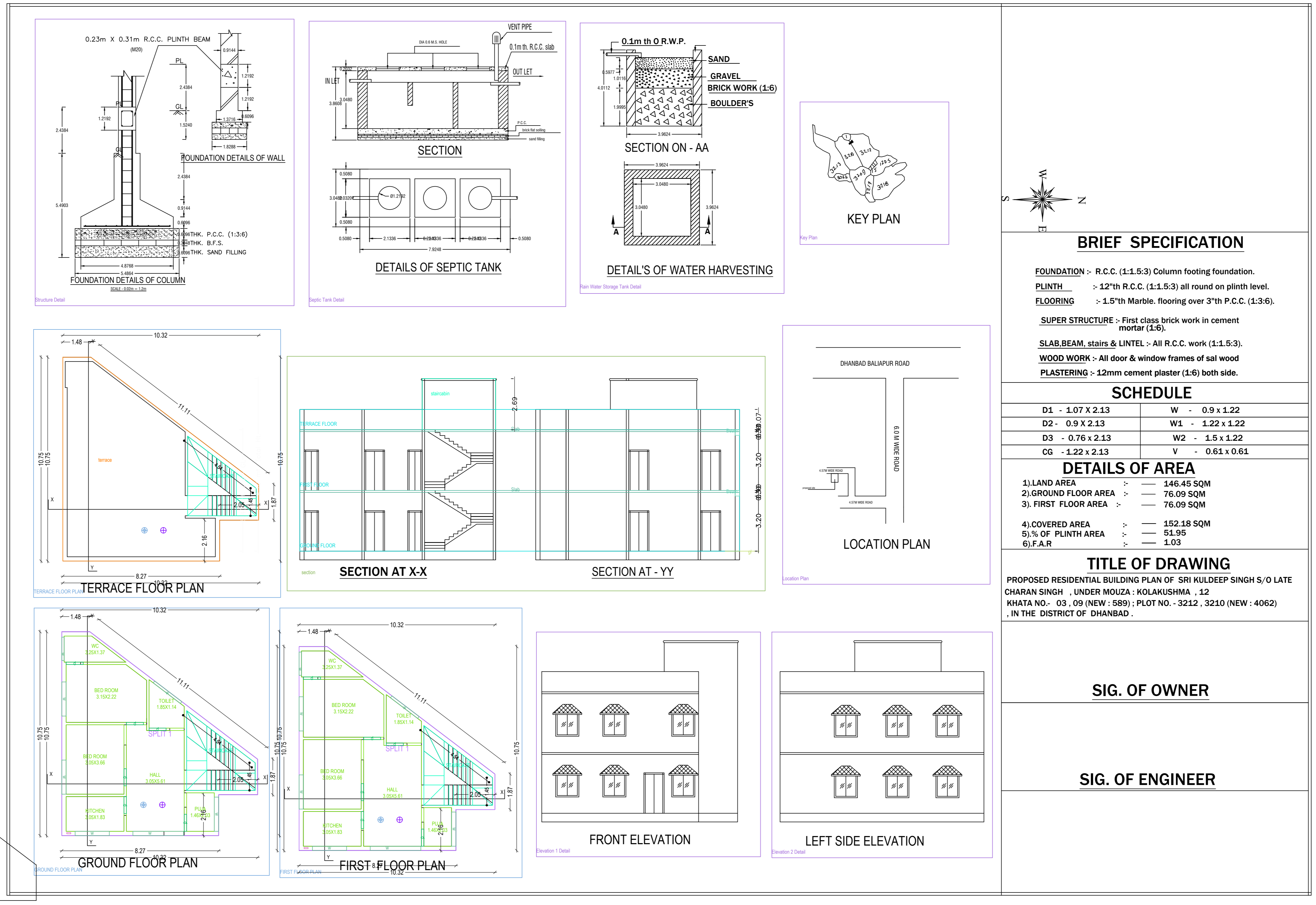

AREA STATEMENT: DHANBAD MUNICIPAL CORPORATION	VERSION NO. 1.0.17
PROJECT DETAIL:	VERSION DATE: 01/01/2019
Toward No.:	PLOT No. Residential
Region: JHARKHAND URBAN LOCAL BODIES	PLOT No. Residential Building/ Dwelling / Non Apartment
DISTRICT: DHANBAD	LAND USE CODE: Residential
Application Type: General Proposal	Abutting Road Width:
Project Type: Building Permission	Plot No.:
Nature of Development: New	Reference Survey No./Survey No.:
Location: Old Area	Thana No.:
Sub Location: N/A	Holding No.:
Village/Moza Name:	Khata No.:
Ward No.:	North:
Road/Street:	South:
	East:
	West:

AREA DETAILS:	AREA	SQ. MT.
NET Plt Area (Gross Plt Area - Deduction from Gross Plt Area)	(A)	145.93
Deductions for Balance Plt Area (from Gross Plt Area)	(A-Deductions)	145.93
COF Area		18.67
Total		18.67
Minimum Plt Area (Net Plt Area - Recreational/Amenity space)	(A-Deductions)	127.26
Plt Area for Coverage (Net Plt Area - Road/Roadway Area)	(A-Deductions)	145.93
COVERAGE CHECK		
Proposed Coverage Area (52.54%)		76.81
Total Coverage Area (52.54%)		76.81
Proposed Area of FAR		153.62
Total Area of FAR		153.62
BUILT UP AREA CHECK		
Total Proposed Built Up Area		153.62
ARCHITECT SUPERVISOR (Regd.)	OWNER	153.62
DEVELOPMENT AUTHORITY	LOCAL BODY	

COLOR INDEX	
PLT BOUNDARY	█
ABUTTING ROAD	█
PROPOSED WORK (COVERAGE AREA)	█
EXISTING (To be retained)	█
EXISTING (To be demolished)	█

Color Index:  
FAR & Tenement Details (Table 4c-1)

Building	No. of Same Bldg	Total Built Up Area (Sq.mt.)	Proposed FAR Area (Sq.mt.)	Total FAR Area (Sq.mt.)	Tenement (No.)
A (A)	1	153.62	153.62	153.62	01
<b>Grand Total</b>	<b>1</b>	<b>153.62</b>	<b>153.62</b>	<b>153.62</b>	<b>01</b>

**BRIEF SPECIFICATION**

**FOUNDATION** :- R.C.C. (1:1.5:3) Column footing foundation.  
**PLINTH** :- 12"th R.C.C. (1:1.5:3) all round on plinth level.  
**FLOORING** :- 1.5"th Marble flooring over 3"th P.C.C. (1:3:6).  
**SUPER STRUCTURE** :- First class brick work in cement mortar (1:6).  
**SLAB,BEAM, stairs & LINTEL** :- All R.C.C. work (1:1.5:3).  
**WOOD WORK** :- All door & window frames of sal wood  
**PLASTERING** :- 12mm cement plaster (1:6) both side.

**SCHEDULE**

D1 - 1.07 X 2.13	W - 0.9 x 1.22
D2 - 0.9 X 2.13	W1 - 1.22 x 1.22
D3 - 0.76 X 2.13	W2 - 1.5 x 1.22
CG - 1.22 x 2.13	V - 0.61 x 0.61

**DETAILS OF AREA**

1) LAND AREA	>	146.45 SQM
2) GROUND FLOOR AREA	>	76.09 SQM
3) FIRST FLOOR AREA	>	76.09 SQM
4) COVERED AREA	>	152.18 SQM
5) % OF PLINTH AREA	>	51.95
6) F.A.R	>	1.03

**TITLE OF DRAWING**  
 PROPOSED RESIDENTIAL BUILDING PLAN OF SRI KULDEEP SINGH S/O LATE CHARAN SINGH UNDER MOUZA - KOLAKUSHIMA , 12 KHATA NO. - 03 , 09 (NEW : 589) ; PLOT NO. - 3212 , 3210 (NEW : 4062) , IN THE DISTRICT OF DHANBAD .

**SIG. OF OWNER**

**SIG. OF ENGINEER**

Building -A (A)

Floor Name	Total Built Up Area (Sq.mt.)	Proposed FAR Area (Sq.mt.)	Total FAR Area (Sq.mt.)	Tenement (No.)
Ground Floor	76.81	76.81	76.81	01
First Floor	76.81	76.81	76.81	01
Terrace Floor	0.00	0.00	0.00	00
<b>Total</b>	<b>153.62</b>	<b>153.62</b>	<b>153.62</b>	<b>01</b>
Total Number of Same Buildings	1			
<b>Total</b>	<b>153.62</b>	<b>153.62</b>	<b>153.62</b>	<b>01</b>

SCHEDULE OF JOINERY:

BUILDING NAME	NAME	LENGTH	HEIGHT	NOS
A (A)	W	0.90	2.15	12
<b>Total</b>				<b>12</b>

SCHEDULE OF JOINERY:

BUILDING NAME	NAME	LENGTH	HEIGHT	NOS
A (A)	W	1.23	1.20	02
A (A)	W	1.80	1.20	12
A (A)	W	2.67	1.20	02
<b>Total</b>				<b>14</b>

UnBIA Table for Building -A (A)

FLOOR	Name	UnBIA Type	UnBIA Area	Carpet Area	No. of Rooms	No. of Tenement
GROUND FLOOR PLAN	SPLIT 1	FLAT	153.62	153.59	7	1
<b>Total</b>			<b>153.62</b>	<b>153.59</b>	<b>14</b>	<b>1</b>