

LOCATION PLAN

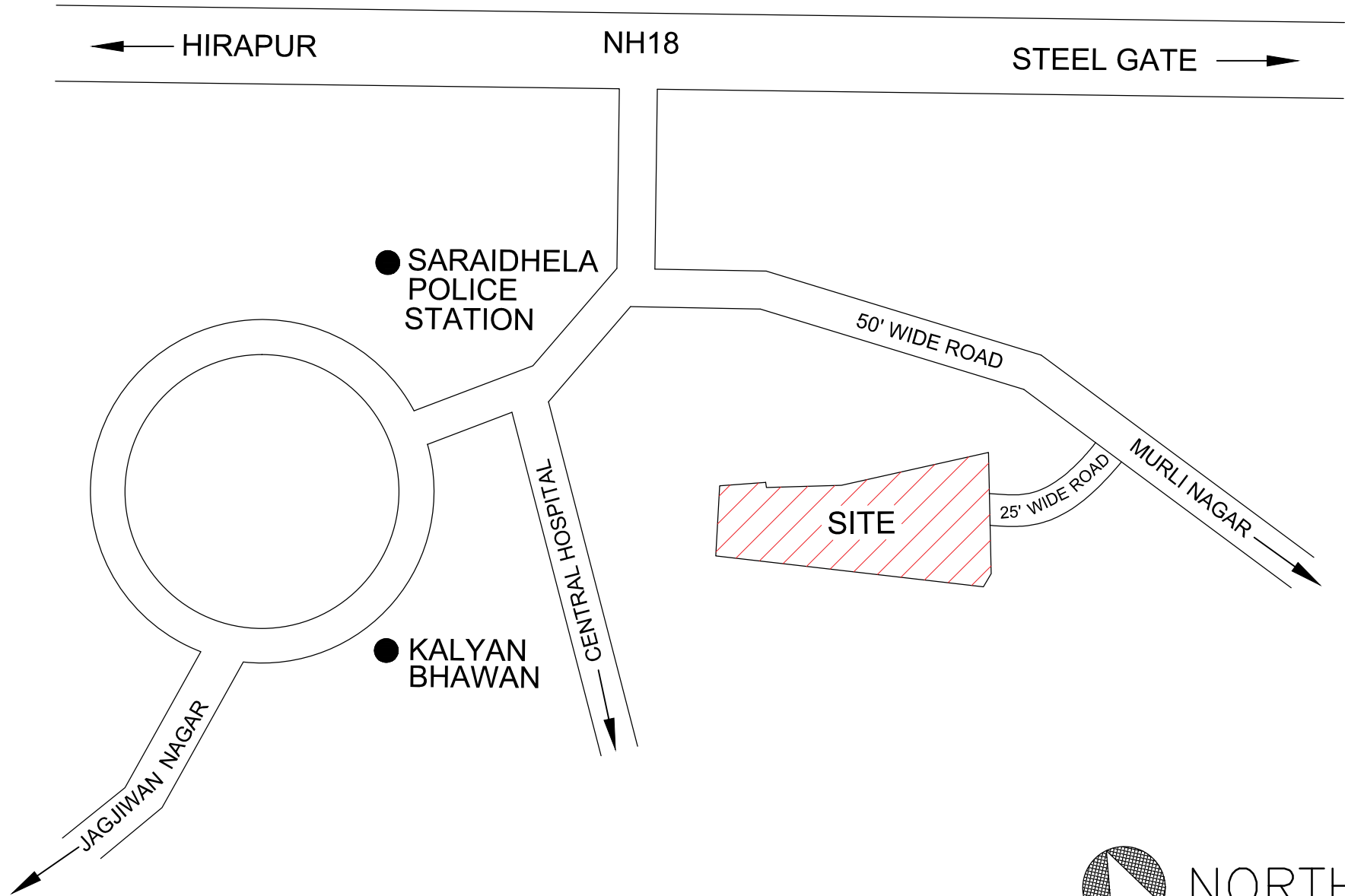

NOT TO SCALE

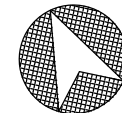

NORTH



SURVEY MAP

Seller:- Garib Ram Shaw s/o Kisto Shaw of Mandal Para Saraidhela. P.S. Saraidhela. Dist. Dhanbad.

Purchaser:- Mahesh Prasad s/o Srinath Mahato of Saraidhela. Mandal Para. Near Aditya Apartment, Dhanbad.

Schedule:- Mouza. Saraidhela. No. 8. P.S. Saraidhela. New Khata No. 163 Old Khata No. 77, New Plot No. 2180. Old Plot No. 3363 Area 1.65 Katha or 2.72-Deci.

Shown in red colour.

Boundary:- North:- Part of Plot No. 2180.

South:- New Plot No. 2183, Mahesh Prasad.

East:- New Plot No. 2179 & 2183, Mahesh Prasad.

West:- New Plot No. 2181 & 2177.



TRUE PY.

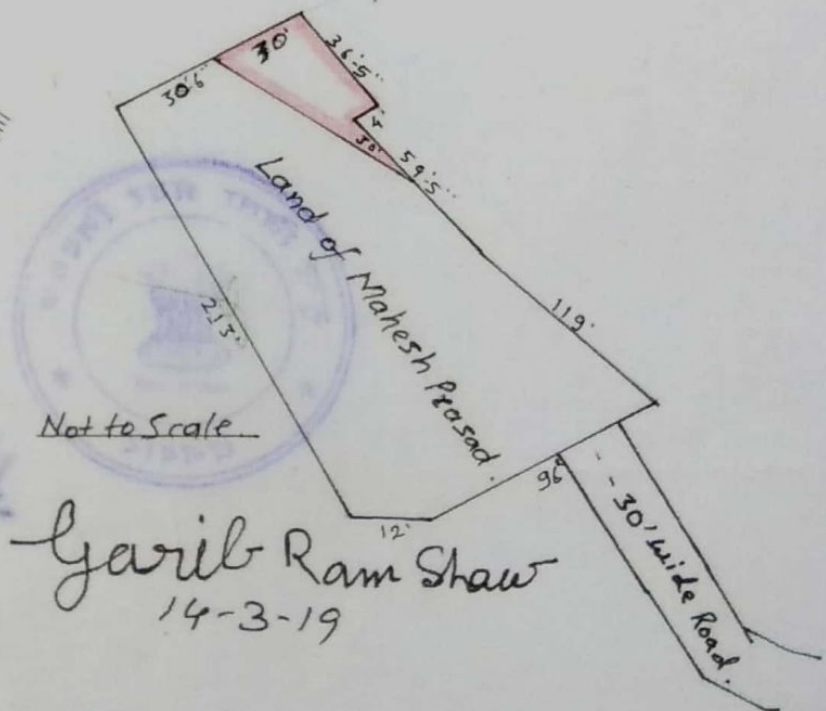
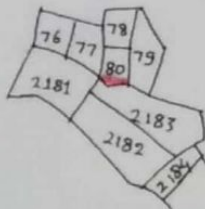

Not to Scale

Garib Ram Shaw
14-3-19

Mahesh Prasad
14/03/2019

11
 PART PLAN OF MOUZA SARAI DHELA SHOWING THE LAND COLOURED IN RED
 SOLD BY:- SRI HARADHAN MAHATO S/O LATE:- FOLU MAHATO AT. & P.O SARAI DHELA
 DIST. DHANBAD MOUZA NO. 8 KHATA NO. 77 IN PLOT NO. 3362 AN AREA OF -
 30 ¹/₂ DEC. ~~AND~~ PLOT NO. 3368 AREA 04 DEC. AND KHATA NO. 92 PLOT NO. 3215 AREA
 02 DEC. TOTAL AREA 36 ¹/₂ DEC.

TO THE HAND OF SRI MAHESH PRASAD MAHATO. 05/10
 SRI SRINATH MAHATO -
 AT. & P.O. SARAI DHELA, DIST. DHANBAD.



CHOUHADI OF

OF PLOT NO. 3362 AND 3368
 N:- B.C.C.L. Boundary & MAHATO Colony.
 S:- Makyu Mahato & Jagajshwar Mahato.
 E:- B.C.C.L.
 W:- PLOT NO. 3360 ~~AND 3363~~

OF PLOT NO 3215
 N:- Khiru Mahato.
 S:- Garib Ram Show.
 E:- Kali Pada Mandal.
 W:- Khiru Mahato.

TRUE COPY
 FROM SHEET NO. 2
 MOUZA SARAI DHELA
 SCALE:- 1" = 330' 0"

AK. Roy.
 D. Man.
 DRAWN BY:-

Haradhan Mahato as a
 Constituted attorney of
 Uragia Devi