

SELLER → (1) SRI DHIREN MANDAL (2) SRI SUBAL MANDAL (3) SRI MANTU MANDAL (4) SRI AJAY MANDAL S/O LATE HARI PAD MANDAL OF SARAIIDHELA DHANBAD POWER OF ATTORNEY HOLDER SRI MAHA-DEO MANDAL S/O LATE ATUL CHANDRA MANDAL OF SARAIIDHELA P.S- SARAIIDHELA DIST- DHANBAD.

PURCHASER → SMT. SHAKUN DEVI W/O SRI BIJAY KUMAR SINGHAL OF J.C. MAJHI ROAD HIRAPUR P.O:- DHANBAD P.S:- DHANBAD DIST- DHANBAD

SCHEDULE: → MOUZA :- SARAIIDHELA NO:-08 OLD KHATA NO-06 OLD PLOT NO-548 NEW KHATA NO-1272 NEW PLOT NO-1318 AREA- SKATHA SHOWN IN RED COLOUR



Boundary

NORTH - BLOCK C/26
 SOUTH - BLOCK C/28(P)
 EAST - OM PRAKASH MALI
 WEST - 16'-0" wide ROAD

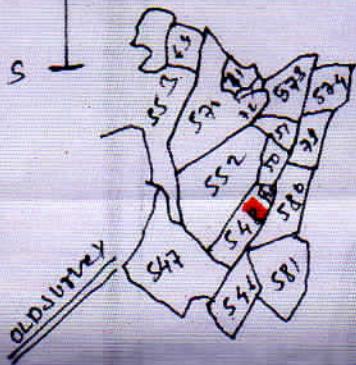

Scale 890' = 1 mile

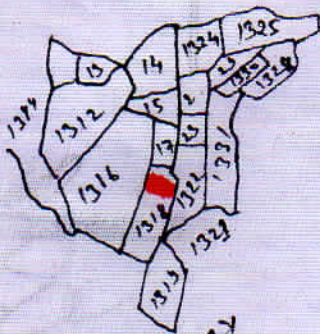
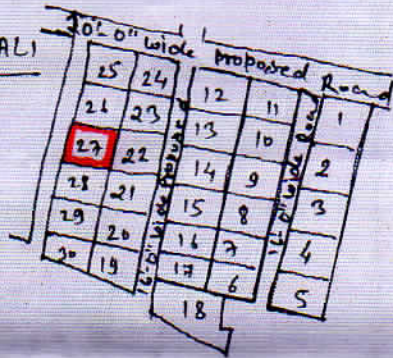

NEW SURVEY

Site Plan not to scale

Trace by
Ajendra Kumar