

SCHEDULE OF OPENINGS	
Sl. NO.	DESCRIPTION
1.	1.22M X 2.12M Panelled l.w. single shutter door
2.	MKD 0.91M X 2.12M Panelled l.w. single shutter door
3.	D 0.76M X 2.12M Panelled l.w. single shutter door
4.	D1 2.44M X 1.22M Glazed steel framed window 3. shut
5.	D2 1.22M X 1.22M Glazed steel framed window 2. shut
6.	W 1.37M X 1.07M Glazed steel framed window 2. shut
7.	W1 0.61M X 0.61M Top hung steel ventilator

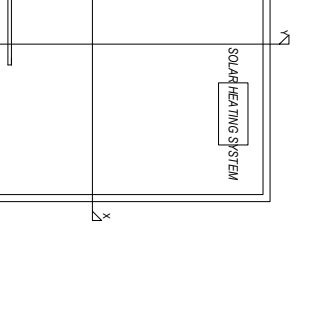
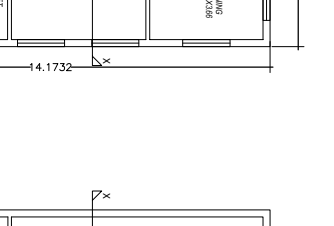
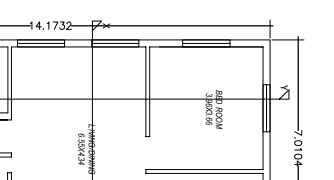
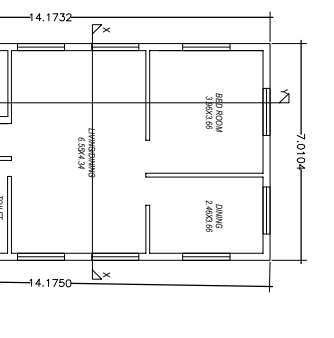

DETAILS OF AREA	
LAND AREA (AS PER ZONE)	: 186.71 SQ.MT.
LAND AREA (AVAILABLE)	: 156.08 SQ.MT.
GROUND FLOOR AREA	: 88.42 SQ.MT.
FIRST FLOOR AREA	: 88.42 SQ.MT.
TOTAL COVERED AREA	: 186.84 SQ.MT.
% OF PLOT AREA	: 63.06 %
F.A.R	: 1.28

BRIEF SPECIFICATION	
FOUNDATION	: 6" R.C.C. (1:2:4) foundation bed & 8" dia. brick work in cement mortar (1:3) in foundation.
FLOORING	: 1/2" R.C.C. (1:1.5:3) at ground or the plinth level.
FLOORING	: 1/2" R.C.C. (1:1.5:3) above flooring over 3" R.C.C. (1:3:3)
SUPERSTRUCTURE	: First class brick work in cement mortar (1:3) SLAB, BEAM & LINTEL : R.C.C. work (1:1.5:3).
WOOD WORKS	: All doors & window frames of all wood.
PLASTERING	: 1/2" R.C.C. plaster (1:3) on both side.
STAIR CASE	: RISE - 6" TREAD - 10"

TITLE OF DRAWING
 PLAN OF PROPOSED RESIDENTIAL BUILDING OF SMT. KAVAL KUMARI W/O SRI. KAUSHAL KUMAR OF HATHNER SAMPATCHAK, P.S. GOURRILCHAK, DIST-PATNA BIHAR, UNDER MOTIACH - PANDRIPALIANO - 04, KARLA NO.- 03, NEVY KENDRA NO.- 602, 1ST FLOOR, FLOT NO.- 244 IN THE DISTT. OF DIBRUGDO (DHUBRIGAND).

SIGNATURE OF DIRECTORS (FOR WORK OF AUTHORITIES)
 SIGNATURE OF ENGINEER

PROYANKA KUMARI
 18.28m
 6.53m
 1.52m
 0.91m
 1.52m
 0.91m
 1.14m
 18.288m LOT NO. 138
 4.87M wide road
 SCALE - 1" = 8'0"