

VENDOR :- SHIV BHUMI CONSTRUCTION PVT LTD REPRESENT BY BRIARUN KUMAR SINGH S/O SRI INDRADEB NARAYAN SINGH OF SARAIHELIA NEAR D.D.S. P.S. SARAIHELIA DIST DHANBAD.

VENDEE : SRI KRISHNA SINGH S/O LATE GANGA BISHUN SINGH OF MOONI DIH QUARTER NO. BM/119. BALUDIH COL. P.S. PUTKI DIST DHANBAD.

SCHEDULE :- MAUZA :- DHAIYA. MAUZA NO. 06. KHATA NO. 21. PLOT NO. 4326. AREA. 2.14. KATHA.

BOUNDARY :- NORTH :- PART OF PLOT NO. 4326.
SOUTH :- 16'.0" WIDE RASTA.
EAST :- PART OF PLOT NO. 4326.
WEST :- PART OF PLOT NO. 4326.

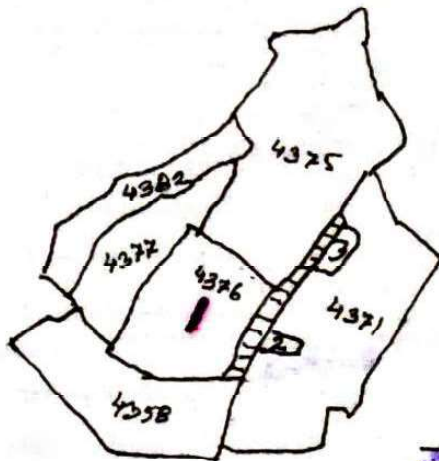

KEY PLAN.
SCALE: 1"=300'

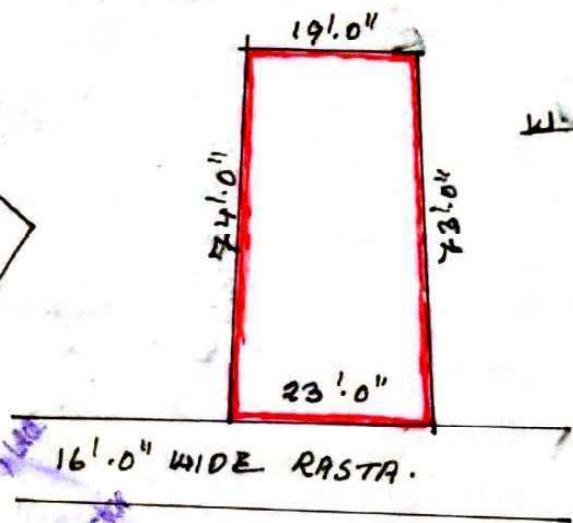

SITE PLAN.
NOT TO SCALE.

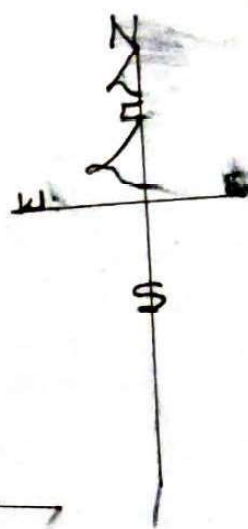

PREPARED BY:
[Signature]
AMIN