

Project Title: RAHIL GOEL

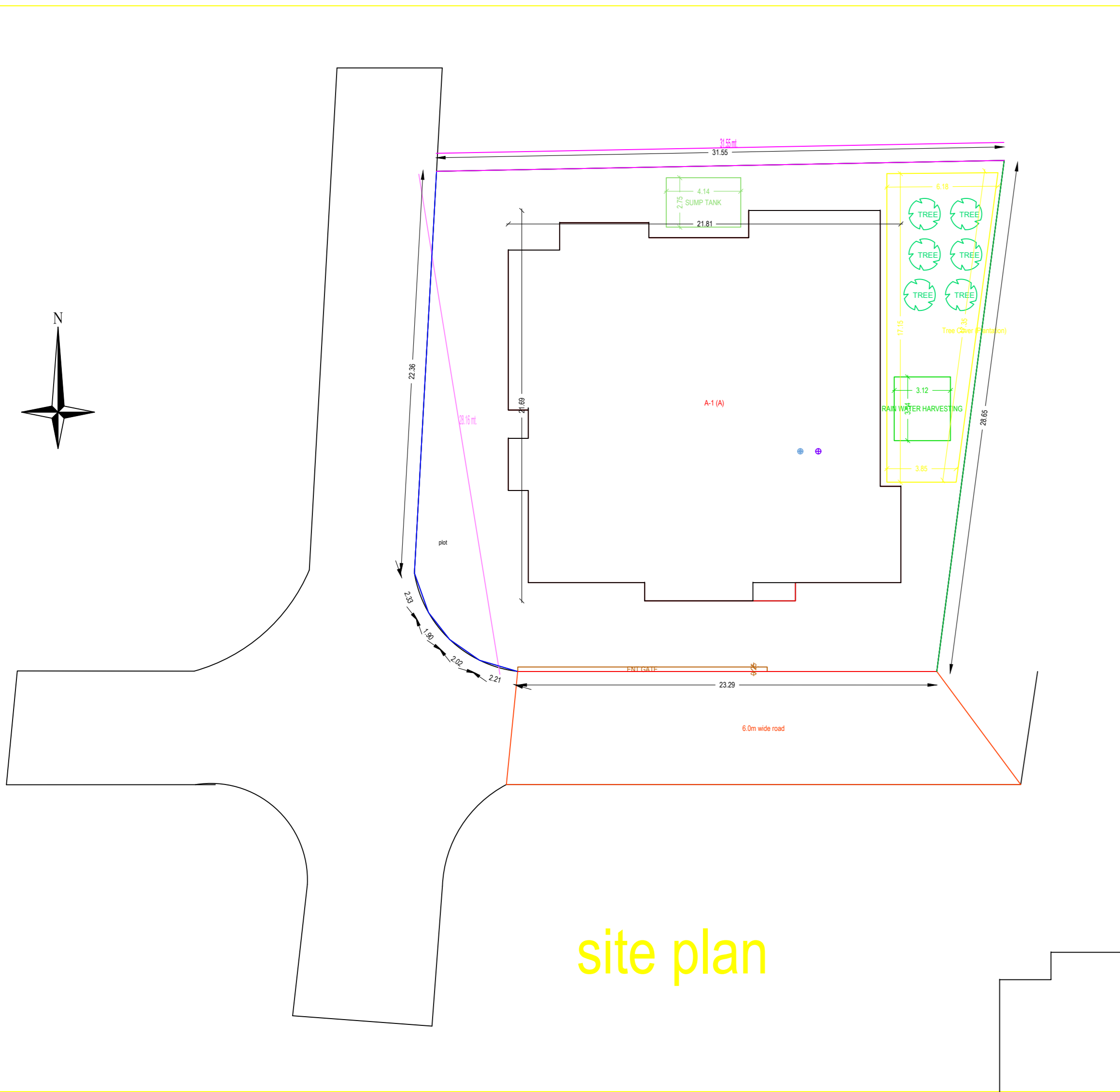

site plan

FRONT ELEVATION

RIGHT SIDE ELEVATION

LOCATION PLAN

KEY PLAN

PLAN OF SEPTIC TANK

DETAIL OF COLUMNS

WATER HARVESTING

SECTION ON Y-Y

SECTION ON X-X

SOLAR HEATING SYSTEM

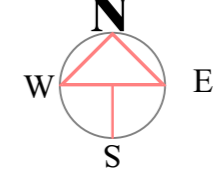

**BRIEF SPECIFICATION**  
 FOUNDATION — CEMENT CONCRETE (1:1.5:3)  
 BRICK WORK IN FOUNDATION & SUPERSTRUCTURE  
 FIRST CLASS BRICK WORK IN CEMENT MORTAR (1:6)  
 D.P.C. — 25 D.P.C. IN CEMENT CONCRETE (1:2:4)  
 FLOOR — 25 D.P.C. OVER 75 P.C.C.  
 ROOF — 100 THK. R.C.C. ROOF (1:1.5:3)  
 LINTEL — 150 THK. R.C.C. LINTEL (1:1.5:3)  
 STAIRS — RISE — 150, TREAD — 250

**SCHEDULE**  
 D = 1.200X2.100      W = 1.800X1.200  
 D1 = 1.050X2.100      W2 = 0.900X1.200  
 D2 = 0.900X2.100      V = 0.600X0.600

**TITLE OF DRAWING**  
 PROPOSED RESIDENTIAL BUILDING OF RAHIL GOEL, 100 RAHIL GOEL OF  
 MENDO MORE ROAD, DHARYA, DHANBAD  
 ON INDIA, DHANBAD & BASTARAD - 83, PLOT NO. 1370 IN THE DISTRICT  
 OF DHANBAD, JHARKHAND

SIGNATURE OF OWNER

SIGNATURE OF ENGINEER

SCALE ALL DIMENSION ARE IN METRE

**Building A-1/A**

Particulars	Area (sq. m)	Volume (cu. m)	Weight (kg)	Quantity (m <sup>3</sup> )	Quantity (kg)
Concrete	120.00	120.00	3000000	120.00	3000000
Brickwork	100.00	100.00	1000000	100.00	1000000
D.P.C.	100.00	100.00	1000000	100.00	1000000
Floor	100.00	100.00	1000000	100.00	1000000
Roof	100.00	100.00	1000000	100.00	1000000
Lintel	100.00	100.00	1000000	100.00	1000000
Stairs	100.00	100.00	1000000	100.00	1000000
Other	100.00	100.00	1000000	100.00	1000000
<b>Total</b>	<b>620.00</b>	<b>620.00</b>	<b>6200000</b>	<b>620.00</b>	<b>6200000</b>

**SCHEDULE OF JOBBES**

Particulars	Area (sq. m)	Volume (cu. m)	Weight (kg)	Quantity (m <sup>3</sup> )	Quantity (kg)
Concrete	120.00	120.00	3000000	120.00	3000000
Brickwork	100.00	100.00	1000000	100.00	1000000
D.P.C.	100.00	100.00	1000000	100.00	1000000
Floor	100.00	100.00	1000000	100.00	1000000
Roof	100.00	100.00	1000000	100.00	1000000
Lintel	100.00	100.00	1000000	100.00	1000000
Stairs	100.00	100.00	1000000	100.00	1000000
Other	100.00	100.00	1000000	100.00	1000000
<b>Total</b>	<b>620.00</b>	<b>620.00</b>	<b>6200000</b>	<b>620.00</b>	<b>6200000</b>

**UNITARY VALUE FOR BUILDING A-1/A**

Particulars	Area (sq. m)	Volume (cu. m)	Weight (kg)	Quantity (m <sup>3</sup> )	Quantity (kg)
Concrete	120.00	120.00	3000000	120.00	3000000
Brickwork	100.00	100.00	1000000	100.00	1000000
D.P.C.	100.00	100.00	1000000	100.00	1000000
Floor	100.00	100.00	1000000	100.00	1000000
Roof	100.00	100.00	1000000	100.00	1000000
Lintel	100.00	100.00	1000000	100.00	1000000
Stairs	100.00	100.00	1000000	100.00	1000000
Other	100.00	100.00	1000000	100.00	1000000
<b>Total</b>	<b>620.00</b>	<b>620.00</b>	<b>6200000</b>	<b>620.00</b>	<b>6200000</b>

Particulars	Area (sq. m)	Volume (cu. m)	Weight (kg)	Quantity (m <sup>3</sup> )	Quantity (kg)
Concrete	120.00	120.00	3000000	120.00	3000000
Brickwork	100.00	100.00	1000000	100.00	1000000
D.P.C.	100.00	100.00	1000000	100.00	1000000
Floor	100.00	100.00	1000000	100.00	1000000
Roof	100.00	100.00	1000000	100.00	1000000
Lintel	100.00	100.00	1000000	100.00	1000000
Stairs	100.00	100.00	1000000	100.00	1000000
Other	100.00	100.00	1000000	100.00	1000000
<b>Total</b>	<b>620.00</b>	<b>620.00</b>	<b>6200000</b>	<b>620.00</b>	<b>6200000</b>

**COLOR INDEX**

Color	Material
Red	Concrete
Green	Brickwork
Blue	D.P.C.
Yellow	Floor
Purple	Roof
Brown	Lintel
Black	Stairs
White	Other

**REVISIONS**

No.	Description	Date
1	Issue for approval	10/10/2023
2	Issue for construction	10/10/2023