

विक्रेता :- श्री शिवाशरण सिंह पिता स्व० मुन्दीका सिंह,
 सा० - चुनागोदाम, सरायदेला, थाना - सरायदेला जिला - धनबाद, 1

क्रेता :- (1) श्री राजेश भादव पिता स्व० बालेश्वर भादव सा० -
 निस्तीपाड़ा, (2) श्री अशोक कुमार पिता श्री जबाहर
 प्रसाद भादव सा० - अजन्ता पाड़ा, थाना जिला - धनबाद।

नपसील :- मौजा - सावलपुर थाना नं० - 11, थाना - सरायदेला,
 रवाना नं० - 12, प्लॉट नं० 441 एवं 442 कंश रकवा 7 कंश
 15 छटाक 23 वर्ग फीट। मनि 13.17 रु०।

जिसका नया प्लॉट नं० -
 नक्शे का स्केल = 1" = 330' 0" फीट
 चिन्हित ग्रामि  काल रंग है।

चौदही
 30 - प्लॉट नं० 434,
 20 - प्लॉट नं० 440
 70 - प्लॉट नं० 442 कंश नया
 प्रस्तावित रास्ता
 40 - प्लॉट नं० 438, 439,

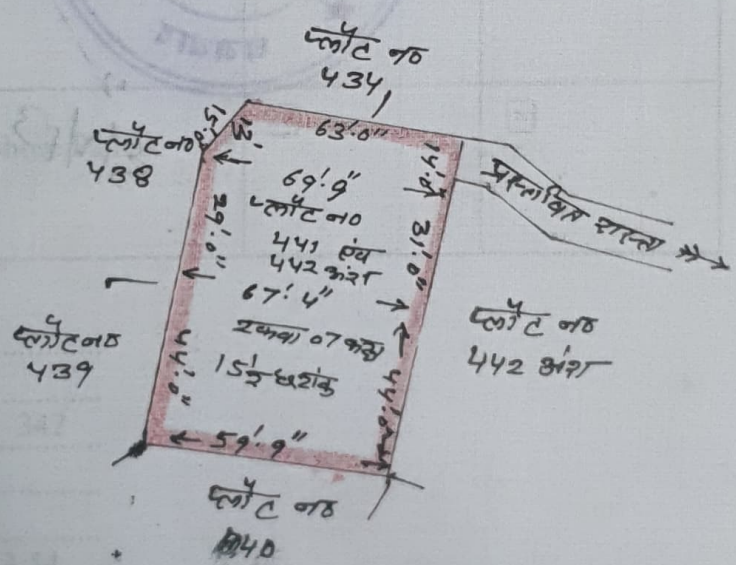

Witnessed by
 P. Mondal
 Amin
 Dhanbad.

Seja Sharan Singh
 05/02/2013
 Seja Sharan Singh

eller - Sri Akhlesh s/o Tai Narayan Sahu of Simaldih
Telipara P.S. & Dist. Dhanbad.

Attorney - Maksud Alam s/o Shahadat Hussain, of Vistipora
H.E. School Road, Near. H.E. School, Hirapur. Dhanbad.

Purchaser - (1) Santosh Kumar s/o Sri Sukar Gope of Sahyogi
Nagar Sec-II P.S. Saraidehela Dist. Dhanbad. (2) Shobiba
Begam w/o Maksud Alam of Vistipora, H.E. School
Road, Near H.E. School, Hirapur. Dhanbad.

Schedule - Mouza. Sabalpur no. 11. P.S. Saraidehela. Khata no. 12.
Plot no. 442. Area. 6-Kathas.

Shown in colour red.

Boundary - North - Part of this Plot.

South - Part of this Plot.

East - 25' wide Rasta.

West - Part of this Plot.



Scale 1" = 330' 0"

100' 0" px

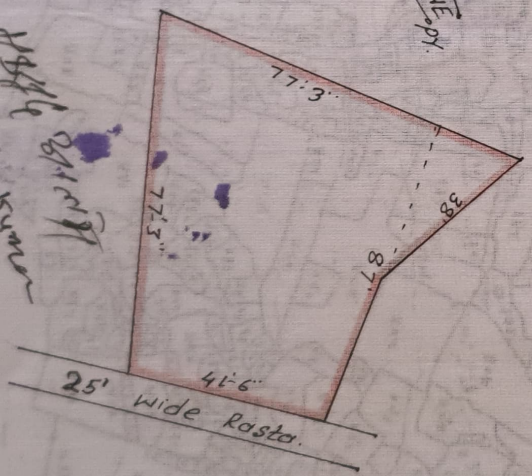

Santosh Kumar
Santosh Kumar

— सवादेविजाम

30.08.10

Handwritten signature and date at the bottom left corner.

seller — Sri Pankaj Kumar s/o Sri Birendra Prasad Singh
 of Kachchhi Bahihari, P.S: Putki, dist-Dhanbad.
 Rep. by Attorney: Sri Ashok Kumar s/o Sri
 Jawahar yadav of Bhisti Para, Hirapur, P.S. &
 dist-Dhanbad.

Purchaser:- Sri Sanjay Kumar s/o Sri Baleshwar yadav of
 H.E. School Road, Bhisti Para, Hirapur, P.S.
 & dist-Dhanbad

Schedule:- mouza: Sabalpur No. 11. New Khata No: 123
 Old Khata No: 12. New Plot No: 326 Old
 Plot No: 442. Area: 2 Katha, or to
 say 3.30 Dec.

Boundary:- North : Raju mabato
 South : Santosh yadav & mansud
 East : 25'-0" wide Road
 West : Sanjay Kumar

Shown in red

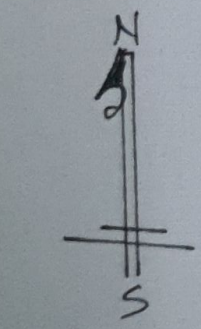

TRUE COM

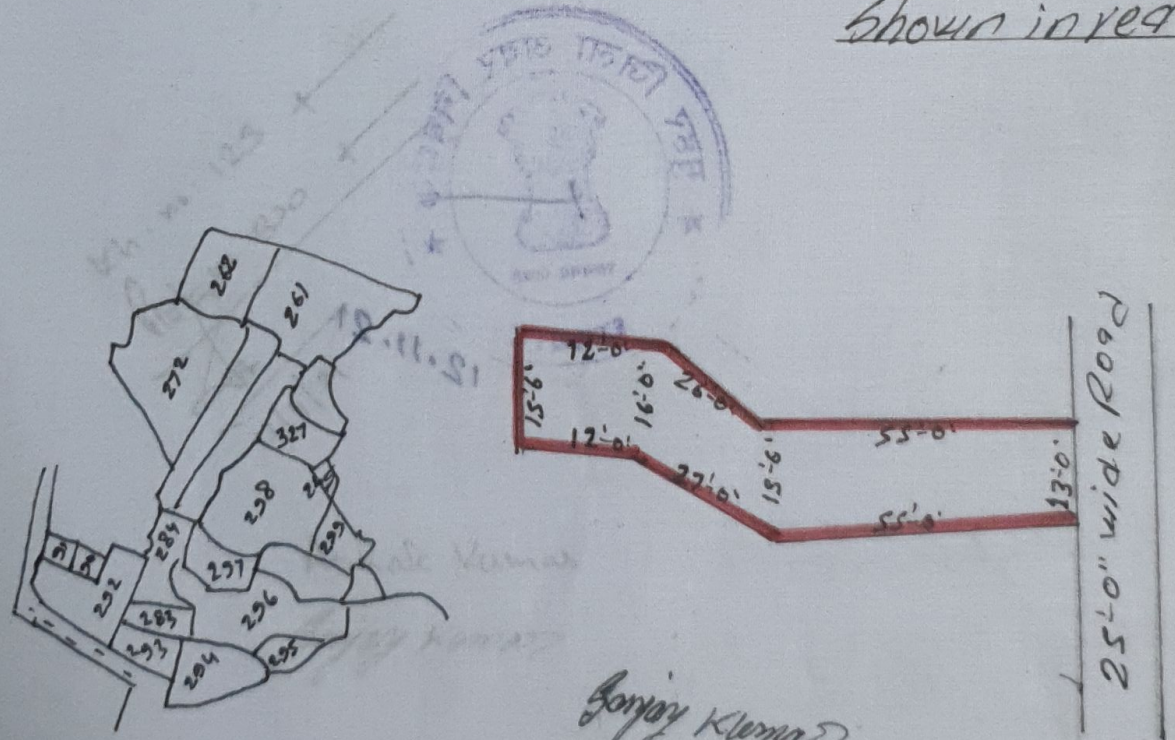

Sanjay Kumar

Ashok Kumar

12.11.2011

T.G