

Seller:- Sri. Byas Ji Giri s/o Deo Lal Giri of 980, Nilanchal Colony, East of Shiv Mandir, Govindpur Road, p.s.: - Jaraidhela, dist.: - Dhanbad.

Purchaser:- Sri. Niraj Kumar Yadav s/o Junddeo Yadav, Sri. Dhiraj Kumar s/o Junddeo Yadav of vill.: - Kumardih, p.o.: - Banpur, p.s.: - Khairi, dist.: - Jamui (Bihar).

Schedule:- Mouza:- Nolaruema, no.: - 12, New Khata no.: - 245, old Khata no.: - 43, new Plot no.: - 396, old plot no.: - 454, Area:- 4 Katha or 6.60 decimals of land with a single storied Building having 877 sq.ft.

Boundary:-  
North:- Umila Janta, (lot no.: - 80 and 81)  
South:- Lalmoni Devi, (lot no.: - 86)  
East:- 20'0" wide road,  
West:- Shanti Devi, (lot no.: - 84)

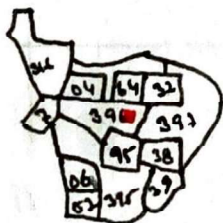

Scale:- 16" = 1 Mile

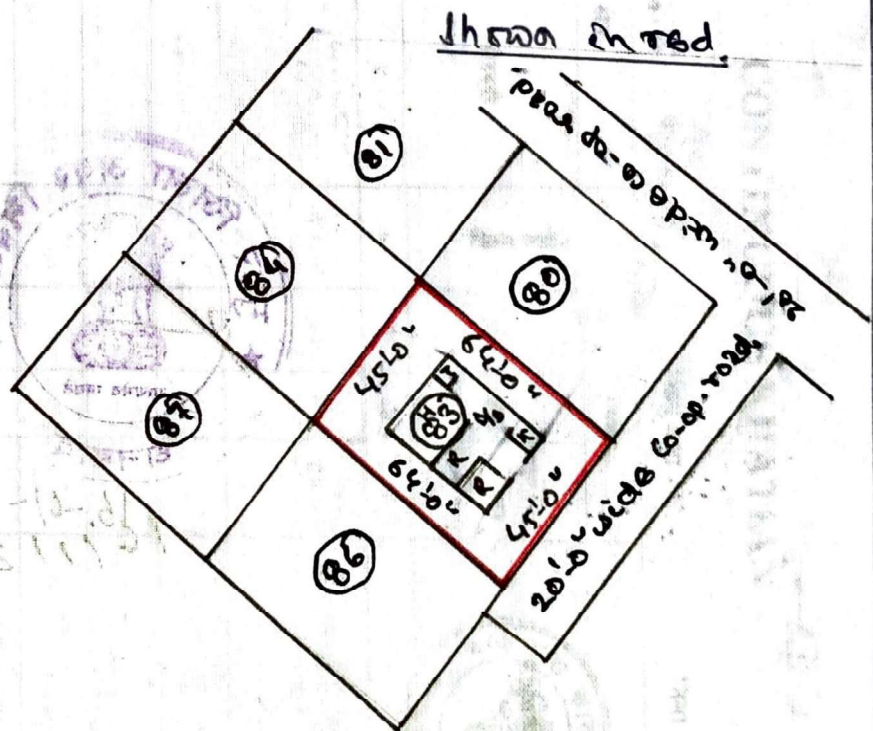

(Not to scale)

Traced By:-  
Biplob Majumdar  
(Amin)  
R. O. Dhanbad

Asst. Secy  
16/1/23