

NARENDRA KUMAR KARN S/O LATE - K.L.
AS OF HOUSING COLONY HIG-4.
DIST- DHANBAD, JHARKHAND, PIN- 826001.

BER... ① SMT. SOBHA RANI C/O SWAPAN KUMAR
MODAK OF KESHALPUR, COLLIERY, KESHALPUR,
DIST- DHANBAD, JHARKHAND, PIN- 828119

② SRI RANJEET KUMAR MODAK S/O SWAPAN^{YR} MODAK
OF KESHALPUR, COLLIERY, KESHALPUR,
DIST- DHANBAD, JHARKHAND, PIN- 828114.

SCHEDULE - MOOZA - BHELATAND, No. 89, GOVINDPUR
NEW KHATA No. 33, NEW PLOT No. 488
OLD KHATA No. 57, OLD PLOT No. 654
AREA - 03 KATHA



BOUNDARY

NORTH ... NEW PLOT No. 489, 490, (492)
SOUTH ... 20'0" ROAD.
EAST ... PART OF THIS PLOT, 16'0" ROAD.
WEST ... PART OF THIS PLOT, 20'0" ROAD.



NEW MAP
KEY PLAN:-
SCALE - 1" = 330'0"

Traced by
[Signature]

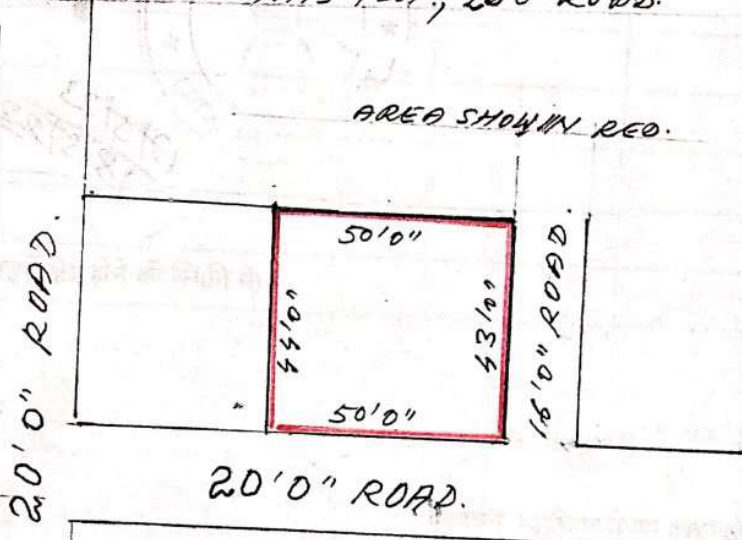

20'0" ROAD.
20'0" ROAD.

— SITE PLAN: —
Narendra Kumar Karn - NOT TO SCALE
Date: 17-05-2023, Ranjeet Kumar Modak