

Jharkhand industrial Area Development Authority, Ranchi Region
JIADA BHAWAN, Namkum Industrial Area, Lowadih, Ranchi

No. 1241/JIADA, Ranchi Region

Dated 17/12/18

PHYSICAL POSSESSION CERTIFICATE

This is to certify that in compliance of order No. 1231 dated 04-12-2018 for giving physical possession of plot no. 3/B, Mukesh Kumar Sr. I.E.O. of the Authority and R.N. Sahu, Surveyor hand over physical possession of **Plot No. 3/B, Saher (Nagari) Industrial Area**, to the allottee unit to **M/s CETI Enterprises.**, represented by Shri Rajendra Kunwar, Proprietor this the-----day of December 2018 at Saher (Nagri) Industrial Area.

Affix photograph of officials of Authority



I Shri Rajendra Kunwar, 1.00 Acre land Proprietor of M/s CETI Enterprises., received physical possession of land-Village-Saher, Thana- Nagri, Thana No-116, Dist-Ranchi, Khata No-155 Survey Plot No-1253P Area 1.00 Acre. land from Mukesh Kumar Sr. I.E.O. of the Authority in the presence of Sanjeev Lakra, I.E.O and R.N. Sahu Surveyor on this the 17...day of December, 2018 at Saher (Nagri) Industrial Area.

R.N. Sahu
Surveyor
JIADA, Ranchi Region

Mukesh Kumar Sr.
I.E.O
JIADA, Ranchi Region

Rajendra Kunwar
Dev. Officer
JIADA, Ranchi Region

Rajendra Kunwar
(RAJENDRA KUNWAR)
Signature with name, designation,
address and rubber stamp of the
representative of the unit

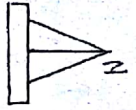

Authorised Signatory
CETI ENTERPRISES

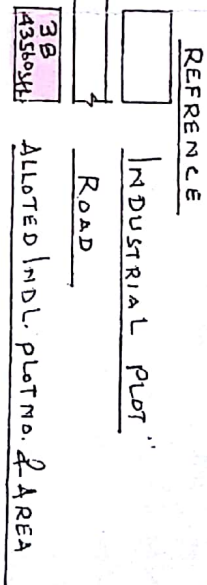
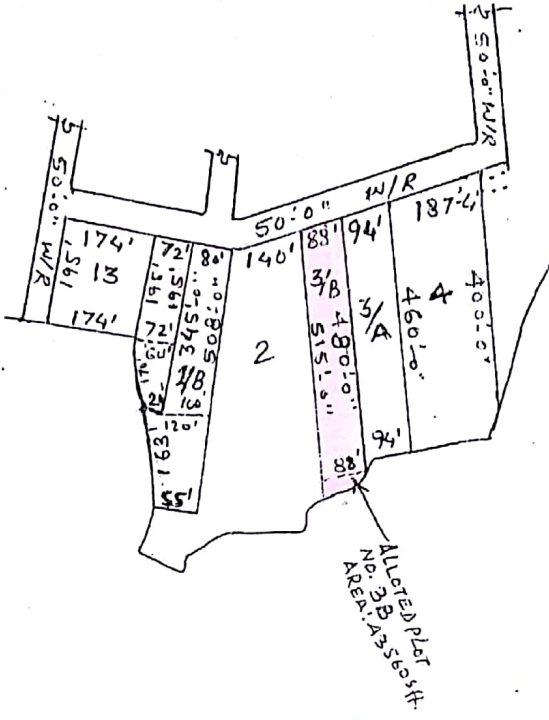

PLAN SHOWING THE LAND ALLOTTED TO M/S CETI ENTERPRISES IN THE INDUSTRIAL AREA SAHER (NAGRI) RANCHI. ALLOTTED IND. PLOT NO. 38 AREA: 43560^{sq}.
 VIDE JADDA RANCHI REGION ORDER NO. LA/RNC/SW/00322/2018 DATED: 04.09.2018

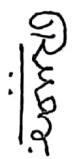

SCALE: 1"=330.0'

THARKHAND INDUSTRIAL AREA DEVELOPMENT AUTHORITY RANCHI REGION		
LAND POSSESSION MAP		
TAKEN OVER	HANDLED OVER	
  		
M/S CETI ENTERPRISES	JADDA RANCHI REGION I. E. O.	DEVELOPMENT OFFICER JADDA RANCHI REGION
SURVEYOR: 