

SITE LANDPLAN OF M/S RIDDHI FOODS

AT- BOKARO INDUSTRIAL AREA

BOKARO STEEL CITY-14 SCALE---1"=330'-0"



VILLAGE-----MARAPHARI
 THANA NO-----16
 THANA-----JARIDIH
 P-S-----BALIDIH
 DIST-----BOKARO

KHATA NO-- L.S. PLOT No-----AREA
 57 - - - - - 4683 (P) - - - - - 0.095 AC.

TOTAL-----AREA-----0.095 AC.

BOUNDRY

SURVEY PLOT NO-----INDUSTRIAL PLOT NO
 N- 4683 (P) 34684 (P) --- J/E- 94
 S- 4677 (P) --- VILLAGE BOUNDRY
 E- 4683 (P) --- 80'-0" WIR
 W- 4683 (P) --- VILLAGE ROAD

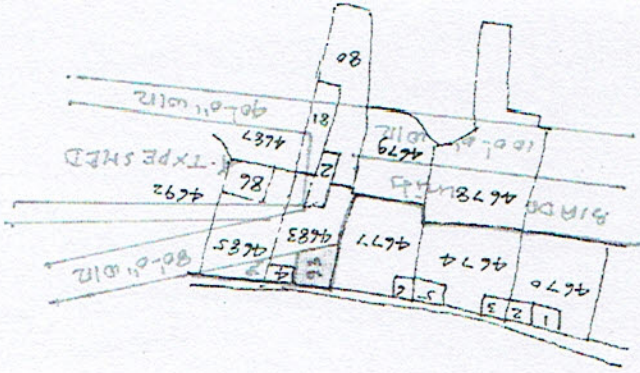

INDUSTRIAL PLOT NO-----J/E- 93

CALCULATION:

$$\frac{56'-0" + 72'-0" \times 46'-0" + 65'-0"}{2}$$

$$= \frac{128'-0" \times 131'-0"}{2}$$

$$= 64'-0" \times 65'-5"$$

$$= 4192 \text{ sqft}$$

$$\text{say} = 0.095 \text{ AC}$$

PLOTSIZE



M/s RIDDHI FOODS

[Signature]
 1-10-19
 Proprietor

TRACED BY

[Signature]

BHIM PRASAD MAHTO

AMIN (CONT)

JIADA, BOKARO REGION

M/S RIDDHI FOODS

AT- BOKARO INDUSTRIAL AREA

BOKARO STEEL CITY- 14

सचिव, विद्युत-पुनर्निर्माण
 क्षेत्रीय कार्यालय
 विद्युत, पटना

SECRETARY cum DY DIRECTOR

JIADA, BOKARO REGION

M/s RIDDHI FOODS

[Signature]
 Proprietor