

Jharkhand industrial Area Development Authority, Ranchi Region
JIADA BHAWAN, Namkum Industrial Area, Lowadih, Ranchi

No. 737./JIADA, Ranchi Region

Dated 12/04/2019

PHYSICAL POSSESSION CERTIFICATE

This is to certify that in compliance of order No.- 729/JIADA Ranchi Region dated- 11-04-2019 for giving physical possession of plot I, Mukesh Kumar Sr. I.E.O. of the Authority in presence of Sanjeev Lakra, I.E.O. and R.N. Sahu, Surveyor hand over physical possession of Plot No. **C, Kulhi (Ormanjhi) Industrial Area**, to the allottee unit to **M/s Valencia Apparels**, represented by Nikhil Jain, Authorized representative this the.....day of April 2019 at Kulhi (Ormanjhi) Industrial Area.

Affix photograph of officials of Authority



I Nikhil Jain, Authorized representative of **M/s Valencia Apparels**, Plot No. **C** received physical possession of land-Village-Kulhi, Thana-Ormanjhi, Thana No-11, Dist-Ranchi, Khata No-112 Survey Plot No-2061P, Area 1.55 Acres. land from Mukesh Kumar Sr. I.E.O. of the Authority in the presence of Sanjeev Lakra, I.E.O and R.N. Sahu Surveyor on this theday of April, 2019 at Kulhi (Ormanjhi) Industrial Area.

Surveyor
JIADA, Ranchi Region

I.E.O
JIADA, Ranchi Region

Dev. Officer
JIADA, Ranchi Region

For VALENCIA APPARELS

Nikhil Jain
12/04/19 Auth. Sing.

Signature with name, designation, address and rubber stamp of the representative of the unit

BB

PLAN SHOWING THE LAND ALLOTTED TO M/S VALENCIA APPARELS IN THE INDUSTRIAL AREA KULHI (ORMANJHI), RANCHI. ALLOTTED INDL. PLOT NO.: C AREA: 1.55 ACRES VIDE JIADA RANCHI REGION ORDER NO. LA/RNC/SM/00381/2019 DATED: 04/01/19

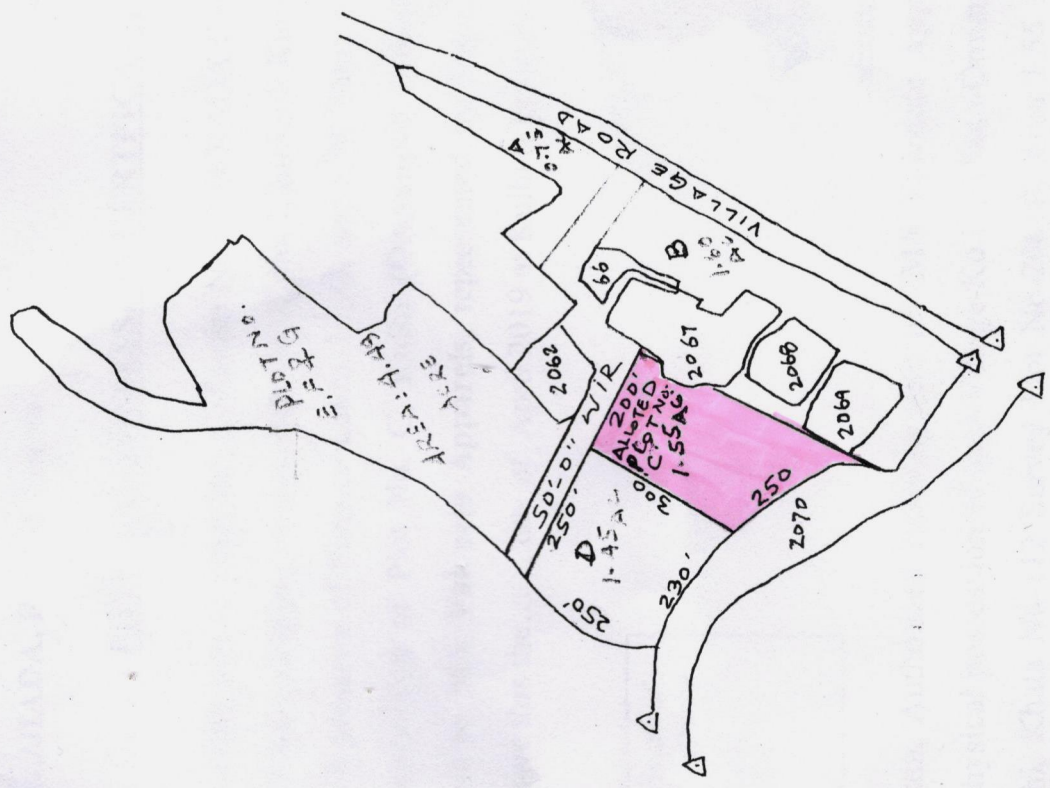
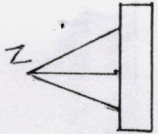

REFERENCE



INDUSTRIAL PLOT

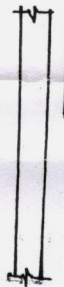

ROAD

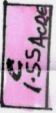

ALLOTTED INDL. PLOT NO. AREA

SCALE: 1"=330'-0"

JHARKHAND INDUSTRIAL AREA DEVELOPMENT AUTHORITY RANCHI REGION

LAND POSSESSION MAP

TAKEN OVER

HANDED OVER

For VALENCIA APPARELS

Mukund Jaiswal
12/04/19
Auth. Sing.

(Signature)
NW

M/S VALENCIA APPARELS

I.E.O. JIADA RANCHI REGION

DEV. OFFICER

JIADA, RANCHI REGION

SURVEYOR: *(Signature)*