

PHYSICAL POSSESSION CERTIFICATE

This is to certify that in compliance of order No. LA/BO/SW/00311/2018 dated 01-09-2018 for giving physical possession of Plot in presence of Industry Extension Officer and Sri Bhim Prasad Mahto, Amin handed over Physical possession of Plot No.D-2, Bokaro Industrial Area, to the allottee unit M/s. Om Sai Industries represented by Mr Manish Kumar S/O Sri Ramji Prasad. on this the 05th Day of October 2018.



Affix photo of Officials

[Handwritten signature]



Affix photograph of Representative of the allottee unit

I, Mr Manish Kumar , S/o Ramjee Prasad, Bharechnagar Sandi, Ramgarh, Jharkhand, of the person taking over possession of the allotted land, Plot No. D-2, Area 1.00 acre authorized representative of M/s. Om Sai Industries, Bokaro Industrial Area, received physical possession of land, in presence of Sri Sunny Kumar, Assistant Development Officer and Sri Bhim Prasad Mahto, Amin of the authority on this the 05th Day of October 2018.

M/S OM SAI INDUSTRIES
BHARECH NAGAR, SANDI
Ramgarh (Jharkhand), Pin-829117

Signature with name, designation address and Rubber stamp of the unit

Signature of BIADA Representative

1. Assistant Development Officer
[Handwritten signature]
05-10-18

2. Amin - *[Handwritten signature]*
05/10/18

SITTELAND PLAN OF M/S OM SAI INDUSTRIES

AT - BOKARO INDUSTRIAL AREA
 BOKARO STEEL CITY - 14
 SCALE - 1" = 330.0"

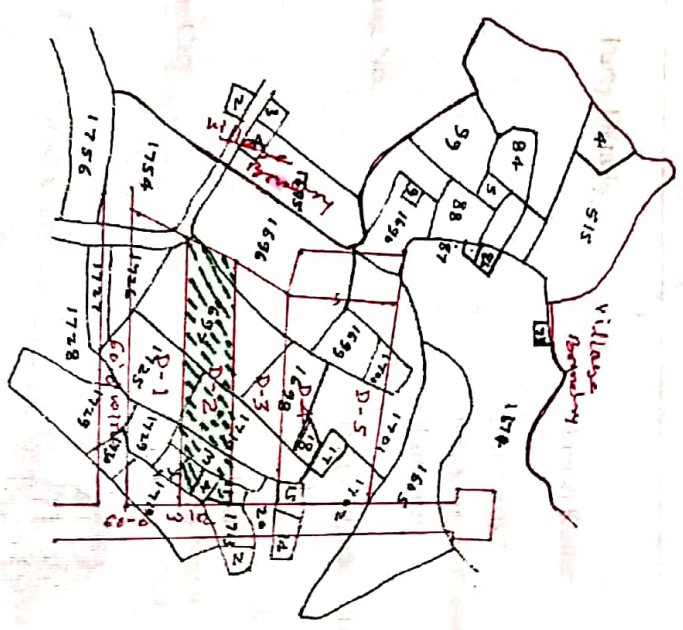

VILLAGE.....GORABALI
 THANA NO.....14
 THANA.....JARIDIH
 P.S.....BALDIH
 DIST.....BOKARO

KHATTANO - L.S. PLOT NO - AREA

46	1696 (P)	0.10 AC
50	1697 (P)	0.34 "
5	1725 (P)	0.05 "
132	1719 (P)	0.32 "
124	1723 (P)	0.10 "
177	1721 (P)	0.01 "
4	1710 (P)	0.04 "
132	1724 (P)	0.06 "
TOTAL AREA		1.00 AC

L.S. PLOT NO INDUSTRIAL PLOT NO
 N - 1696 (P), 1697 (P), 1719 (P), 1723 (P), 1721 (P) IV/D-5
 S - 1697 (P), 1725 (P), 1723 (P), 1710 (P) IV/D-1
 E - 1713 (P), 1710 (P)
 W - 1696 (P)
 VILLAGE BOUNDARY

CALCULATION:-

$$\frac{500'-0" + 452'-0"}{2} \times 91'-0" = 479'-0" \times 91'-0" = 43589 \text{ sq ft}$$

$$\text{say} = 1.00 \text{ AC}$$

INDUSTRIAL PLOT NO - - - IV/D-2

TRACED BY
 BHIM PRASAD MAHTO
 AMIN (COURT)

FOR
 M/S OM SAI INDUSTRIES
 Proprietor

DIRECTOR
 Project Land
 Bokoaro

M/S OM SAI INDUSTRIES
 AT - BOKARO INDUSTRIAL AREA
 BOKARO STEEL CITY - 14

