

VILLAGE-----GORABALI
 THANA NO-----14
 THANA-----JARIDIH
 P-S-----BALDIH
 DIST-----BOKARO

KHATANO	L.S. PLOT NO	AREA
46	1696 (P)	0.10 AC
50	1697 (P)	0.34 "
5	1725 (P)	0.03 "
132	1719 (P)	0.32 "
134	1723 (P)	0.10 "
177	1721 (P)	0.01 "
4	1710 (P)	0.04 "
132	1724 (P)	0.06 "
TOTAL		1.00 AC

BOUNDRY

L.S. PLOT NO ----- INDUSTRIAL PLOT NO
 N- 1696 (P), 1697 (P), 1719 (P), 1723 (P) & 1721 (P) ----- IV/D-3
 S- 1697 (P), 1725 (P), 1723 (P) & 1710 (P) ----- IV/D-1
 E- 1713 (P) & 1710 (P) ----- 60'-0" WIR
 W- 1696 (P) ----- VILLAGE BOUNDRY

INDUSTRIAL PLOT NO --- IV/D-2

PLOT SIZE
458'-0"

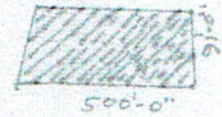

Handwritten:
 Calculation:-

$$\frac{500 + 458 - 0}{2} \times 91 - 0$$

$$= 479 - 0 \times 91 - 0$$

$$= 43589 \text{ sq}$$
 sq = 1.00 AC

TRACED BY
Chait
 BHIM PRASAD MAHTO
 AMIN (CONT)

FOR
 M/S OM SAI INDUSTRIES
Mansu Kumar
 Proprietor
 M/S OM SAI INDUSTRIES
 AT- BOKARO INDUSTRIAL AREA

Signature
 DIRECTOR
 DIRECTOR
 Project Lands and Rehabilitation
 D. P. BOKARO