

Jharkhand industrial Area Development Authority, Ranchi Region
JIADA BHAWAN, Namkum Industrial Area, Lowadih, Ranchi

No...2.../JIADA, Ranchi Region

Dated 3-1-2019

PHYSICAL POSSESSION CERTIFICATE

This is to certify that in compliance of order No. 1234 dated 05-12-2018 for giving physical possession of plot no. **1/B**, Mukesh Kumar Sr. I.E.O. of the Authority and R.N. Sahu, Surveyor hand over physical possession of **Plot No. 1/B, Saher (Nagari) Industrial Area**, to the allottee unit to **M/s Smart Farmer Agrotech.**, represented by Shri K.K. Dubey, Proprietor this the 31-day of December 2018 at Saher (Nagri) Industrial Area.

*Affix photograph of
officials of Authority*



I Smt. Suman Dubey, **1.00 Acre** land Proprietor of **M/s Smart Farmer Agrotech.**, received physical possession of land-Village-Saher, Thana- Nagri, Thana No-116, Dist-Ranchi, Khata No-155 Survey Plot No-1253P Area 1.00 Acre. land from Mukesh Kumar Sr. I.E.O. of the Authority in the presence of Sanjeev Lakra, I.E.O and R.N. Sahu Surveyor on this the 31-day of December, 2018 at Saher (Nagri) Industrial Area.

R.N. Sahu
Surveyor
JIADA, Ranchi Region

Bhawan
I.E.O
JIADA, Ranchi Region

Sanjeev Lakra
Dev. Officer
JIADA, Ranchi Region

For SMART FARMER AGROTECH

Suman Dubey

Signature with name, designation,
address and rubber stamp of the
representative of the unit



PLAN SHOWING THE LAND ALLOTTED TO M/S SMART FARMER AGROTECH. IN THE INDUSTRIAL AREA SAHER (NAGRI), RANCHI. ALLOTTED/INDL. PLOT NO. 1/B AREA: 1.00 ACRES VIDE JIADA RANCHI REGION ORDER NO. LA/RNC/SW/00323/2018 DATED: 04.09.2018

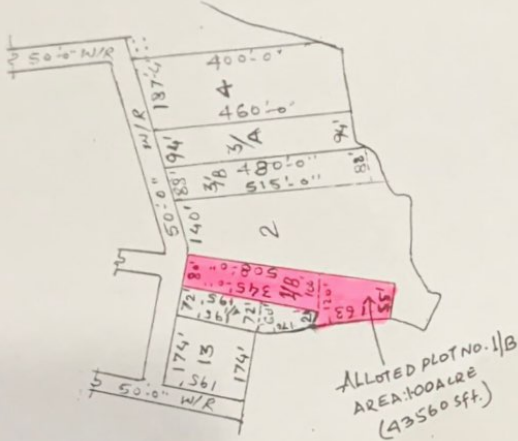
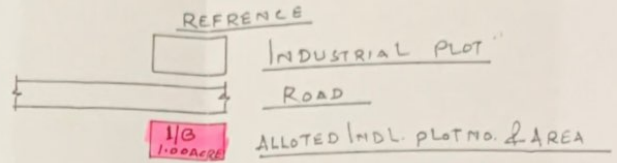

SCALE: 1" = 330'-0"

JHARKHAND INDUSTRIAL AREA DEVELOPMENT AUTHORITY RANCHI REGION

LAND POSSESSION MAP

TAKEN OVER	HANDLED OVER	
For SMART FARMER AGROTECH Sumit Debi PROPRIETOR	Biswal	
M/S SMART FARMER AGROTECH.	I. E. O. JIADA RANCHI REGION	DEVELOPMENT OFFICER JIADA RANCHI REGION
SURVEYOR: R...		