

M.S. MINER ENGINEER
INDUSTRIAL AREA NANKUM RANCHI

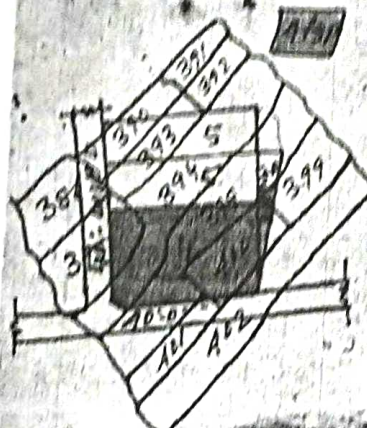

VILLAGE - SAMLONG
THANA - RANCHI
THANA NO. 212
DISTRICT - RANCHI
SCALE - 16" = 1 MILE

ALLOTTED IND
PLOT NO. 4 & 3P
SHOWN IN RED WASH

KHATA NO.	SURVEY PLOT NO.	AREA IN ACRE
115	394P	0.217
202	395P	0.186
9	398P	0.352
4	399P	0.018
"	400P	0.320
"	401P	0.001
"	402P	0.041

As per the plan submitted
checked all details for
the Govt. of Jharkhand

TOTAL AREA - 1.065 ACRE

NORTH: BY S.P. NO. 394P, 395P, 398P, 399P & IND
PLOT NO. 5 AND 3 PART
SOUTH: BY S.P. NO. 394P, 398P, 400P, 401P, 402P &
INDUSTRIAL ROAD
EAST: BY S.P. NO. 399P, 400P, 402P & IND PLOT NO.
3 PART
WEST: BY S.P. NO. 394P, 395P & INDUSTRIAL
ROAD

BY *[Signature]*
R. I. A. D. SECRETARY