

SITE LAND PLAN OF M/S HEALTH PLUS HOSPITAL & RESEARCH CENTRE
 AT- CHAS INDUSTRIAL AREA
 JIADA, BOKARO, REGION, BOKARO

SCALE- 1"=330'-0"

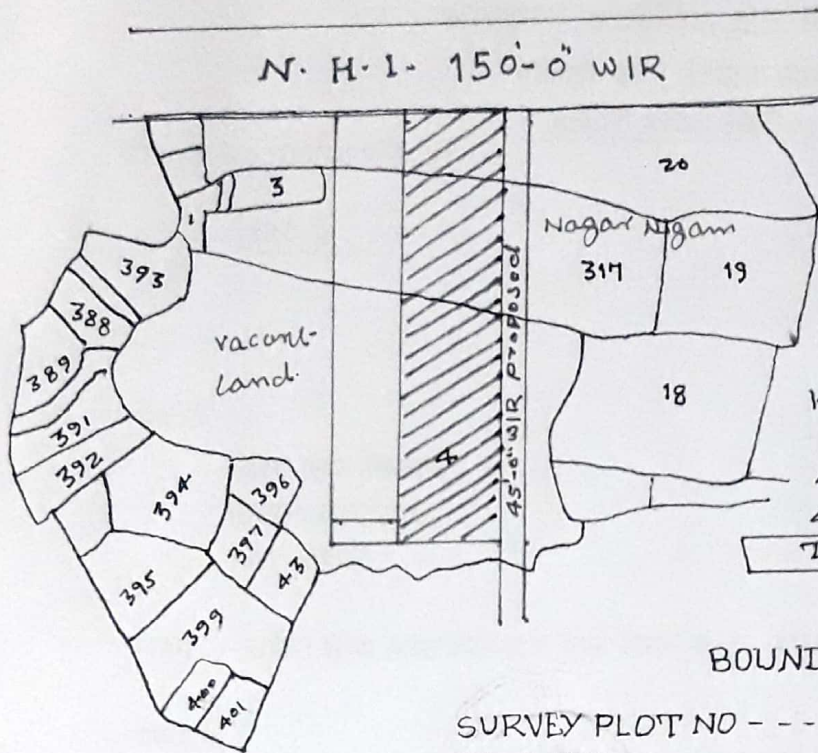
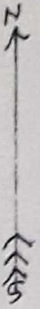

MOZA-----KAMALDIH
 THANA NO ---- 31
 THANA -----CHAS
 DIST'-----BOKARO

KHATA NO-	L.S.	PLOT NO-	AREA
48	---	20(P)	0.45 AC
48	---	20/317(P)	0.87 "
48	---	04(CP)	1.68 "
TOTAL			AREA-----3.00 AC

BOUNDRY

SURVEY PLOT NO ----- INDUSTRIAL PLOT NO
 N- 20(P) ----- N.H.I. 150'-0" WIR
 S- 4 (P) ----- vacant land.
 E - 20(P), 317(P) & 4(P) ----- 45'-0" WIR PROPOSED
 W- 4(P), 317(P) & 20(P) ----- vacant land.

CALCULATION:-

$$180'-0" \times 726'-0" = 1,30,680 \text{ SST}$$

say = 3.00 AC

SURVEY PLOT NO --- 04/317(P), 20(P) & 04(P)

PLOT SIZE

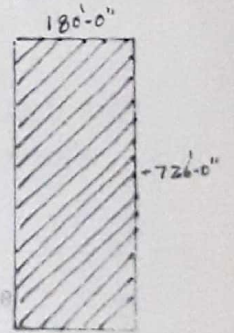

Health Plus Hospital & Research Center
[Signature]
 Authorized Signatory

Assistant Development Officer (Industrial)
 JIADA

TRACED BY

[Signature]

BHIM PRASAD MAHTO

AMIN (CONT)

JIADA, BOKARO REGION

FOR

M/S HEALTH PLUS HOSPITAL & RESEARCH CENTRE

AT- CHAS INDUSTRIAL AREA

JIADA, BOKARO REGION, BOKARO

ASST. DEV. OFFICER
 JIADA, BOKARO REGION

[Signature]