

**Jharkhand industrial Area Development Authority, Ranchi Region**  
**JIADA BHAWAN, Namkum Industrial Area, Lowadih, Ranchi**

No. ~~734~~ /JIADA, Ranchi Region

Dated 2-6-2021

**PHYSICAL POSSESSION CERTIFICATE**

This is to certify that in compliance of order No.-884/JIADA, Ranchi Region dated- 23-09-2020 for giving physical possession of plot I, Dilip Kumar. A.D.O. of the Authority in presence of Dilip Kumar, A.D.O. and R.N. Sahu, Surveyor hand over physical possession of Plot No. **30, Lohardaga Industrial Area**, to the allottee unit to **M/s Nishant Engineering Works**, represented by Smt. Roshni Kumari, Proprietor this the ..... day of April 2021 at Lohardaga Industrial Area.

*Affix photograph of  
officials of Authority*

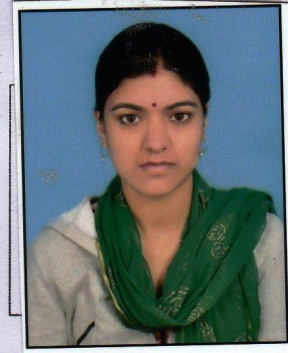

I, Smt. Roshni Kumari, Proprietor of **M/s Nishant Engineering Works**, received physical possession of land-Village-Lohardaga, Thana-Lohardaga, Thana No.-194 Dist-Lohardaga, Khata No. 313, Survey Plot No-1677P Area **5000 sft.** land from Dilip Kumar, A.D.O. of the Authority in the presence of Dilip Kumar, A.D.O. and R.N. Sahu Surveyor on this the ..... day of April, 2021 at Lohardaga Industrial Area.

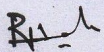
  
Surveyor  
JIADA, Ranchi Region

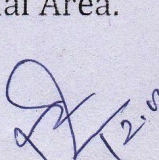
  
A.D.O  
JIADA, Ranchi Region

  
Dev. Officer  
JIADA, Ranchi Region

**Nishant Engineering Works**

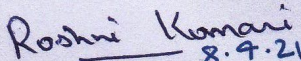
  
8.4.21  
Proprietor

*Signature with name, designation,  
address and rubber stamp of the  
representative of the unit*

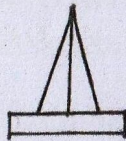

PLAN SHOWING THE LAND ALLOTTED TO M/S NISHANT ENGINEERING WORKS, IN THE LOHARDAGA INDUSTRIAL AREA ALLOTTED INDL. PLOT NO. 30 AREA: 5000 SFT. VIDE JIADA RANCHI REGION ORDER NO. LA/RNC/SW/00593/2020 DATED: 25.06.2020.

REFERENCE



SCALE: 1" = 330'-0"

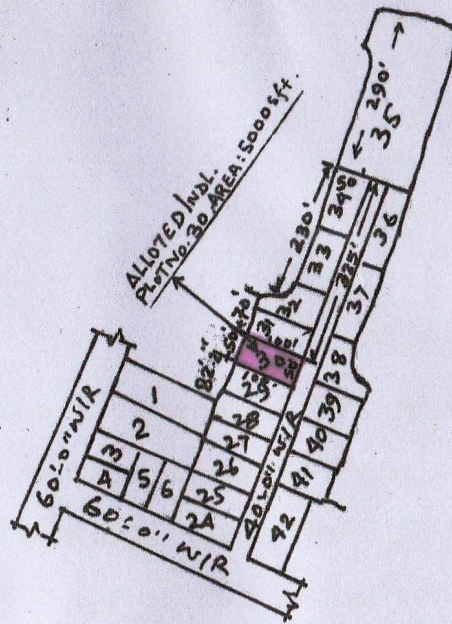

JHARKHAND INDL. AREA DEVELOPMENT AUTHORITY RANCHI REGION

LAND POSSESSION MAP

TAKEN OVER

HANDED OVER

Nishant Engineering Works

Rodhu Komari  
8.9.21  
Proprietor

M/S NISHANT ENGINEER-  
ING WORKS.

A.D.O. JIADA  
RANCHI REGION

DEV. OFFICER  
JIADA  
RANCHI REGION

SURVEYOR: