

Jharkhand industrial Area Development Authority, Ranchi Region
JIADA BHAWAN, Namkum Industrial Area, Lowadih, Ranchi

No. 1269./JIADA, Ranchi Region

Dated 18-12-2018

PHYSICAL POSSESSION CERTIFICATE

This is to certify that in compliance of order No. 1260 dated 14-12-2018 for giving physical possession of plot no. 5, Mukesh Kumar Sr. I.E.O. of the Authority and R.N. Sahu, Surveyor hand over physical possession of **Plot No. 5, Barhi Industrial Area**, to the allottee unit to **M/s Rishav Sahu Enterprises.**, represented by Shri Rishav Kumar Sahu, Proprietor this the 13---day of December 2018 at Barhi Industrial Area.

Affix photograph of officials of Authority



Rishav Sahu Enterprises
 Proprietor

I Shri Rishav Kumar Sahu, **1.00 Acre** land Proprietor of **M/s Rishav Sahu Enterprises**, received physical possession of land-Village-Konra, Thana- Barhi, Thana No-72, Dist-Hazaribagh, Khata No-13,13,40 Survey Plot No-695P,696P,697P Area 1.00 Acre. land from Mukesh Kumar Sr. I.E.O. of the Authority in the presence of Sanjeev Lakra, I.E.O and R.N. Sahu Surveyor on this the 13...day of December, 2018 at Barhi Industrial Area.

 Surveyor
 JIADA, Ranchi Region

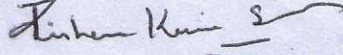

 I.E.O
 JIADA, Ranchi Region

 Dev. Officer
 JIADA, Ranchi Region

Rishav Sahu Enterprises

Proprietor

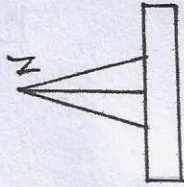
Signature with name, designation, address and rubber stamp of the representative of the unit

PLAN SHOWING THE LAND ALLOTTED TO M/S RISHAV SAHU ENTERPRISES
 IN BARHI INDUSTRIAL AREA, H/BAGH. ALLOTTED (NDL PLOT NO. 5 AREA: 43560 SF.
 VIDE JIADA RANCHI REGION ORDER NO. LA/RNC/SW/00166/2018 DATED: 18.04.2018



REFERENCE



INDUSTRIAL PLOT



ROAD

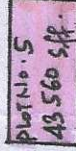

ALLOTTED (NDL PLOT NO. 5 AREA: 43560 SF.
 (SIZE: 186' X 234' 2''))

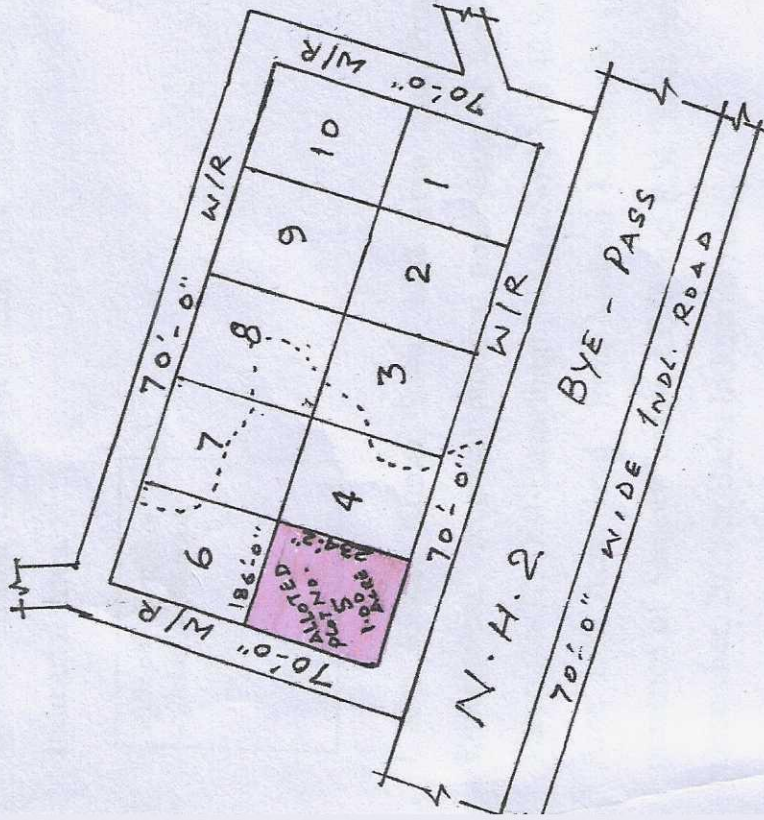

SCALE: 1" = 330'-0"

JHARKHAND INDUSTRIAL AREA DEVELOPMENT AUTHORITY, RANCHI REGION	
LAND POSSESSION MAP	
TAKEN OVER	HANDED OVER
Rishav Sahu Enterprises Rishav Sahu Proprietor	I.E.O. JIADA RANCHI REGION
M/S RISHAV SAHU ENTERPRISES	DEV. OFFICER JIADA RANCHI REGION
SURVEYOR: [Signature]	