

Jharkhand industrial Area Development Authority, Ranchi Region
JIADA BHAWAN, Namkum Industrial Area, Lowadih, Ranchi

No. 62 /JIADA, Ranchi Region

Dated 29-10-2020

PHYSICAL POSSESSION CERTIFICATE

This is to certify that in compliance of order No.- 1206/JIADA, Ranchi Region dated-26.09.2019 for giving physical possession of plot I, Mukesh Kumar Sr. I.E.O. of the Authority in presence of Sanjeev Lakra, I.E.O. and R.N. Sahu, Surveyor hand over physical possession of Plot No. **13/C, Barhi Industrial Area**, to the allottee unit to **M/s Venkateshwara Hatcheries Pvt. Ltd.**, represented by **Dr. Vidyasagar Punja**, Private Limited Company this the 01 October, 2019 at Barhi Industrial Area.

*Affix photograph of
officials of Authority*

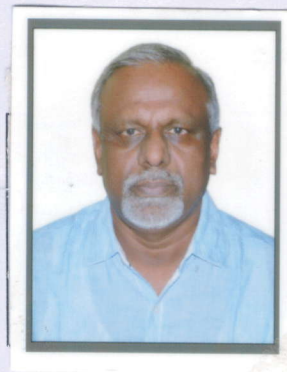

I **Dr. Vidyasagar Punja** Authorized Signatory of **M/s Venkateshwara Hatcheries Pvt. Ltd.**, Plot No. 13/C, received physical possession of land-Village-Konra, Thana-Barhi, Thana No-72, Dist-Hazaribagh, Khata No-32, 58, 59, 46, 78, 78, 55 Survey Plot No-1488P, 1489P, 1487P, 1490P, 807P, 1531P, 1527P, Area **6.00 Acre.** land from Mukesh Kumar Sr. I.E.O. of the Authority in the presence of Sanjeev Lakra, I.E.O and R.N. Sahu Surveyor on this the 01 October, 2019 at Barhi Industrial Area.

Surveyor
JIADA, Ranchi Region

I.E.O
JIADA, Ranchi Region

Dev. Officer
JIADA, Ranchi Region

For Venkateshwara Hatcheries (P) Limited

Authorized Signatory

Signature with name, designation,
address and rubber stamp of the
representative of the unit

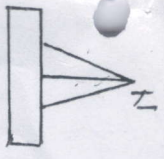

PLAN SHOWING THE LAND ALLOTTED TO M/S VENKATESHWARA HATCHERIES PVT. LTD.
 IN THE BARHI INDUSTRIAL AREA, HAZARI BAGH, ALLOTTED IND. PLOT NO. 13/C AREA: 6.00 ACRES
 WIDE TIADA RANCHI REGION ORDER NO. LA/RNC/JM/00534/2019 DATED: 29.07.2019

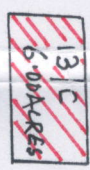
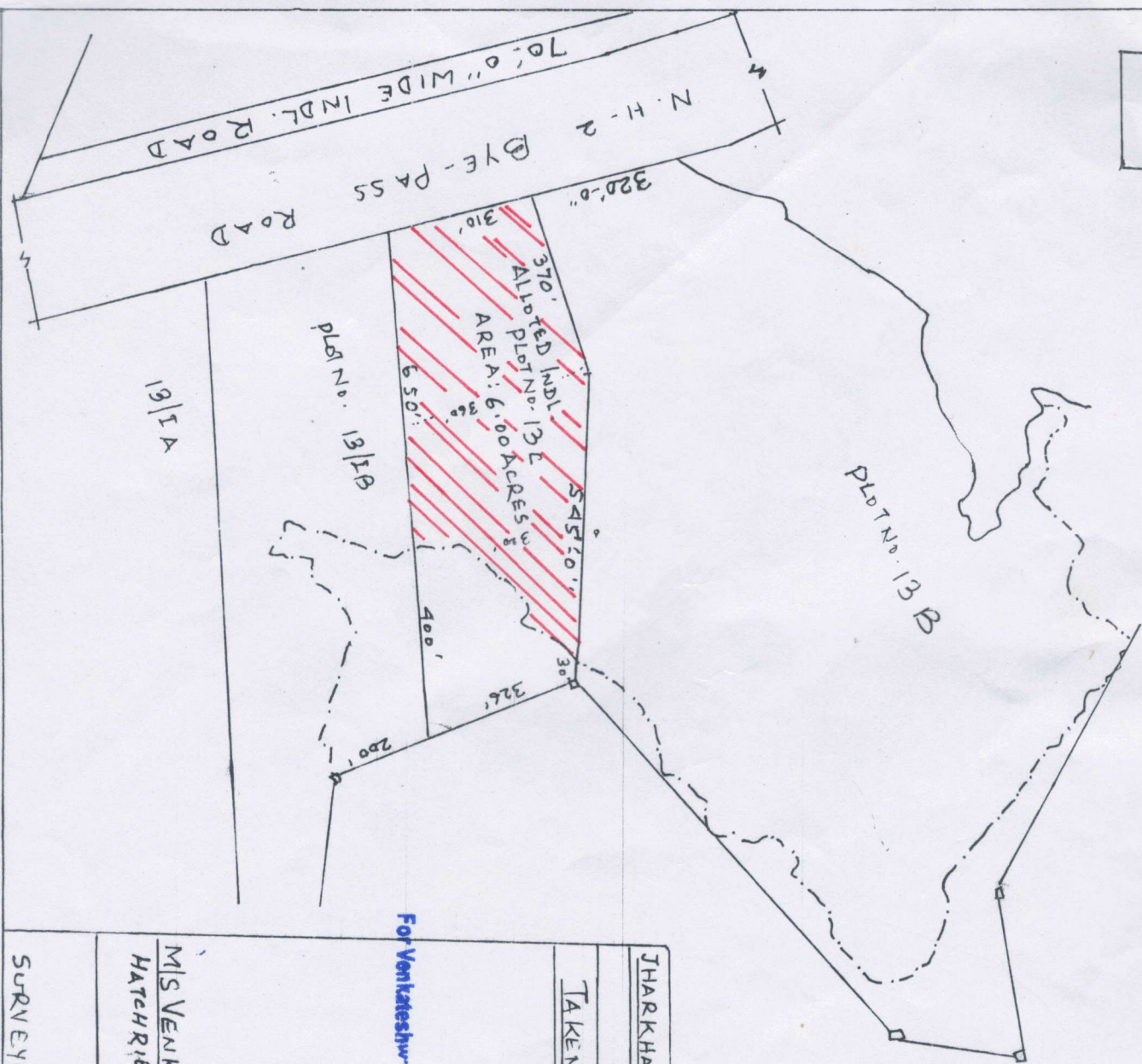

ALLOTTED IND. PLOT NO. 13/C AREA



INDUSTRIAL PLOT



ROAD

SCALE: 1" = 330' 0"

CHHATTISGARH INDUSTRIAL AREA DEVELOPMENT AUTHORITY, RANCHI
 LAND POSSESSION MAP
 TAKEN OVER _____ HANDED OVER _____

For Venkateshwara Hatcheries Pvt. Ltd.
General Manager
(Signature)

(Signature)

(Signature)

M/S VENKATESHWARA HATCHERIES PVT. LTD.	J. E. O. TIADA RANCHI REGION	DEV. OFFICER TIADA RANCHI REGION
--	------------------------------	----------------------------------

SURVEYOR: *(Signature)*