

LAND PLAN DP:- M/S SOFTWARE TECHNOLOGY PARKS OF INDIA

VILLAGE:- ASANGI
 THANA No:- 126
 §

VILLAGE:- BHATRA
 THANA No:- 127
 THANA :- SARAIKELLA
 DIST :- SARAIKELLA.
 KHARSAWAN
 SCALE :- 16" = 1 MILE

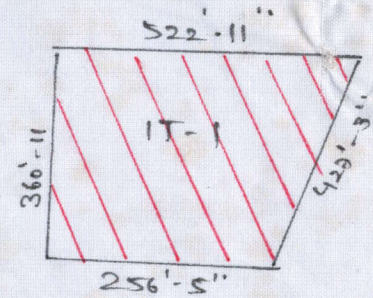
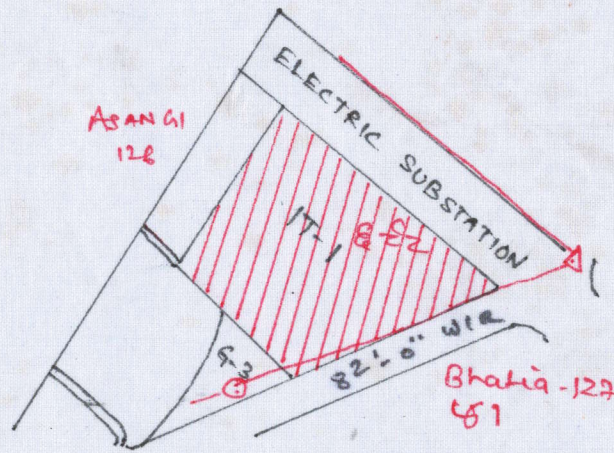

S. PLOT NO. KHATA NO
 ASANGI-126 698-P-189
 BHATIA-127 41-P-60

AREA:- 3.50 Ae

INDUSTRIAL PLOT NO:- IT-1 (NEAR 7th PHASE)

CERTIFIED THAT THE ORIGINAL AND DUPLICATE PLAN'S ARE EXACT TRUE AND REPRODUCTION OF EACH OTHER

Boundary

| S. plot no | 2nd plot no |
|---|--------------------|
| N:- ASANGI-126 698 (P) | - U-2 |
| S:- ASANGI-126 & Bhatia 127 - G-3 698 (P) & 41 (P) | AiADA LAND. |
| E:- BHATIA-127 41 (P) | - 82 FT WIDE ROAD. |
| W:- ASANGI-126 698 - (P) | - AiADA Land. |

[Signature]
 Joint Director
 Software Technology Parks of India
 Ranchi Center

Anil Kumar
 11/11/2017
 Anil Kumar
 C.I. JiADA
 Adityapur Region

Secretary
 Adityapur Indl. Area Deve.
 Authority, Adityapur

[Handwritten mark]