

# PARKING PLAN

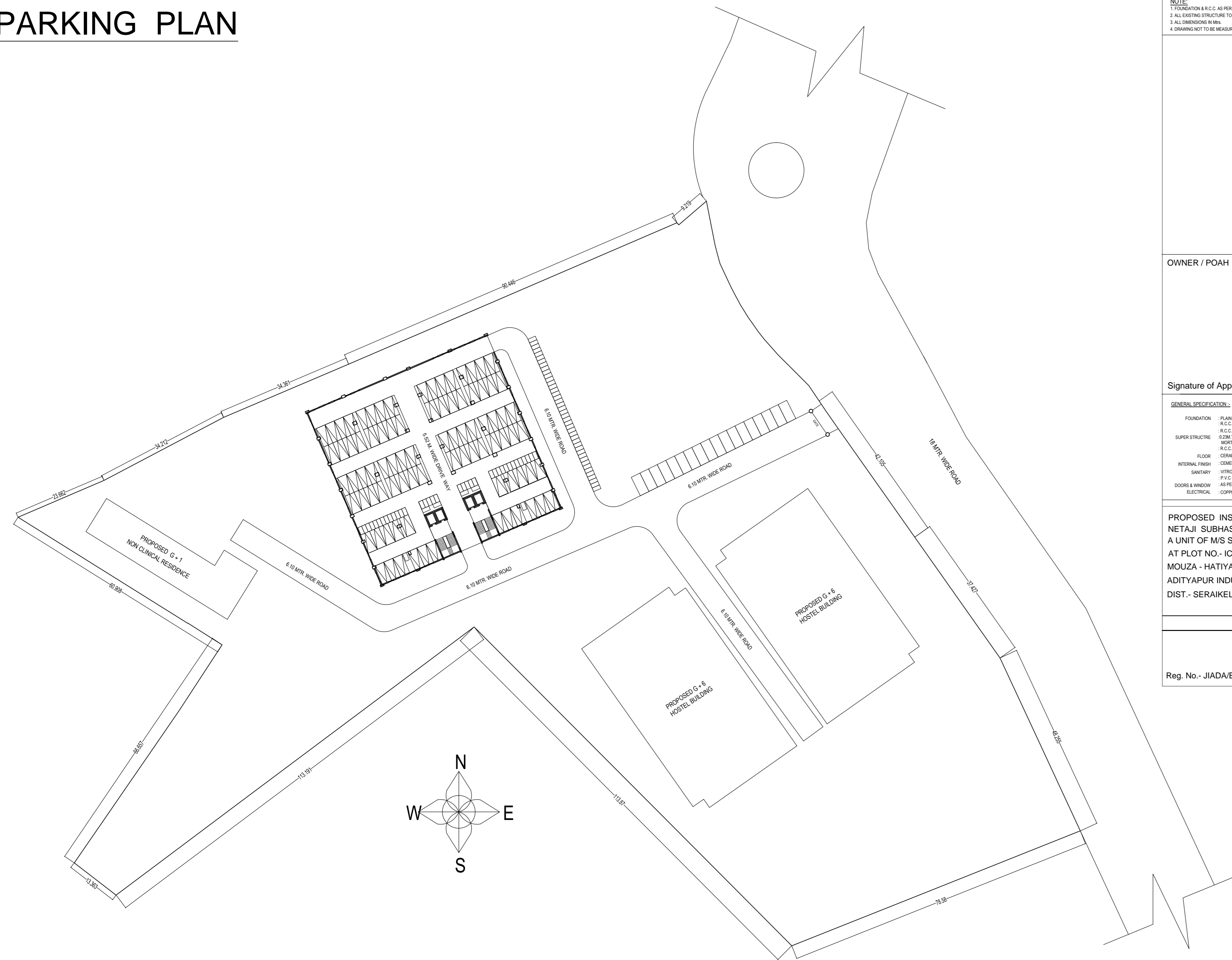

**NOTE**  
 1. FOUNDATION R.C.C. AS PER STRUCTURAL DESIGN SPECIFICATION  
 2. ALL EXISTING STRUCTURE TO BE DEMOLISHED  
 3. ALL DIMENSIONS IN M  
 4. DRAWING NOT TO BE MEASURED

OWNER / POAH

Signature of Applicant:-

**GENERAL SPECIFICATION:-**  
 FOUNDATION : PLAN CONCRETE AS PER DESIGN  
 R.C.C. COLUMN FOOTING & COLUMN AS PER STRUCTURAL DESIGN  
 SUPER STRUCTURE : R.C.C. COLUMN & BEAM AS PER STR. DESIGN  
 EXTERIOR EXT. WALL : 150MM THK. PARTITION WALL IN CEMENT MORTAR  
 FLOOR : R.C.C. ROOF SLAB AS PER STRUCTURAL DESIGN  
 INTERNAL FINISH : CEMENT PLASTER WITH P.F.P. & G.O.D.  
 SANITARY : VITROUS CHINA CLAY SANITARY WARE G.I. PIPE WATER SUPPLY  
 DOORS & WINDOW : AS PER SCHEDULE  
 ELECTRICAL : COPPER WIRE WITH P.V.C. CONDUIT.

PROPOSED INSTITUTIONAL BUILDING PLAN OF  
 NETAJI SUBHAS MEDICAL COLLEGE AND HOSPITAL  
 A UNIT OF MS SITWANTO DEVI MAHILA KALYAN SANSTHAN  
 AT PLOT NO.- IC- 4  
 MOUZA - HATIYADH AND BHATIA, NEAR PHASE -7,  
 ADITYAPUR INDUSTRIAL AREA,  
 DIST.- SERAIKELA - KHARSAWAN (JHARKHAND)

SHEET No. 05 / 08  
 L.K. SUMAN  
 Dra. - 1 Scale/10m  
 Seal: [Blank]  
 Ser. Jumber

Reg. No.- JIADA/ENG/0014/2021

# GROUND TO 6TH FLOOR PLAN

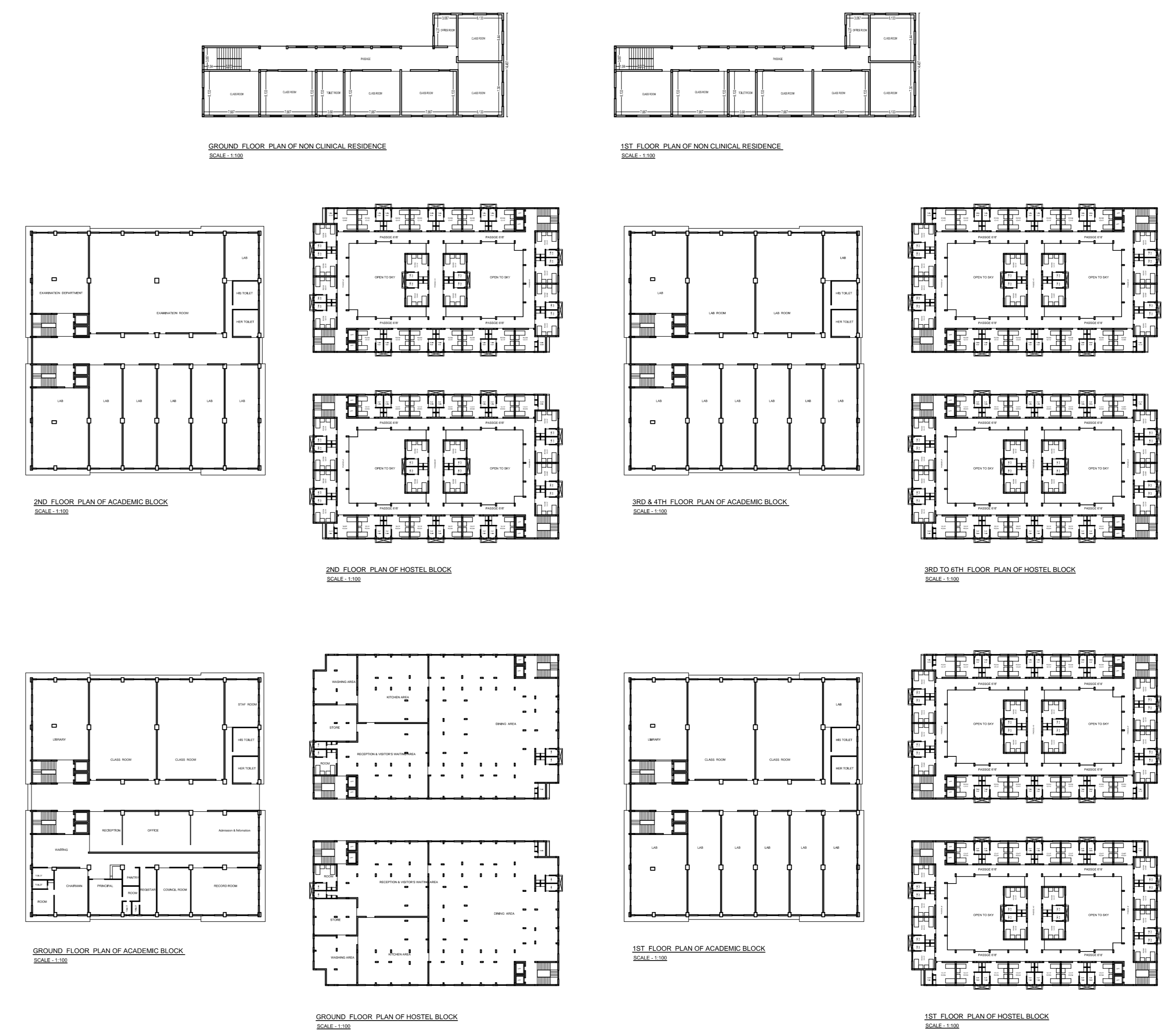

**NOTE**  
 1. FOUNDATION R.C.C. AS PER STRUCTURAL DESIGN SPECIFICATION  
 2. ALL EXISTING STRUCTURE TO BE DEMOLISHED  
 3. ALL DIMENSIONS IN M  
 4. DRAWING NOT TO BE MEASURED

OWNER / POAH

Signature of Applicant:-

**GENERAL SPECIFICATION:-**  
 FOUNDATION : PLAN CONCRETE AS PER DESIGN  
 R.C.C. COLUMN FOOTING & COLUMN AS PER STRUCTURAL DESIGN  
 SUPER STRUCTURE : R.C.C. COLUMN & BEAM AS PER STR. DESIGN  
 EXTERIOR EXT. WALL : 150MM THK. PARTITION WALL IN CEMENT MORTAR  
 FLOOR : R.C.C. ROOF SLAB AS PER STRUCTURAL DESIGN  
 INTERNAL FINISH : CEMENT PLASTER WITH P.F.P. & G.O.D.  
 SANITARY : VITROUS CHINA CLAY SANITARY WARE G.I. PIPE WATER SUPPLY  
 DOORS & WINDOW : AS PER SCHEDULE  
 ELECTRICAL : COPPER WIRE WITH P.V.C. CONDUIT.

PROPOSED INSTITUTIONAL BUILDING PLAN OF  
 NETAJI SUBHAS MEDICAL COLLEGE AND HOSPITAL  
 A UNIT OF MS SITWANTO DEVI MAHILA KALYAN SANSTHAN  
 AT PLOT NO.- IC- 4  
 MOUZA - HATIYADH AND BHATIA, NEAR PHASE -7,  
 ADITYAPUR INDUSTRIAL AREA,  
 DIST.- SERAIKELA - KHARSAWAN (JHARKHAND)

SHEET No. 05 / 08  
 L.K. SUMAN  
 Dra. - 1 Scale/10m  
 Seal: [Blank]  
 Ser. Jumber

Reg. No.- JIADA/ENG/0014/2021