

Project Title :SRI BANWARI JHA

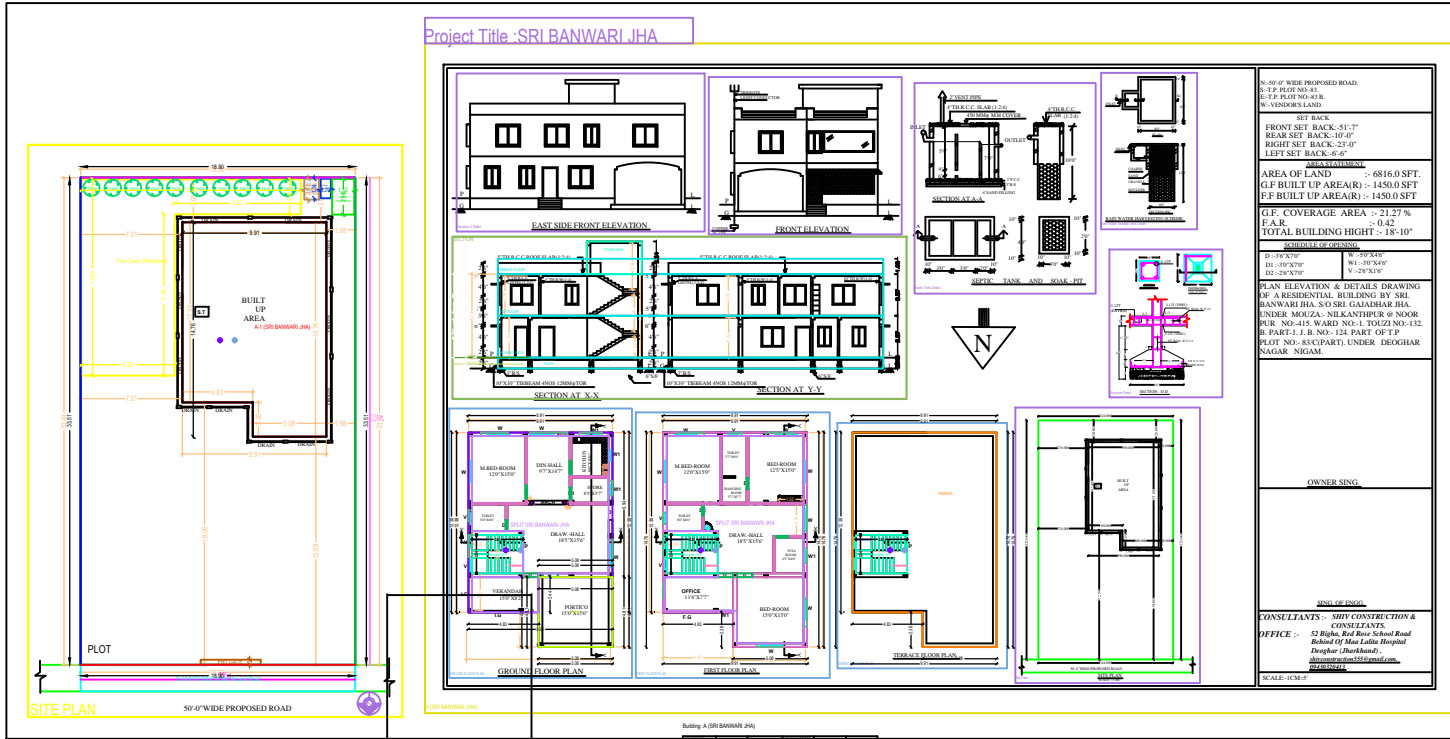

S: 50'-0" WIDE PROPOSED ROAD.
 S.F.P. PLOT NO-83
 B.F.P. PLOT NO-83 B.
 W: VANDAR'S LAND.

SET BACK
 FRONT SET BACK -51.7'
 REAR SET BACK -10.0'
 RIGHT SET BACK -23.0'
 LEFT SET BACK -0.0'

AREA OF LAND ~ 6816.0 SFT.
 G.F. BUILT UP AREA(R) ~ 1450.0 SFT
 F.F. BUILT UP AREA(R) ~ 1450.0 SFT

G.F. COVERAGE AREA ~ 21.27 %
 F.A.R. ~ 0.42
 TOTAL BUILDING HEIGHT ~ 18'-10"

SCHEDULE OF JOINEEY

D: 34'X10'	B: 34'X10'
D1: 28'X10'	B1: 30'X10'
D2: 28'X10'	B2: 28'X10'

PLAN ELEVATION & DETAILS DRAWING
 OF A RESIDENTIAL BUILDING BY SRI.
 BANWARI JHA, S/O SRI. GAJADHAR JHA,
 UNDER MUZZA, NILKANTHPOUR @ NOOR
 PUR, NO-415 WARD NO-1, TOLZI NO-132,
 B. PART-I, J. B. NO- 124 PART OF F.F.
 PLOT NO- 83(CORNER), UNDER: DUGHAR
 NAGAR NIGAM.

OWNER SING

CONSULTANTS :- SHY CONSTRUCTION &
 CONSULTANTS
 OFFICE :- 32 Right, 8th Block School Road
 Behind of Man Lalia Hospital
 Dughar (Jharkhand),
 Jharkhand, India
 8130020214

SCALE: 1/8"=1'-0"

NO.	DESCRIPTION	AMOUNT	DATE
1
2
3
4
5
6
7
8
9
10
11
12
13
14
15
16
17
18
19
20
21
22
23
24
25
26
27
28
29
30
31
32
33
34
35
36
37
38
39
40
41
42
43
44
45
46
47
48
49
50
51
52
53
54
55
56
57
58
59
60
61
62
63
64
65
66
67
68
69
70
71
72
73
74
75
76
77
78
79
80
81
82
83
84
85
86
87
88
89
90
91
92
93
94
95
96
97
98
99
100

Building A (SRI BANWARI JHA)

NO.	DESCRIPTION	AMOUNT	DATE
1
2
3
4
5
6
7
8
9
10
11
12
13
14
15
16
17
18
19
20
21
22
23
24
25
26
27
28
29
30
31
32
33
34
35
36
37
38
39
40
41
42
43
44
45
46
47
48
49
50
51
52
53
54
55
56
57
58
59
60
61
62
63
64
65
66
67
68
69
70
71
72
73
74
75
76
77
78
79
80
81
82
83
84
85
86
87
88
89
90
91
92
93
94
95
96
97
98
99
100