

Project Title :SMT SONI KUMARI

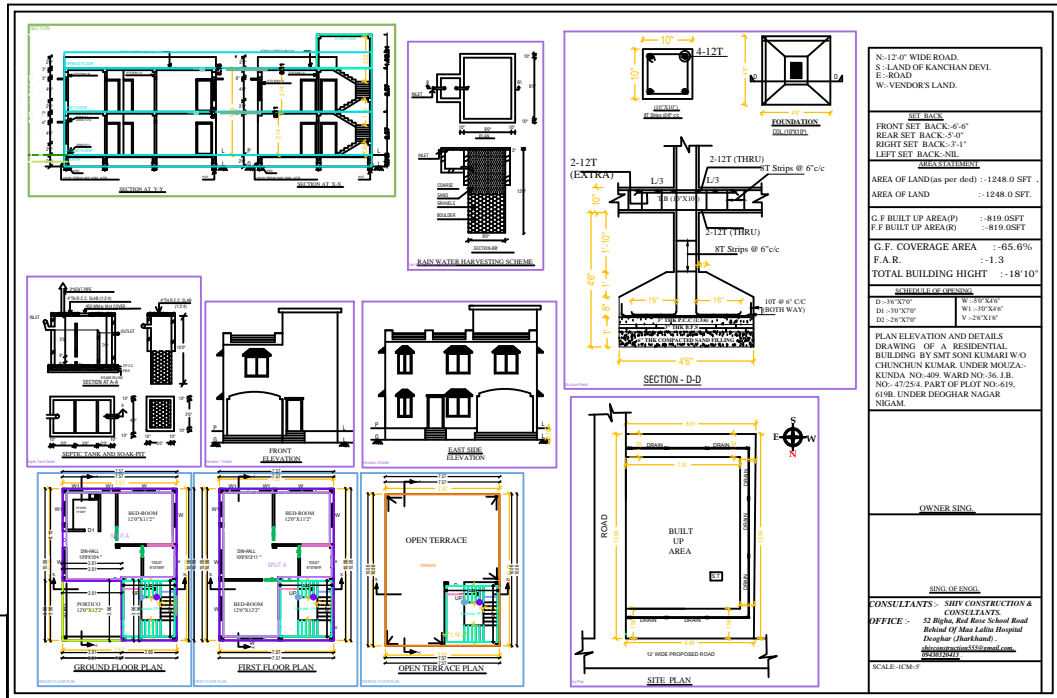

N-12'-0" WIDE ROAD.
S-LAND OF KANCHAN DEVI.
E-ROAD
W-VENDORS LAND.

SET BACKS
FRONT SET BACK-4'-0"
REAR SET BACK-5'-0"
RIGHT SET BACK-5'-1"
LEFT SET BACK-NIL

AREA STATEMENT
AREA OF LAND(as per ded) :- 1248.0 SFT
AREA OF LAND :- 1248.0 SFT

G.F BUILT UP AREA(P) :- 819.0SFT
F.F BUILT UP AREA(R) :- 819.0SFT
G.F. COVERAGE AREA :- 65.6%
F.A.R. :- 1.3
TOTAL BUILDING HEIGHT :- 18'10"

PLAN ELEVATION AND DETAILS
DRAWING OF A RESIDENTIAL
BUILDING BY SMT SONI KUMARI W/O
CHENCHUN KUMAR UNDER MOZA-
KUNDA NO.-409, WARD NO.-36, J.B.
NO.- 47254, PART OF PLOT NO-619,
C/SUB. UNDER DEOGHAR NAGAR
NIGAM.

OWNER: SING

CONSULTANTS - SHY CONSTRUCTION & CONSULTANTS
OFFICE - 52 Right, Red Stone School Road
Behind Of Man Laha Hospital
Deoghar (Jharkhand)
826002010

SCALE-1:50

NO.	DESCRIPTION	QUANTITY	UNIT	AMOUNT
1
2
3
4
5
6
7
8
9
10
11
12
13
14
15
16
17
18
19
20
21
22
23
24
25
26
27
28
29
30
31
32
33
34
35
36
37
38
39
40
41
42
43
44
45
46
47
48
49
50
51
52
53
54
55
56
57
58
59
60
61
62
63
64
65
66
67
68
69
70
71
72
73
74
75
76
77
78
79
80
81
82
83
84
85
86
87
88
89
90
91
92
93
94
95
96
97
98
99
100

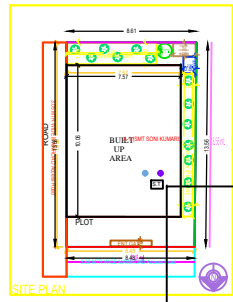

Building A (SMT SONI KUMARI)

Sl. No.	Particulars	Quantity	Rate	Amount
1
2
3
4
5
6
7
8
9
10
11
12
13
14
15
16
17
18
19
20
21
22
23
24
25
26
27
28
29
30
31
32
33
34
35
36
37
38
39
40
41
42
43
44
45
46
47
48
49
50
51
52
53
54
55
56
57
58
59
60
61
62
63
64
65
66
67
68
69
70
71
72
73
74
75
76
77
78
79
80
81
82
83
84
85
86
87
88
89
90
91
92
93
94
95
96
97
98
99
100