

PLAN OF LAND UNDER MAUZA-NILKANTHOUR @ NOORPUR
NO-415, P.S., DIST- DEOGHAR, J.M.C WARD NO- 22
PART OF T.P. PLOT NO 25A PART OF SUB PLOT NO-36
UNDER J.B NO - 132 (PART) AREA 1414 SQFT LAND
SHOWN IN RED COLOUR POSSESSED BY SMT SWEETY
KUMARI WD SRI NIRAJ KUMAR JHA

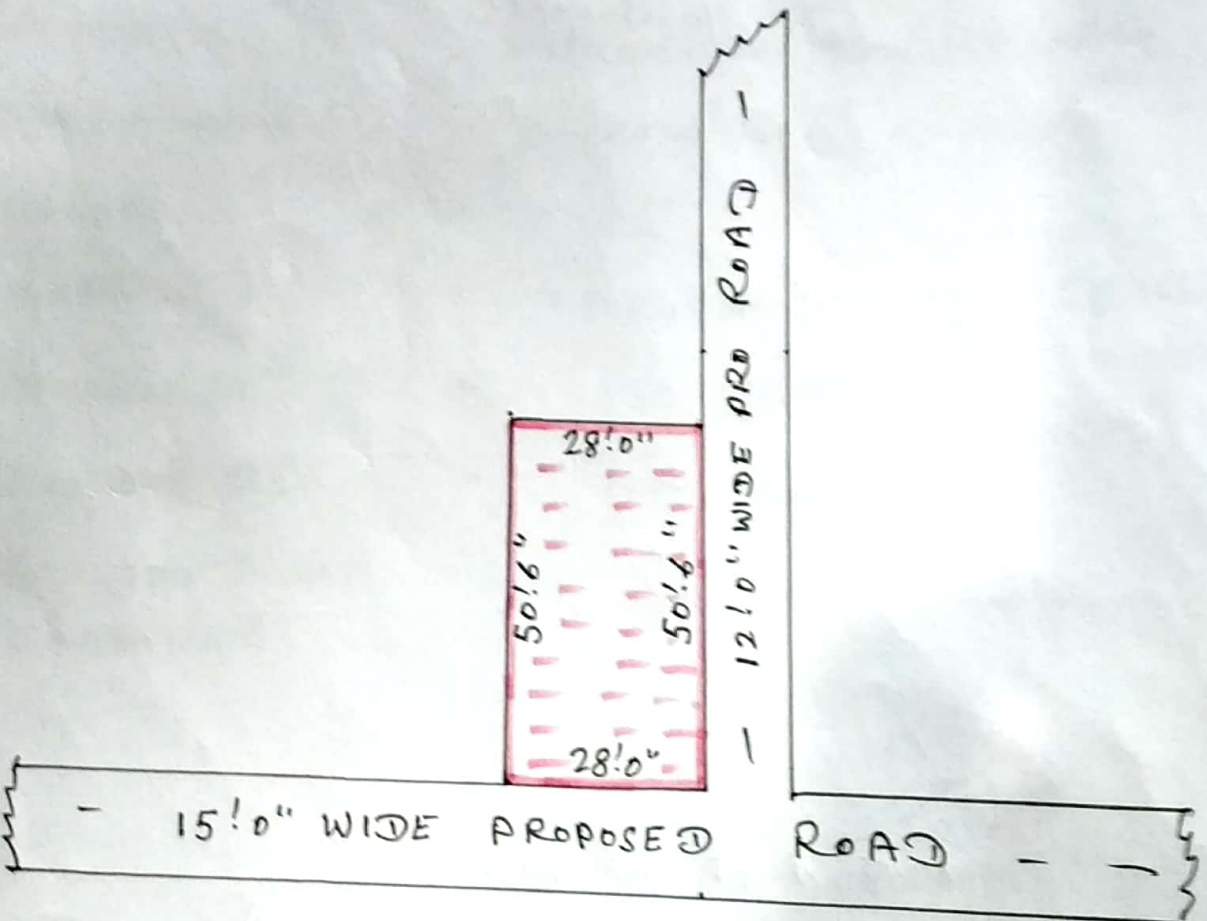

Sher
Amin
11.9.2019