

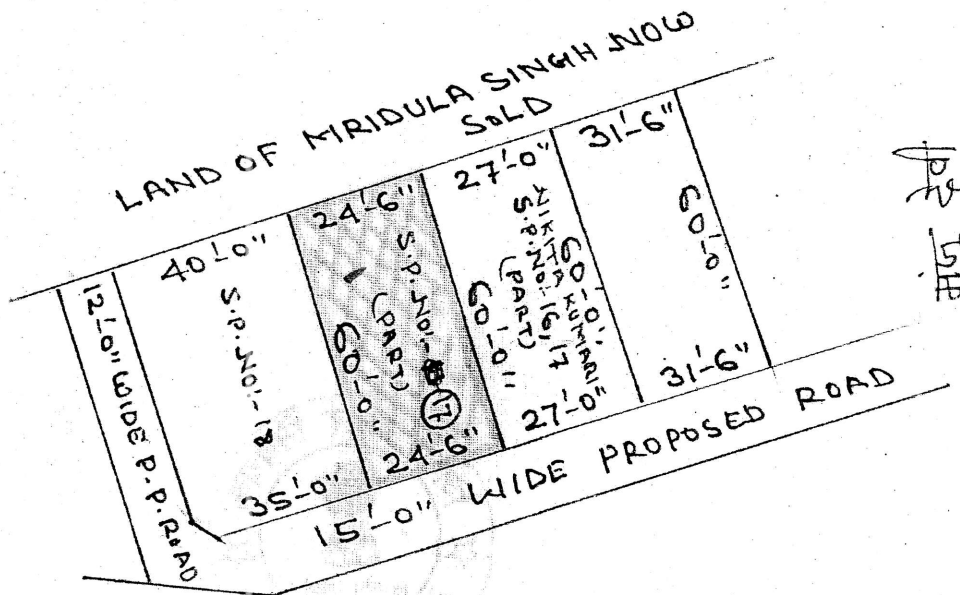

PLAN OF LAND UNDER MOUZA!-NILKANTHPUR  
@ NOORPUR NO!-415, WITHIN DEOHAR NAGAR  
NIGAM WARD NO!-22, J.B.NO!-184/1, PART  
OF T.P. PLOT NO!-188, SUB PLOT NO!-17  
PART, AREA!- 1470 SQFT, SHOWN IN RED  
COLOUR, BELONG'S TO SMT MANJU DEVI  
W/O TULANAND SINGH NOW SOLD TO SMT  
REKHA KUMARI W/O SRI ABHIMANYU MANDI  
R/O - BHORABAZAR, CHANDAN, DIST! -  
BANKA.



Format of Site Elevation and Site Coordinates Certificate

Dated: 3/19/2020

Name and Address of Agency issuing Site Elevation and Site Coordinates:

UJJAWAL KUMAR

DGMC/ENG/0005/2016

Reference No. 19/2020

The Site Elevation (in meters) and Site Coordinates (in WGS) of the site/plot

No. PLOT # Elevation - 254, 256, 255.5, 257M  
HIGHEST - 257M

Corresponding to the Site

Address: REKHA KUMARI

Owned by REKHA KUMARI

are as under:-

(A)

Corner No.	Latitude (DD MM SS.s)	Longitude (DD MM SS.s)	Site Elevation (AMSL) in meters
1.	N - 24' 30' 7.5	E - 86' 42' 30.8	
2.	N - 24' 30' 6.8	E - 86' 42' 31.0	
3.	N - 24' 30' 6.9	E - 86' 42' 30.7	
4.	N - 24' 30' 6.5	E - 86' 42' 30.5	

(B) Highest Site Elevation of the Plot: 257M

1. I/we am /are trained and equipped to issue this certificate for site elevation and site coordinates.
2. It is certified that the site elevation and site coordinates data are correct to best of my knowledge and belief and are within permissible limits of accuracy of 50 cm in vertical and 03 meters in lateral

Rekha Devi

  
Name: Ujjawal Kumar  
B. Tech (Civil Engineering)  
Reg. No.-DGMC/ENG/0005/2016  
DEOGHAR NAGAR NIGAM  
INDU BHUSHAN SARKAR ROAD  
WILLIAMS TOWN, DEOGHAR  
JHARKHAND-814112