

PLAN OF LAND UNDER MOUZA :- Hirma No. 269  
 with in Beghar Municipal Ward No :-  
 AT J.B NO :- 21/2883 PART OF PLOT NO :-  
 705 and 541 sub Plot NO :- II/A AREA :-  
 516.66 sqft. shown in Red. Colour  
 belongs to Sri Parmeshwar Yadav  
 S/O Sri Sarju Yadav of Baraundia  
 P.S :- Simultala, Dist :- Jamui  
 and Now sold to smt usha Beni  
 w/o Sri Dathibal Ranjan of Gopi-  
 dih, P.S :- Chandramandih.. Dist.  
 Jamui.

True copy

R.O. 9.11.95

Boundary of science collage Satsang

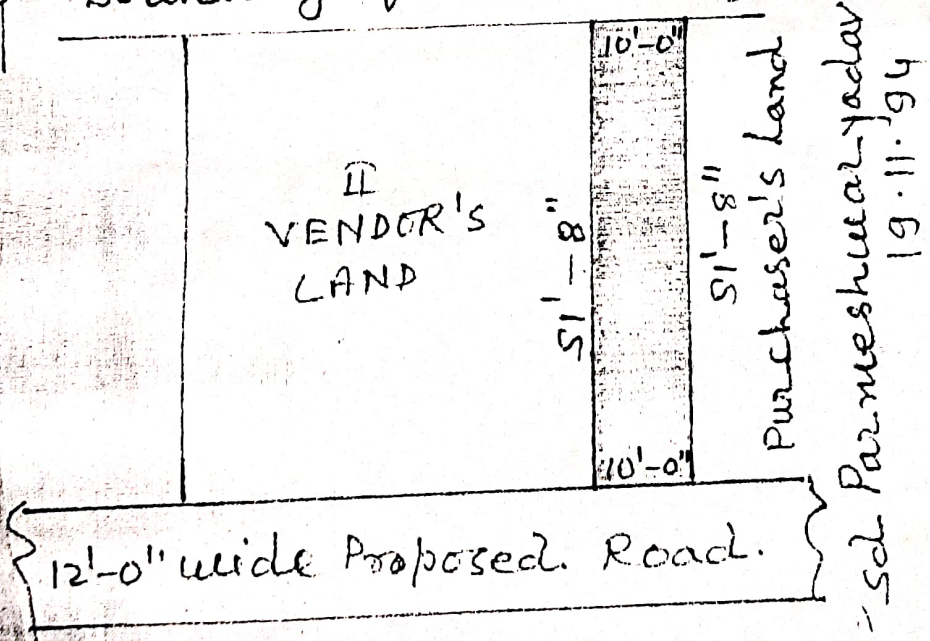

34T 297

[Red Stamp]  
 17/11/95  
 [Illegible text in stamp]

PLANT LAND UNDER MURDER JOURNAL  
 IN DEOGHAR MUNICIPAL WARD NO. 3517 PART OF PLOT NO 705 & 541 SUB  
 PART NO. II (PART) AREA: 597 SQ FT SHOWN IN  
 RECOLOUR BELONGS TO SRI PARMESHVAR  
 BADAU OF BAROUNDHIA P.S. SIMULTALA DIST  
 JAMSHEDPUR & NOW SOLD TO SMT USHA DEVI  
 SRI DADHIVAL RANJAN OF GOPIDHAR  
 P.S. CHANDRAMANDI DIST JAMSHEDPUR  
 SCALE: - 1" = 20' - 0"

SCIENCE COLLEGE  
 SATSANG

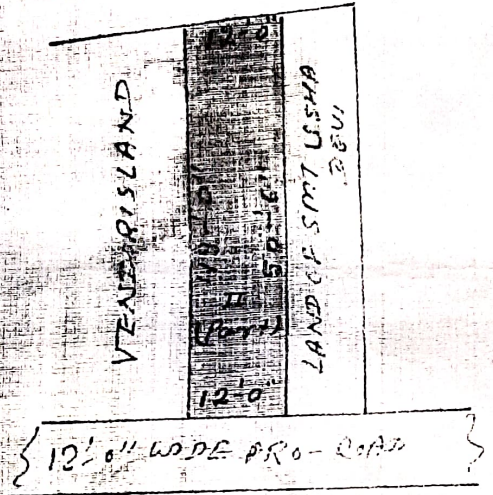

श्रीमती-यशोवती देवी, P. S. Parmeshwar Badau  
 19.4.96

20-4-96  
 वास्तु विभागा निबंधक  
 देवधर

Sd/-  
 P. B. ...  
 18.4.96

Traced by  
 Jagdeo Das

341 27

87/11/27  
 DEPARTMENT OF  
 J. HARKHANI  
 1996

plan of land under mortgage: Hisara no  
 269 within Deoghar Municipal Ward  
 No 11 Z.B. No (35/7) 21/2883" Kha"  
 Part of Settlement Plot no 705 &  
 541 Sub Plot No 2 (Part) Area 510  
 sqft Shown in Red Colour Belong's  
 to Sri Parameshwar Yadav of Baro-  
 Umhria P.S Simultala Dist. Jammu  
 & Now sold to Smt Usha Devi  
 W/o Sri Dadhibal Rangan of Gopi-  
 dih P.S. Chandramendih Dist  
 Jammu

BOUNDARY WALL OF SATSANG SCIENCE COLLEGE

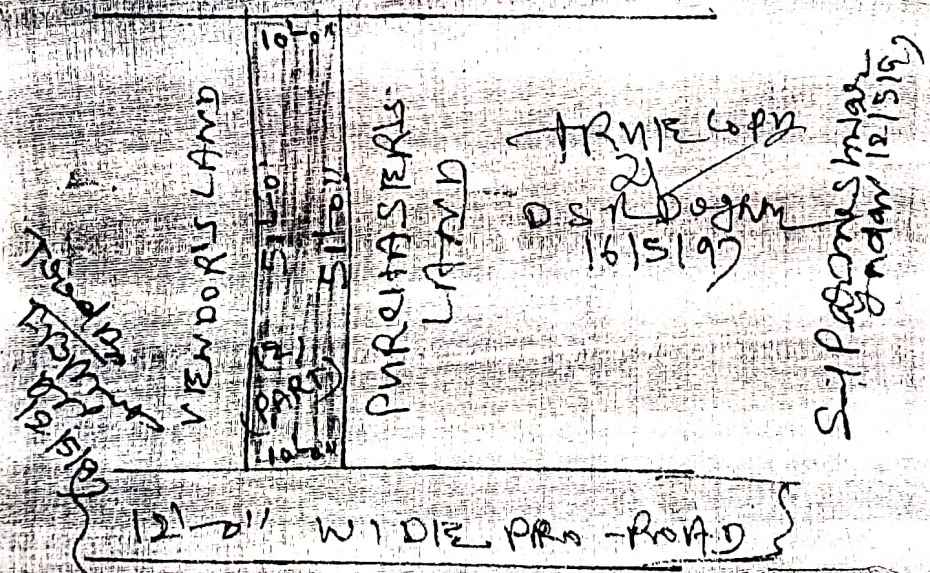

27/11/21  
 DEPARTMENT OF...  
 DISTRICT...  
 JAMMU & KASHMIR