

PLAN OF LAND UNDER MOUZA:- SHYAMGANJ NO- 413 WITHIN DEOGHAR NAGAR NIGAM WARD NO-32 J. B. NO-54/321/PART OF T. P. PLOT NO- 775 SUB PLOT NO- 4 PART, 5 & 6PART AREA:- 2500sqft. SHOWN IN RED COLOUR BELONGS TO Smt. PREETI SINGHA RAY , Smt. ARTI RAY CHOUDHARY & Smt. BHASWATI KONAR & NOW SOLD TO Smt. NIVEDITA KUMARI W/O MANISH KUMAR LALL OF ASHARAM KESHAN ROAD, CASTAIRS TOWN, NEAR BAIDYANATH DHAM STATION, DEOGHAR.

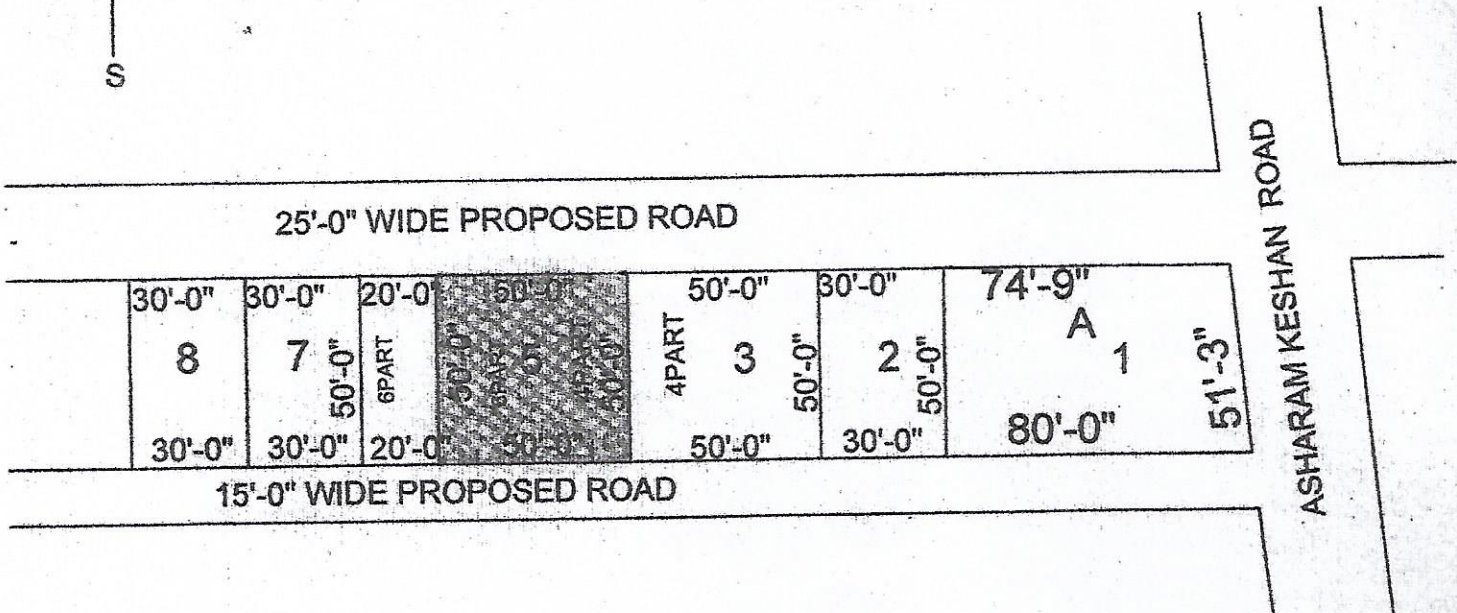

Bharmala Ray

Bhaswati Konar

प्राप्त: अशराम केशन

Trace by M. K. S. 20/10/2019

8/25/12

GOV. OF BIHAR