

Project Title :SMT KALPANA KUMARI

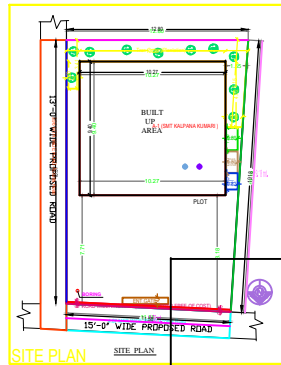

N  
S  
W  
E

N-15'-0" WIDE PROPOSED ROAD  
S- VENDOR'S LAND SUB PLOT NO.-2  
E- 15'-0" WIDE PROPOSED ROAD  
W- VENDOR'S LAND & PLOT NO.-501

**SET BACK**  
FRONT SET BACK-25'-4"  
REAR SET BACK-5'-0"  
RIGHT SET BACK-30"  
LEFT SET BACK-3'-0"

**SCHEDULE OF DOOR & WINDOW**

DOOR	WIDTH	HEIGHT	NO. OF UNITS	SIZE
D	3'6"	7'0"	400	6'6"X7'0"
D1	3'0"	7'0"	400	3'0"X7'0"

WINDOW	WIDTH	HEIGHT	NO. OF UNITS	SIZE
W	5'0"	4'6"	2'6"	5'0"X4'6"
V	2'6"	1'6"	5'6"	2'6"X1'6"

**AREA STATEMENT**  
AREA OF LAND (as per deed) :- 2480.0 SFT.  
AREA OF LAND :- 2477.0 SFT.

G.F BUILT UP AREA (R) :- 1039.0SFT  
F.F BUILT UP AREA (R) :- 1155.0SFT  
S.F BUILT UP AREA (R) :- 1155.0 SFT

G.F. COVERAGE AREA :- 41.94%  
F.A.R :- 1.35  
TOTAL BUILDING HEIGHT :- 30'0"

PLAN ELEVATION AND DETAILS DRAWING OF A RESIDENTIAL BUILDING BY SMT. KALPANA KUMARI W/O SRI RAM KUMAR UNDER MOZZA- RAMPUR NO-581, WARD NO.- J.B.NO- 55/4 & 55/5, PART OF PLOT NO.-623, SUB PLOT NO.-1, UNDER DEOGHAR NAGAR NIGAM.

**OWNER SING.**

**SEAL OF ENGINEER**

**CONSULTANTS:- SHIV CONSTRUCTION & CONSOLE LEAVES**  
OFFICE :- 52 Right, Red Cross School Road Behind Of Man Lalia Hospital Dargah (Jharkhand),  
shivconstruction555@gmail.com  
09431024111

SCALE: 1:100

Sl. No.	Particulars	Area (Sft)	Remarks
1	Plot Area	2480.0	As per deed
2	Area of Land	2477.0	
3	Ground Floor Built Up Area (R)	1039.0	
4	First Floor Built Up Area (R)	1155.0	
5	Second Floor Built Up Area (R)	1155.0	
6	Third Floor Built Up Area (R)	1155.0	
7	Fourth Floor Built Up Area (R)	1155.0	
8	Open Terrace Area	1155.0	
9	Total Built Up Area (R)	5664.0	
10	Area of Land	2477.0	
11	Ground Floor Coverage Area	41.94%	
12	F.A.R	1.35	
13	Total Building Height	30'0"	

Building A (SMT KALPANA KUMARI)

Sl. No.	Particulars	Area (Sft)	Remarks
1	Plot Area	2480.0	As per deed
2	Area of Land	2477.0	
3	Ground Floor Built Up Area (R)	1039.0	
4	First Floor Built Up Area (R)	1155.0	
5	Second Floor Built Up Area (R)	1155.0	
6	Third Floor Built Up Area (R)	1155.0	
7	Fourth Floor Built Up Area (R)	1155.0	
8	Open Terrace Area	1155.0	
9	Total Built Up Area (R)	5664.0	
10	Area of Land	2477.0	
11	Ground Floor Coverage Area	41.94%	
12	F.A.R	1.35	
13	Total Building Height	30'0"	

**SCHEDULE OF FLOOR:**

FLOOR	NO. OF UNITS	AREA (SFT)	REMARKS
GROUND FLOOR	10	1039.0	
FIRST FLOOR	10	1155.0	
SECOND FLOOR	10	1155.0	
THIRD FLOOR	10	1155.0	
FOURTH FLOOR	10	1155.0	

**DETAILS OF ROOF:**

Sl. No.	Particulars	Area (Sft)	Remarks
1	Roof Area	1155.0	
2	Roof Area	1155.0	
3	Roof Area	1155.0	
4	Roof Area	1155.0	
5	Roof Area	1155.0	

**DETAILS OF TERRACE:**

Sl. No.	Particulars	Area (Sft)	Remarks
1	Terrace Area	1155.0	
2	Terrace Area	1155.0	
3	Terrace Area	1155.0	
4	Terrace Area	1155.0	
5	Terrace Area	1155.0	