

part. under. word No 8 Dagher Mum
 Kaling belonging, part of plot No 24/19
 belonging to ~~Sri~~ Sah. Arab. Equabal of
 Dagher and to be sold to Sri Ram
 Narain. Mandal of. Nath Nagar. Bhojpur
 pr. Shweta. In. Road.

Scale 20' = 1" Inch

True Copy
D. S. P. Dagher
 29-4-92

30' 0" wide proposed Road No 76

Plot No 24/20
 Boundary Wall of. Rajigar

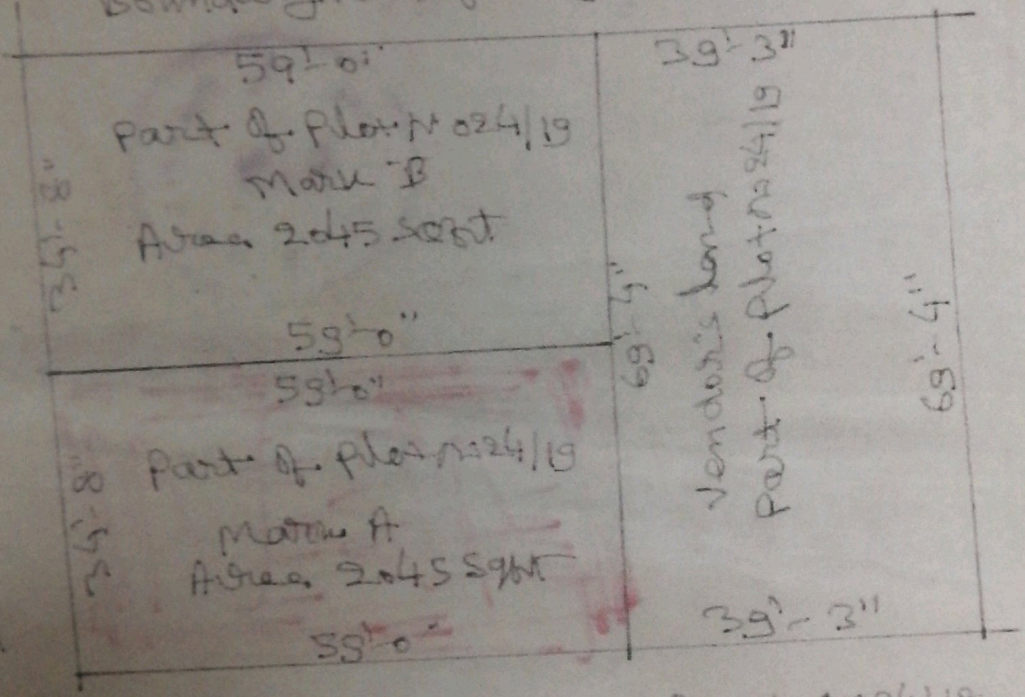

30' 0" wide proposed Road No 24/18

Sd/-
 Proposed By
 29/4/92
 Signature of Vendor
 30/12/91
 Sd/-
 Sri Shah Arab Equabal

Malti Ram